

ENGINE 113.942 in MODEL 163.172

ENGINE 113.981 in MODEL 163.174

ENGINE 113.965 in MODEL 163.175

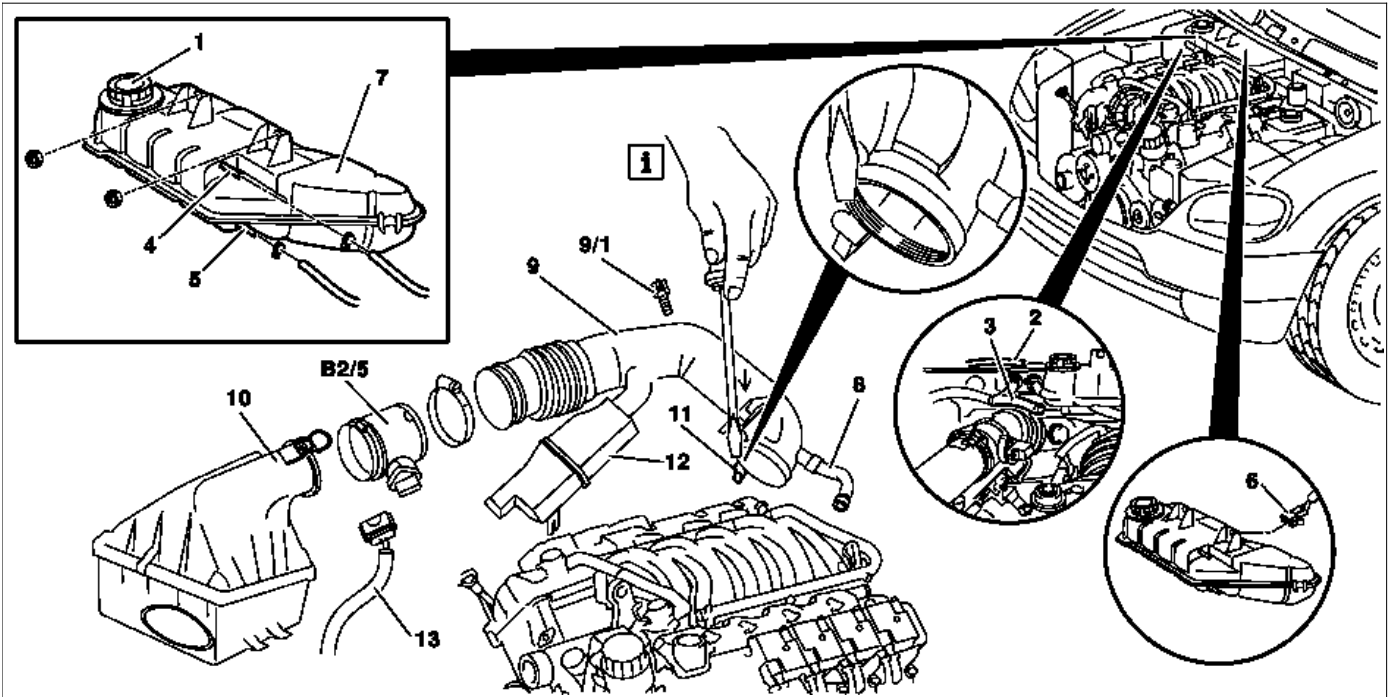

P07.61-2143-09

- | | | | |
|---|---|------|--|
| 1 | Expansion reservoir cap | 9 | Air intake pipe |
| 2 | Overflow pipe | 9/1 | Bolt |
| 3 | Coolant line | 10 | Air cleaner housing |
| 4 | Coolant line (expansion tank → heat duct) | 11 | Lock of air intake pipe |
| 5 | Coolant line (expansion tank → radiator) | 12 | Resonance housing |
| 6 | Connector | 13 | Connector of hot film mass air flow sensor |
| 7 | Expansion reservoir | B2/5 | Hot film mass air flow sensor |
| 8 | Crankcase ventilation vacuum hose | | |

☒ ☒	Remove/Install		
1	<p>Risk of injury to skin and eyes suffering scalding from contact with hot coolant spray. Risk of poisoning from swallowing coolant.</p> <p>Open expansion reservoir cap (1) and drain overpressure</p>	<p>Do not open cooling system unless coolant temperature is below 90 °C. Open cap slowly and release the pressure. Do not pour coolant into beverage bottles.</p> <p>Wear protective gloves, protective clothing and eye protection.</p> <p>i 1-stage cap: Rotate cap half a revolution counterclockwise, release pressure relief, then unscrew cap.</p>	AS20.00-Z-0001-01A
2	Remove overflow pipe (2) from expansion tank (7)		
3	Detach coolant line (3), coolant line (expansion reservoir → heat duct) (4) and coolant line (expansion reservoir → radiator) (5) at expansion reservoir (7)	<p>i Collect coolant</p> <p> Clamp</p> <p> 6 mm socket hexagon</p> <p> 7 mm socket hexagon</p>	<p>*000589403700</p> <p>*WH58.30-Z-1001-06A</p> <p>*WH58.30-Z-1002-06A</p>
4	Remove expansion tank (7)		
5	Disconnect plug connector (6)		
6	Remove expansion tank (7)		
7	Detach vacuum hose crankcase ventilation (8)		
8	Unscrew air intake pipe (9) from cylinder head cover	i Unscrew bolt (9/1).	
9	Remove hot film mass air flow sensor (B2/5) from air filter housing (10)		

10	Push air intake pipe locking mechanism (11) downwards using screwdriver	<p>i During this step unhinge air intake pipe at top</p> <p>i Do not damage lock of air intake pipe (11).</p>	
11	Remove resonance housing (12)		
12	Remove air intake pipe (9) and hot film mass air flow sensor (B2/5)	i For this step unplug plug of hot film mass air flow sensor (13).	
13	Install in the reverse order		
14	Pour in coolant		AR20.00-P-1142HA
15	Inspect cooling system for leaks		AR20.00-P-1010HA

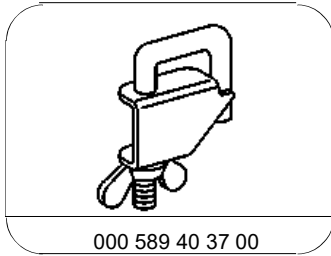

Clamp

Commercially available tools

Number	Designation
WH58.30-Z-1001-06A	6 mm socket hexagon on flexible shaft for hose clamps with worm drive
WH58.30-Z-1002-06A	7 mm socket hexagon on flexible shaft for hose clamps with worm drive