

MODEL 164

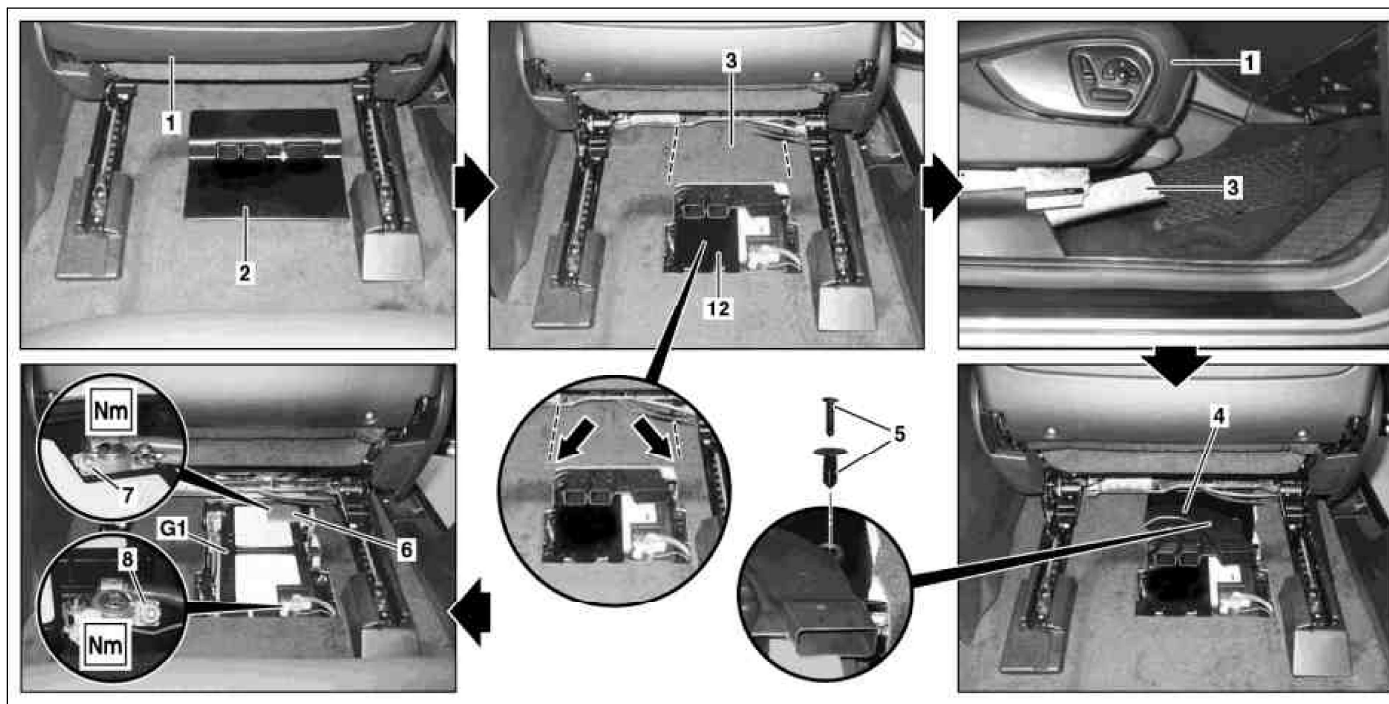

P54.10-2514-09

Shown on model 164.1

- | | |
|-----------------------------------|--|
| 1 Passenger seat | 7 Nut on positive battery terminal clamping device |
| 2 Cover | 8 Nut on negative battery terminal clamping device |
| 3 Floor Covering | 12 Battery cover |
| 4 Air vent | |
| 5 Expansion clip | |
| 6 Positive battery terminal cover | G1 Battery |

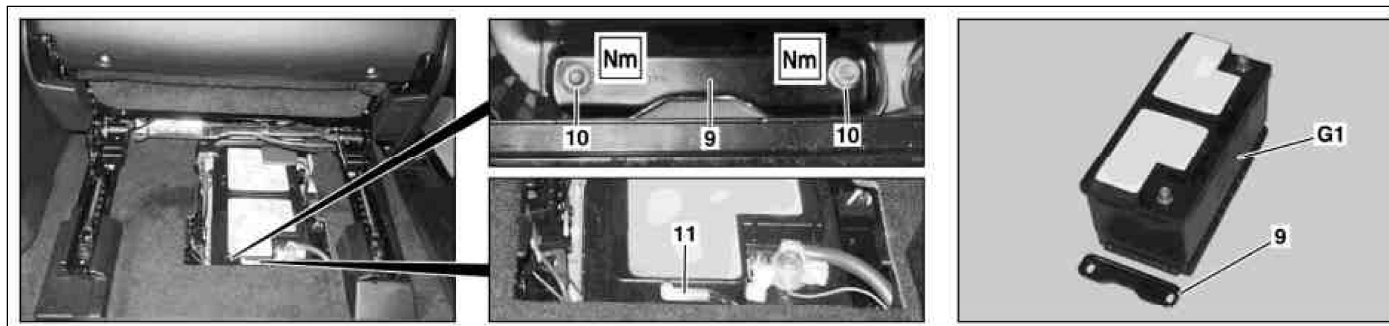

P54.10-2515-07

- | | | |
|-------------------|-----------------|------------|
| 9 Retaining plate | 11 Venting hose | G1 Battery |
| 10 Nuts | | |

☒ ☒	Remove/install		
⚠ Danger!	Risk of explosion caused by oxyhydrogen gas. Risk of poisoning and caustic burns caused by swallowing battery acid. Risk of injury caused by burns to skin and eyes from battery acid or when handling damaged lead-acid batteries	No fire, sparks, open flames or smoking. Wear acid-resistant gloves, clothing and glasses. Only pour battery acid into suitable and appropriately marked containers.	AS54.10-Z-0001-01A
📌	Notes on battery	All models	AH54.10-P-0001-01A
i	Notes on AGM battery		AH54.10-P-0002-01A
1	Move head restraint on front passenger seat (1) all the way down	📌 If the head restraint is not moved all the way down, the sun visor may be damaged when inclining the seat backrest.	
2	Move front passenger seat (1) as far forward as possible and upwards, tilt seat backrest forward		
3	Remove cover (2)		
4	Separate floor covering (3) at both marked positions (arrows)	i The floor covering (3) has already been separated, if at an earlier stage work was performed on or in the battery compartment.	

5	Move front passenger seat (1) all the way to rear		
6	Fold floor covering (3) forwards, move front passenger seat (1) as far forward as possible, until the battery compartment is completely accessible	Make sure that the folded-over floor covering (3) does not tear at the fold.	
7	Switch off ignition and remove the transmitter key from the EIS [EZS] control unit	On vehicles with Keyless Go, code 889: Press Keyless Go start/stop button repeatedly until ignition is switched off. Remove transmitter key from vehicle and store it in a location beyond its transmission range (at least 2 m).	
8	Remove spreader clip (5) and detach air vent (4)	Installation: Replace spreader clip (5), if it is damaged.	
9	Remove battery cover (12)		
10	Undo nut on clamping device for battery negative pole (8), disconnect ground line of battery (G1)	All consumers must be switched off, as otherwise the vehicle electrical system may be damaged. It must be ensured that a jump-starting device is not connected to the vehicle. 	AR54.10-P-0003GZ *BA54.10-P-1012-01C
11	Remove positive battery terminal cover (6), undo nut on clamping device for positive battery terminal (7), remove positive lead		*BA54.10-P-1012-01C
12	Detach bleed hose (11) including plastic support from battery (G1)	Installation: Route vent hose (11) without kinks.	
13	Undo nuts (10), remove retaining panel (9)		*BA54.10-P-1024-01C
14	Remove battery (G1)	Installation: Before installation of the battery (G1) make sure that no cables are located within the area of the battery fixture, as they may be damaged when the battery (G1) is installed. Make sure that the maxi fuses on the prefuse box in the battery compartment are not unintentionally loosened when removing and installing the battery (G1).	
15	Install in the reverse order		
16	Perform basic programming		AR00.19-P-0200GZ

Battery

Number	Designation			Model 164
BA54.10-P-1012-01C	Nut, battery cable to battery terminal	M6	Nm	6
BA54.10-P-1024-01C	Nut, battery retaining plate to frame floor	M8	Nm	24