

Model 164

Modification notes

25.04.2014	"Install a new retaining ring (14)" added.	Operation step 17
------------	--	-------------------

Shown on right side of MODEL 164 with CODE 489 (AIRmatic (air suspension with level adjustment and adaptive damping system ADS))

- 1 Front axle shaft collar nut
- 2 Bracket
- 3 Bracket
- 4 Cable tie
- 5 Brake hose
- 6 Brake hose bracket

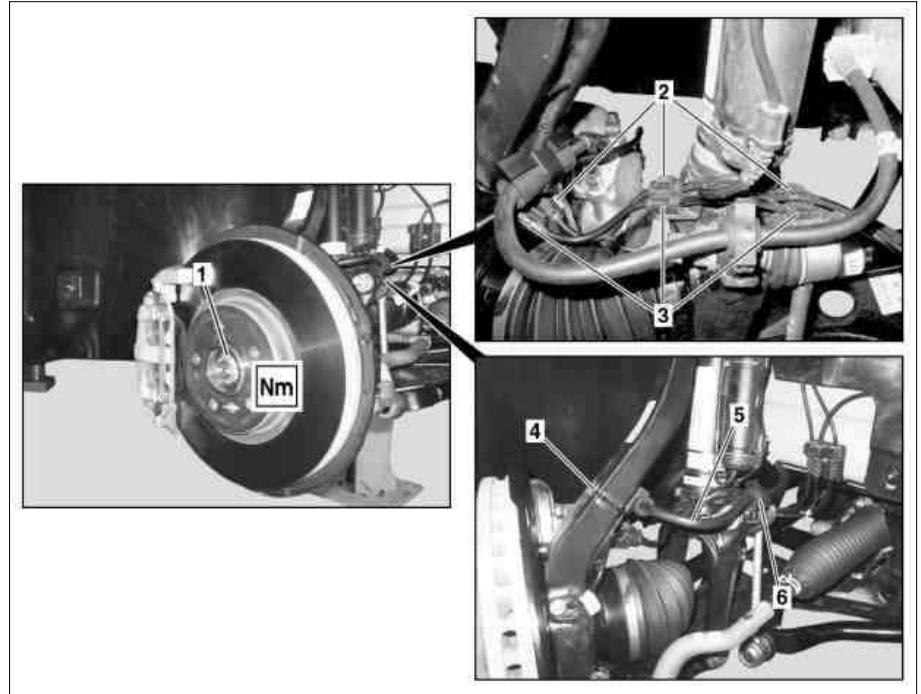

P33.30-2082-06

Shown on right side of MODEL 164 with CODE 489 (AIRmatic (air suspension with level adjustment and adaptive damping system ADS))

- 7 Extraction and insertion tool

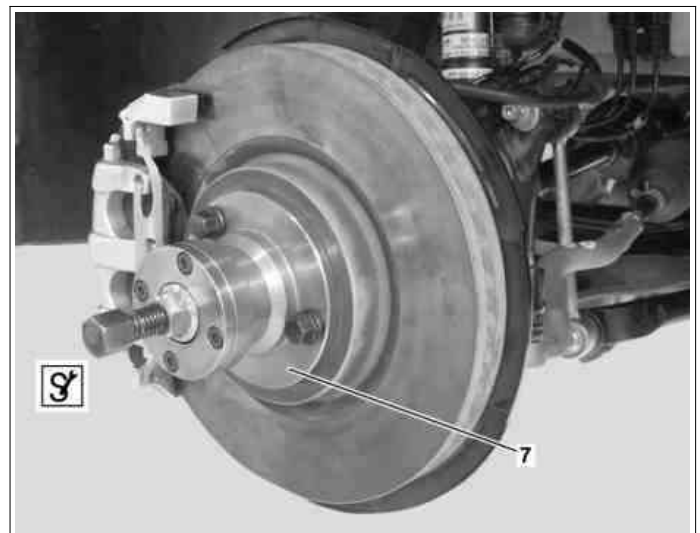

P33.30-2083-11

Shown on right side of MODEL 164 with CODE 489 (AIRmatic (air suspension with level adjustment and adaptive damping system ADS))

- 8 Nut
- 9 Nut
- 10 Steering knuckle

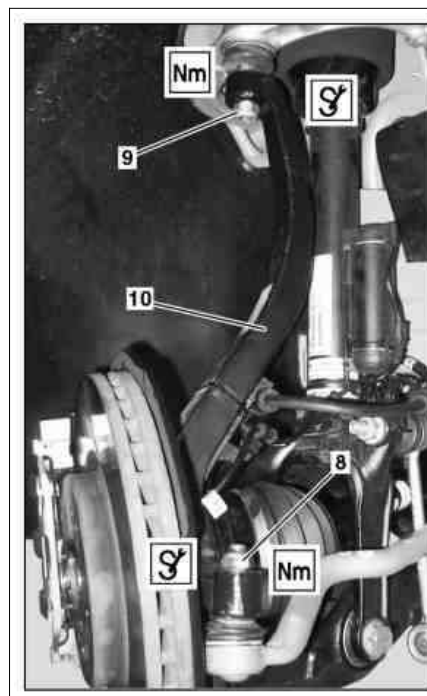

P33.30-2084-03

Shown on right side of MODEL 164 with CODE 489 (AIRmatic (air suspension with level adjustment and adaptive damping system ADS))

- 11 Screw
- 12 Transverse control arm
- 13 Front axle shaft

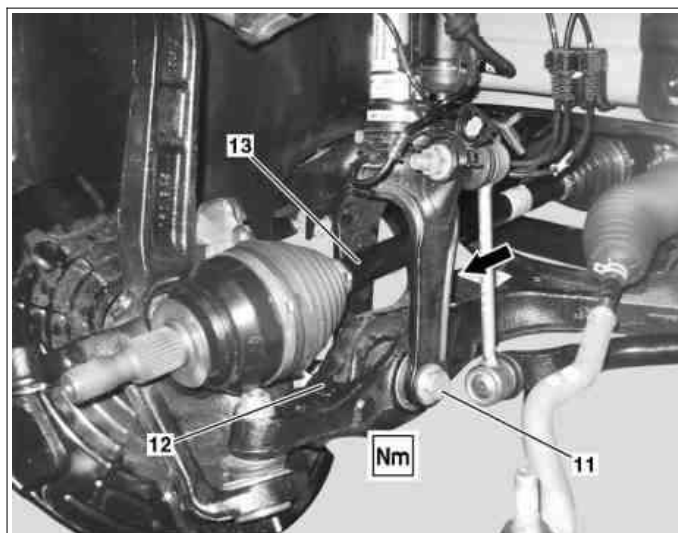

P33.30-2085-11

- 13 Front axle shaft
- 14 Retaining ring

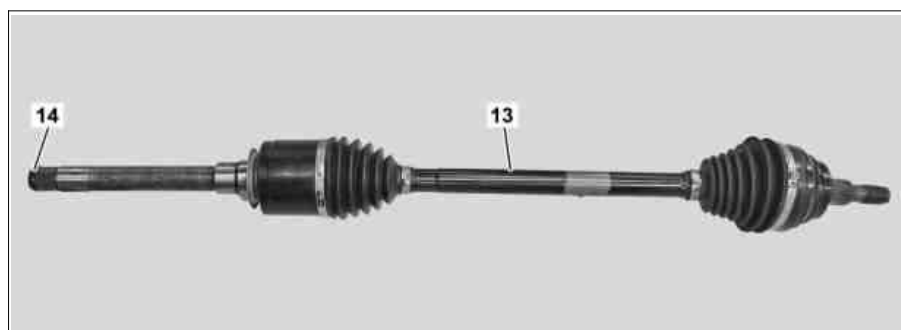

P33.30-2163-04

<p>⚠ Warning</p>	<p>Risk of injury. Moving parts can pinch, crush or, in extreme cases even sever extremities.</p>	<p>No parts of the body or limbs should be within the operating area of mechanical components when moving components.</p>	<p>AS00.00-Z-0009-01A</p>
<p>⚠ Danger</p>	<p>Risk of death caused by vehicle slipping or toppling off of the lifting platform.</p>	<p>Align vehicle between vehicle lift columns and position the four support plates at the vehicle lift support points specified by the vehicle manufacturer.</p>	<p>AS00.00-Z-0010-01A</p>

 Danger	Risk of death when touching components on vehicles with high-voltage on-board electrical system	Do not touch damaged or defective components and open lines of the high-voltage on-board electrical system. Persons who wear electronic implants (e.g. cardiac pacemakers) must not carry out any work on high-voltage on-board electrical systems.	AS54.00-Z-0001-01A
Topical note	Notes on self-locking nuts and bolts		AH00.00-N-0001-01A
	Notes on repair work on suspension components		AH00.00-P-0100-01A
	Remove/install		
1	Switch off ignition and remove transmitter key		
2	Raise vehicle	 Raise vehicle until wheels are free of ground.	AR00.60-P-1000GZ
3	Deflate AIRmatic system using STAR DIAGNOSIS	Model 164 with code 489 (AIRMATIC)	AD00.00-P-2000-04A
 AD	Remove front wheels		AP40.10-P-4050Z
 AP	Unscrew collar nut on front axle shaft (1)	 For counterholding purposes an assistant must apply the brake.  Collar nut, front axle shaft to front axle shaft flange	*BA33.30-P-1001-02D
6	Raise vehicle	 Raise vehicle to full height.	AR00.60-P-1000GZ
7.1	Detach lower engine compartment paneling	Model 164 with engine 113, 156, 272, 273	AR61.20-P-1105GZ
7.2	Remove soundproofing	Model 164 with engine 629, 642	AR94.30-P-5300GZ
7.3	Remove underride guard	Model 164 with code 430 (Offroad package)	AR88.30-P-0010GZ
8	Lower vehicle	 Lower half way.	AR00.60-P-1000GZ
9	Remove electrical lines from bracket (2) and bracket (3)	 Do not damage electrical leads.	
10	Cut off cable ties (4)	 Installation: Pay attention to installation position.  Installation: Use a new cable tie (4).  Pliers	*164589013700
11	Remove brake hose (5) from brake hose bracket (6)	 Do not damage the brake hose (5).	
12	Unscrew nut (8) and detach tie rod from steering knuckle (10)	 Self-locking nut, tie rod to steering knuckle  Thrust piece  Puller	*BA46.40-P-1002-01K *140589006300 *140589093300
13	Unscrew nut (9) and detach steering knuckle (10) from upper transverse control arm	 Self-locking nut, upper ball joint out of upper transverse control arm to steering knuckle  Puller  Thrust piece	*BA33.20-P-1001-01J *601589043300 *140589006300
14	Mount extraction and insertion tool (7) and undo front axle shaft (13) from front axle shaft flange	 Extraction and insertion tool	*210589034300
15	Swivel steering knuckle (10) out of working area		
16	Unscrew nut from front shock absorber, pull out bolt (11) and detach front shock absorber from transverse control arm (12)	 Self-locking nut, shock absorber to wishbone	*BA32.25-P-1002-01G
17	Pull front axle shaft (13) out of front axle gear (arrow) and remove	 Installation: Install a new retaining ring (14).  Collect any oil which runs out.	
18	Install in the reverse order		
19	Fill AIRmatic system using STAR DIAGNOSIS	 The wheels must not be in contact with the ground during the filling procedure. The air suspension bellows in the spring element will otherwise be destroyed if filling is performed in the compressed state.	
20	Check AIRmatic for leaks	Model 164 with code 489 (AIRMATIC)	AR32.22-P-8100GZ

Nm Front axle shock absorber

Number	Designation	Model 164.1/8
BA32.25-P-1002-01G	Self-locking nut, shock absorber to wishbone	Nm 265

Nm Wheel control, hub

Number	Designation	Model 164.1/8
BA33.20-P-1001-01J	Self-locking nut, upper ball joint out of upper transverse control arm to steering knuckle	Stage 1 Nm 20
		Stage 2 \angle° 90

Nm Front axle shaft

Number	Designation	Model 164.1	Model 164.8
BA33.30-P-1001-02D	Collar nut, front axle shaft to front axle shaft flange	Stage 1 Nm 250	260
		Stage 2 \angle° 45	45

Nm Tie rod

Number	Designation	Model 164.1/8
BA46.40-P-1002-01K	Self-locking nut, tie rod to steering knuckle	Stage 1 Nm 45
		Stage 2 \angle° 90

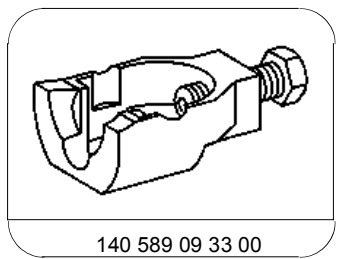

Puller

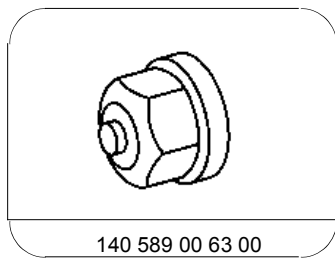

Thrust piece

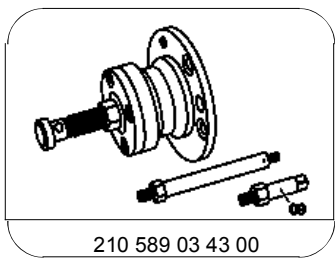

Extraction and insertion tool

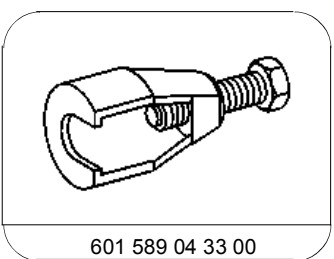

Puller

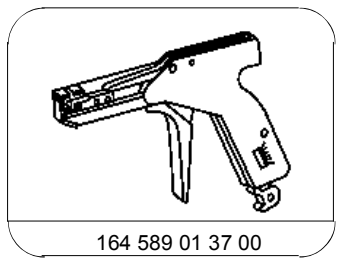

Pliers