

MODEL 164

Shown on model 164.1

- 1 Trim ring
 2 Dashboard lower section
 3 Electrical connectors
 A2 Radio
 N73 EIS [EZS] control unit

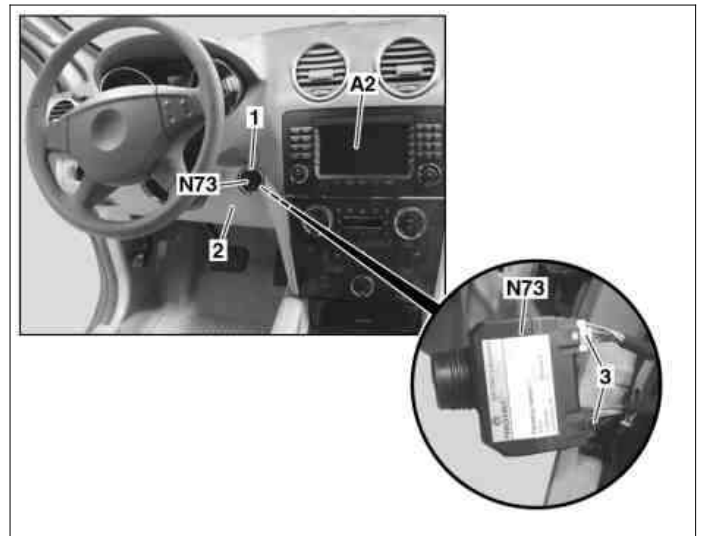

P80.57-2070-11

| | | | |
|-------|--|---|--------------------|
| | Information on preventing damage to electronic components due to electrostatic discharge | | AH54.00-P-0001-01A |
| | Remove/install | | |
| 1 | Transfer basic data for EIS control unit (N73) in STAR DIAGNOSIS Connect STAR DIAGNOSIS and read out fault memory | Only when replacing EIS control unit (N73). Installation: Transfer basic data from STAR DIAGNOSIS to EIS control unit (N73). On vehicles with power glass tilting/sliding roof, code 414 it is essential to perform the teach-in run for anti-pinch protection of sliding roof. | AD00.00-P-2000-04A |
| 2 | Remove radio (A2) | Do not disconnect electrically. | AR82.60-P-7502GZ |
| 3 | Remove trim ring (1) with claw wrench from ignition/starter switch | Claw-type wrench for rosette on ignition/starter switch | *210589000700 |
| 4 | Remove EIS control module (N73) from dashboard bottom section (2) toward rear | Access through radio installation shaft. Installation: Observe correct installation position. | |
| 5 | Separate electrical connectors (3) and remove EIS control unit (N73) | | |
| 6 | Install in the reverse order | | |

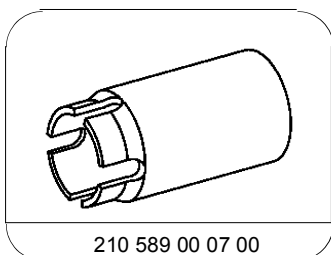

Claw-type wrench for rosette on ignition/starter switch