

MODEL 164

- 1 Steering knuckle
- 9 Front axle shaft flange
- 9n Wheel bearing (double-row angular ball bearing)
- 9p Retaining ring

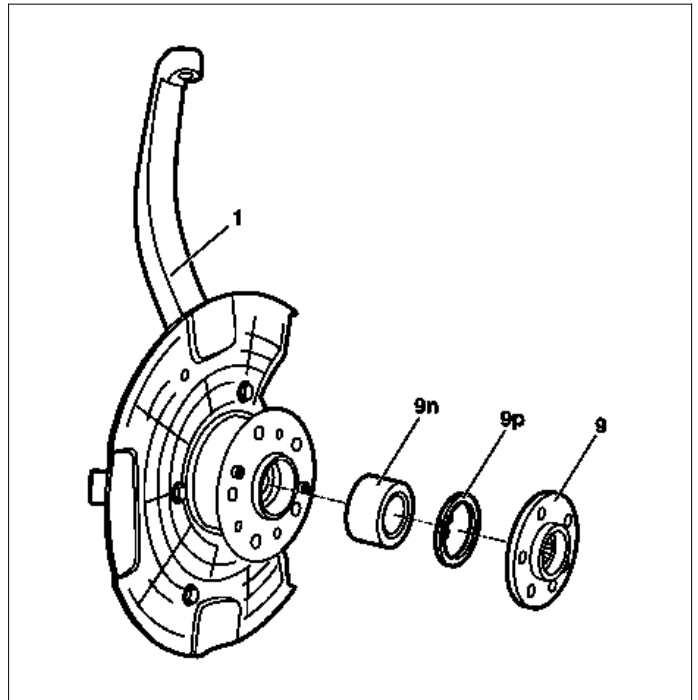

P33.20-2160-12

☒ ☒	Remove/install		
1	Remove steering knuckle (1)		AR33.25-P-0400GZ
2	Press out front axle shaft flange (9)	i Installation: Replace wheel bearing (9n). <input checked="" type="checkbox"/> <input checked="" type="checkbox"/> <input checked="" type="checkbox"/>	AR33.20-P-0315-01GZ *202589044300 *220589064300 *140589084300
3	Detach circlip (9p)	i Installation: Check circlip (9p) is correctly seated in steering knuckle (1).	
4	Press wheel bearing (9n) out of steering knuckle (1)	i Installation: Observe installation position. The dots, the line or the black inner race on the wheel bearing (9n) must face towards the steering knuckle (1). The marking depends on the manufacturer. The magnetic side of the wheel bearing (9n) must point in the direction of the steering knuckle (1). <input checked="" type="checkbox"/> <input checked="" type="checkbox"/> For wheel bearing dia. 98 mm <input checked="" type="checkbox"/> For wheel bearing dia. 90 mm	AR33.20-P-0315-03GZ *140589084300 *169589003500 *164589041500
5	Install in the reverse order		

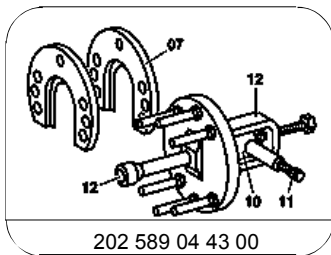

Extraction tool

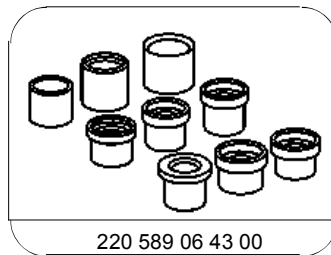

Press out/in tool

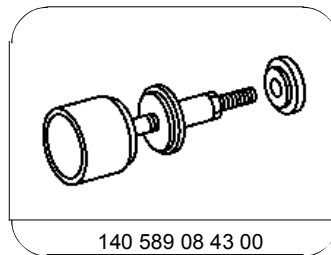

Extraction and insertion tool

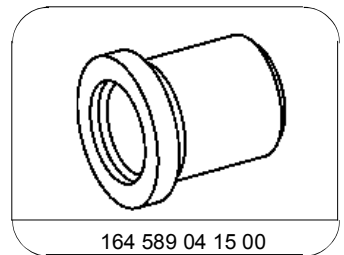

Drift

