

AR33.20-P-0315-03GZ	Pulling double-row angular ball bearing out and in		
---------------------	----------------------------------------------------	--	--

Modification notes

5.12.07	Repair method modified (Press out wheel bearing using workshop press)		
---------	-----------------------------------------------------------------------	--	--

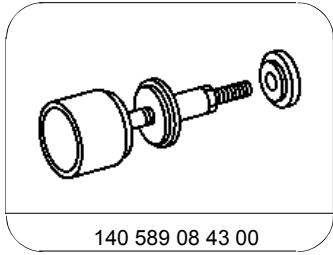

140 589 08 43 00

Extraction and insertion tool

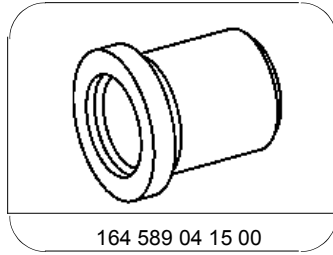

164 589 04 15 00

Drift

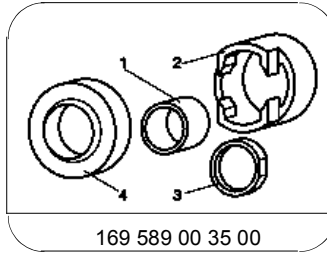

169 589 00 35 00

Press out/in tool

Press out wheel bearing

- 1 Position upright (5) and press out tool on workshop press.
 Use suitable horizontal base for support during pressing procedure.
- 2 Press wheel bearing out of steering knuckle (5) by operating the workshop press.
 Check the press-out tool is correctly seated on the wheel bearing.

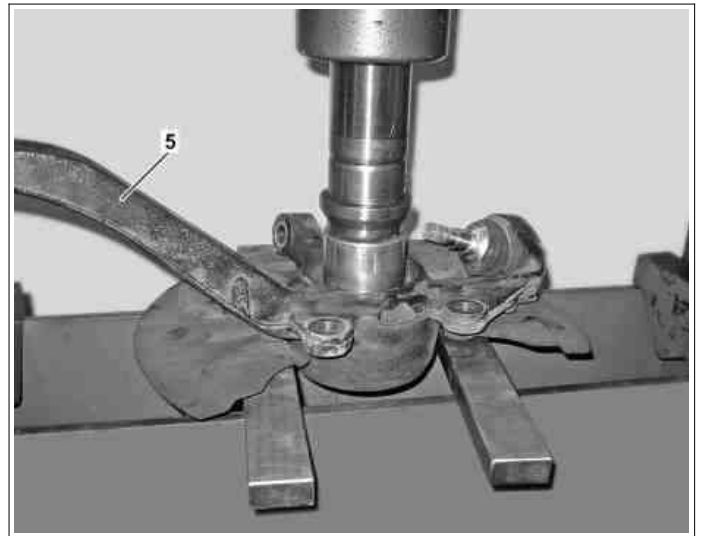

P33.20-2215-11

Press in wheel bearing

- 3 Position wheel bearing (9n), steering knuckle (5) and drift (01) onto workshop press.
 Observe correct installation position. The dots, the line or the black inner race (arrow) on the wheel bearing (9n) must face towards the steering knuckle (5). The marking depends on the manufacturer. The magnetic side of the wheel bearing (9n) must point in the direction of the steering knuckle (5).
 Use suitable horizontal base for support during pressing procedure.
 Model 164: Observe diameter of wheel bearing.
 With wheel bearing Ø 98 mm drift 169 589 00 35 00 part 1
 With wheel bearing Ø 90 mm drift 164 589 04 15 00
- 4 Press wheel bearing (9n) all the way into the steering knuckle (5) by operating the workshop press.
 The wheel bearing (9) is seated correctly when the pressure on the workshop press's display increases constantly.

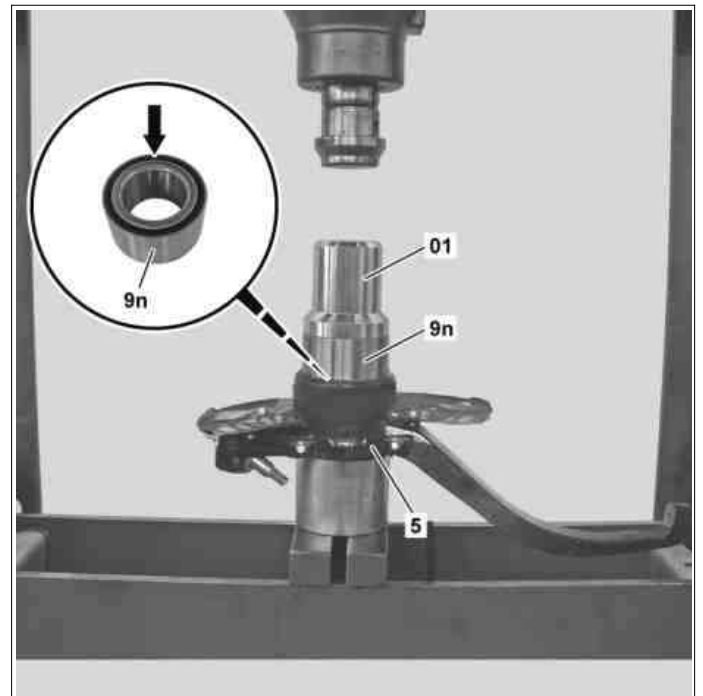

P33.20-2199-12