

# Printout

17 June 2019 12:10

MODEL 164

Shown on the right side of vehicle with AIRmatic (air suspension with level adjustment and Adaptive Damping System ADS), code 489

- 1 Front axle shaft collar nut
- 2 Bracket
- 3 Bracket
- 4 Cable tie
- 5 Brake hose
- 6 Brake hose bracket

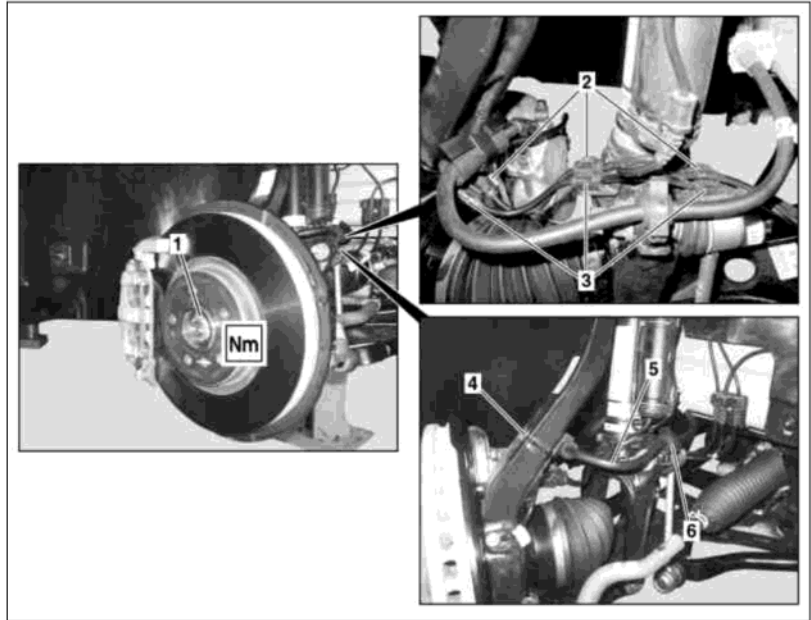

P33.30-2082-06

Shown on the right side of vehicle with AIRmatic (air suspension with level adjustment and Adaptive Damping System ADS), code 489

- 7 Extraction and insertion tool

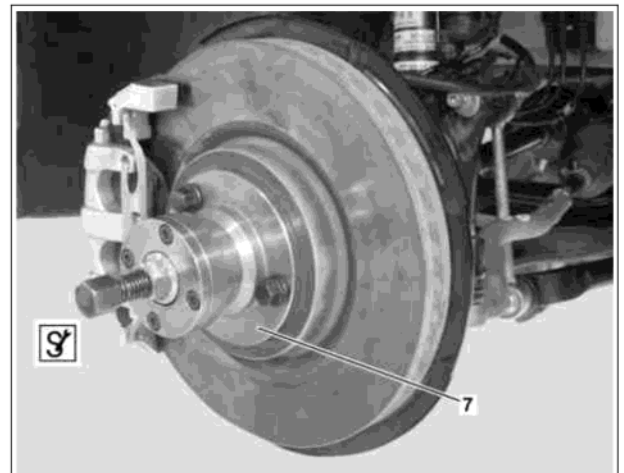

P33.30-2083-11

Shown on the right side of vehicle with AIRmatic (air suspension with level adjustment and Adaptive Damping System ADS), code 489

- 8 Nut
- 9 Nut
- 10 Steering knuckle

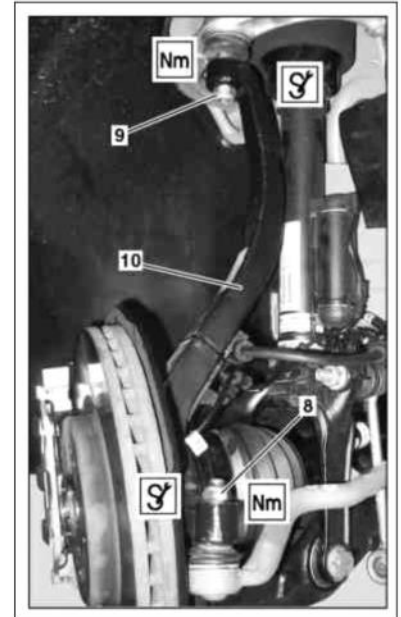

P33.30-2084-03

Shown on the right side of vehicle with AIRmatic (air suspension with level adjustment and Adaptive Damping System ADS), code 489

- 11 Screw
- 12 Transverse control arm
- 13 Front axle shaft

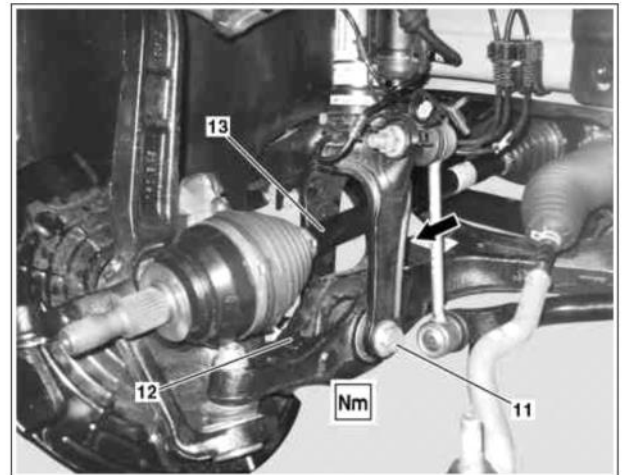

P33.30-2085-11

**Modification notes**

24.1.07	Collar nut, front axle shaft to front axle shaft flange	Model 164.1	*BA33.30-P-1001-02D
	Collar nut, front axle shaft to front axle shaft flange	Model 164.8	*BA33.30-P-1001-02D

	Remove/install		
<b>Danger!</b>	<b>Risk of injury</b> caused by moving parts that can <b>pinch, crush</b> or, in extreme cases, even <b>sever</b> extremities	No parts of the body or limbs should be within the operating range of the mechanism when moving components.	AS00.00-Z-0009-01A
<b>Danger!</b>	<b>Risk of death</b> caused by vehicle slipping or toppling off of the lifting platform.	Align vehicle between columns of vehicle lift and position four support plates at vehicle lift support points specified by vehicle manufacturer.	AS00.00-Z-0010-01A
<b>Danger!</b>	<b>Risk of death</b> when touching components on vehicles with high-voltage on-board electrical system	Do not touch components and open lines of the high-voltage on-board electrical system. Persons who are carriers of electronic implants (e.g. cardiac pacemakers), must <b>not</b> carry out any work on high-voltage on-board electrical systems.	AS54.00-Z-0001-01A
	Notes on self-locking nuts and bolts	All models	AH00.00-N-0001-01A
	When working on the front-end assembly, be careful not to scratch, mark or notch the surfaces of aluminum parts. Otherwise the service life of the parts will be affected		

1	Remove transmitter key or Keyless-Go start and stop button	On model 164.195  Switch off ignition. Remove transmitter key and Keyless-Go stop button from vehicle and keep at a location beyond transmitter range (at least 2 m).	
2	Raise vehicle using two-post lift	Raise vehicle until wheels are free of ground. Two-post lifting platform 3.0-3.5 t, electromechanical <a href="#">gotis://H_00.1_01.0</a>	AR00.60-P-1000GZ
3	Deflate AIRmatic system using STAR DIAGNOSIS  Connect STAR DIAGNOSIS and read out fault memory	Vehicle with AIRmatic (air suspension with level adjustment and adaptive damping system ADS), code 489.  STAR DIAGNOSIS diagnosis system	AD00.00-P-2000-04A
4	Remove front wheels Remove/install wheels, rotate if necessary		AP40.10-P-4050Z
5	Unscrew collar nut on front axle shaft (1)	For counterholding purposes an assistant must apply the brake. 	*BA33.30-P-1001-02D
6	Raise vehicle using two-post lift	Raise vehicle to full height. Two-post lifting platform 3.0-3.5 t, electromechanical <a href="#">gotis://H_00.1_01.0</a>	AR00.60-P-1000GZ
7.1	Detach lower engine compartment paneling	Vehicles with gasoline engine	AR61.20-P-1105GZ
7.2	Remove soundproofing	Vehicles with diesel engine	AR94.30-P-5300GZ
7.3	Remove underride guard	Vehicles with offroad package, code 430	AR88.30-P-0010GZ
8	Lower vehicle on two-post lift	Half the height. Two-post lifting platform 3.0-3.5 t, electromechanical <a href="#">gotis://H_00.1_01.0</a>	AR00.60-P-1000GZ
9	Remove electrical lines from bracket (2) and bracket (3)	Do not damage electrical lines.	
10	Cut off cable ties (4)	Installation: Installation position must be observed. Installation: Use new cable tie (4). Pliers	*164589013700
11	Remove brake hose (5) from brake hose bracket (6)	Do not damage brake hose.	
12	Undo nut (8) and remove tie rod from steering knuckle (10)	 Thrust piece Puller	*BA46.40-P-1002-01K *140589006300 *140589093300
13	Undo nut (9) and remove steering knuckle (10) from upper transverse control arm	 Puller Thrust piece	*BA33.20-P-1001-01J *601589043300 *140589006300
14	Mount extraction and insertion tool (7) and undo front axle shaft (13) from front axle shaft flange	Extraction and insertion tool	*210589034300
15	Swivel steering knuckle (10) out of working area		
16	Unscrew nut from front shock absorber, pull out bolt (11) and detach front shock absorber from transverse control arm (12)		*BA32.25-P-1002-01G
17	Withdraw front axle shaft (13) from front axle gear (arrow A) and remove	Collect any oil which runs out.	
18	Install in the reverse order		
19	Fill AIRmatic system using STAR DIAGNOSIS	The wheels must not make any contact with the ground when filling as when filling in the jounce condition the air spring bellows in the spring element will be destroyed. STAR DIAGNOSIS diagnosis system	
20	Check AIRmatic for leaks.		AR32.22-P-8100GZ

Front axle shock absorber

Number	Designation	Model 164.1/8

BA32.25-P-1002-01G	Self-locking nut, shock absorber to wishbone	Nm	265
--------------------	--	----	-----

**Nm Wheel control, hub**

Number	Designation	Model 164.1/8		
BA33.20-P-1001-01J	Self-locking nut, upper ball joint out of upper transverse control arm to steering knuckle	Stage 1	Nm	20
		Stage 2	Δ°	90

**Nm Front axle shaft**

Number	Designation			Model 164.1	Model 164.8
BA33.30-P-1001-02D	Collar nut, front axle shaft to front axle shaft flange	Stage 1	Nm	250	260
		Stage 2	Δ°	45	45

**Nm Tie rod**

Number	Designation	Model 164.1/8		
BA46.40-P-1002-01K	Self-locking nut, tie rod to steering knuckle	Stage 1	Nm	45
		Stage 2	Δ°	90

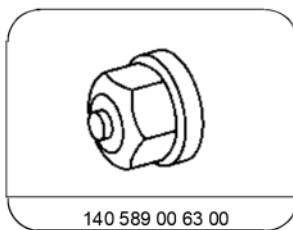

Thrust piece

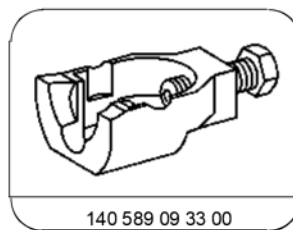

Puller

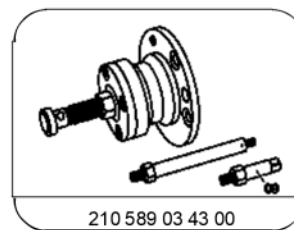

Extraction and insertion tool

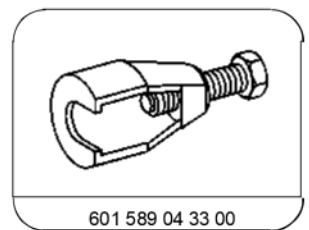

Puller



Pliers