

## MODEL 164

- 1 Front door lining
- 2 Sound deadening mat
- 3 Armrest
- 4 Clamping plates
- 5 Pins

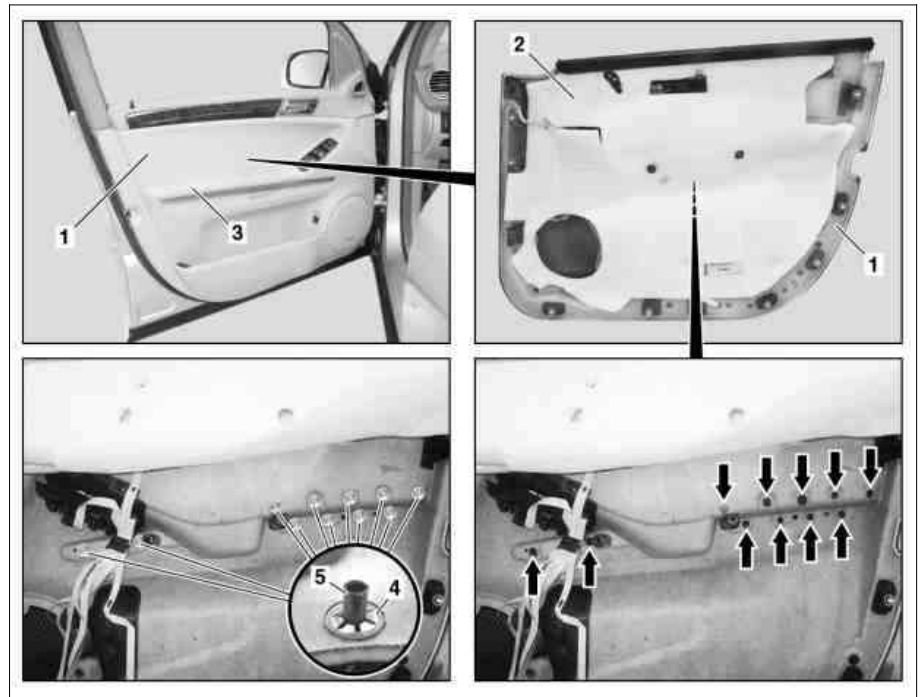

P72.10-3150-06

✕	Remove		
1	Remove front door lining (1)	⚠ Lay front door lining (1) down on suitable subsurface to prevent damage.	AR72.10-P-1000GZ
2	Remove sound deadening mat (2) from front door lining (1)	ℹ Remove sound deadening mat (2) from door lining and fold back until armrest (3) is accessible	
3.1	Drill plastic spot welds (arrows) out in armrest (3) with suitable bit and remove plastic residues from front door lining (1)	ℹ When initially removing armrest (3).  ⚠ Work carefully to prevent damage to flat ribbon cables ℹ Do not operate at excessive speed because the plastic becomes too hot, melts and galls the bit Rechargeable drill/screwdriver	*WH58.30-Z-1007-20A
3.2	Bend open clamping plates (4) with suitable screwdriver and remove from pins	ℹ When removing armrest (3) a second time	
4	Remove armrest (3)	ℹ Number of plastic spot welds and clips can vary according to model designation and equipment.	
✕	Install		
5	Install armrest (3)		
6	Press clamping plates (4) over pins (5) of armrest (3)	ℹ Use 10 mm socket wrench. The clamping plates (4) should make firm contact to the front door lining (1) ℹ Replace clamping plates (4)	
7	Fasten sound deadening mat (2) to front door lining (1)	ℹ Position gluing points and press on sound deadening mat (2)	
8	Install front door lining (1)	ℹ If required, cut off pins (5) on armrest (3) with suitable tool	AR72.10-P-1000GZ

## Commercially available tools

Number	Designation
WH58.30-Z-1007-20A	Cordless drill/driver