

Model 164, 166, 292

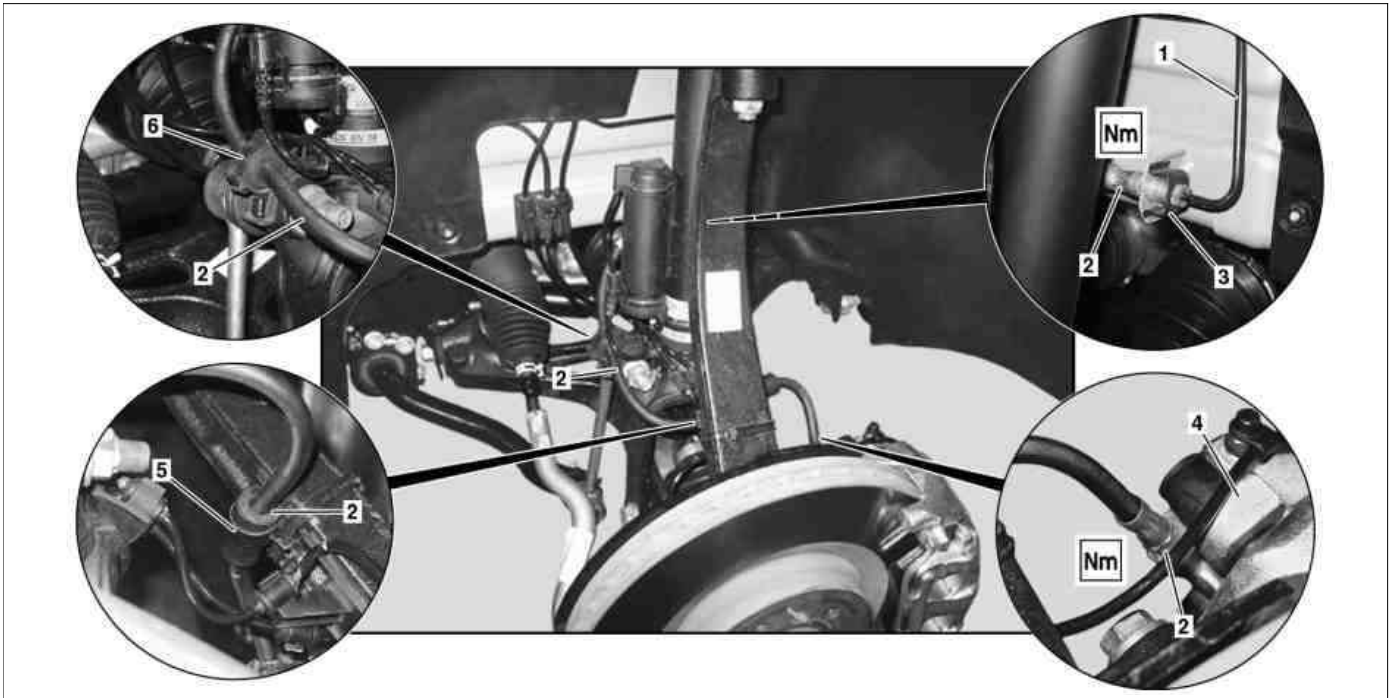

P42.10-2456-09

Shown on front axle of model 164

- |              |                 |
|--------------|-----------------|
| 1 Brake line | 4 Brake caliper |
| 2 Brake hose | 5 Bracket       |
| 3 Bracket    | 6 Bracket       |



P42.10-2457-09

Rear axle shown on model 164

- |              |                 |
|--------------|-----------------|
| 1 Brake line | 4 Brake caliper |
|--------------|-----------------|

- 2 Brake hose
- 3 Bracket

- 6 Bracket

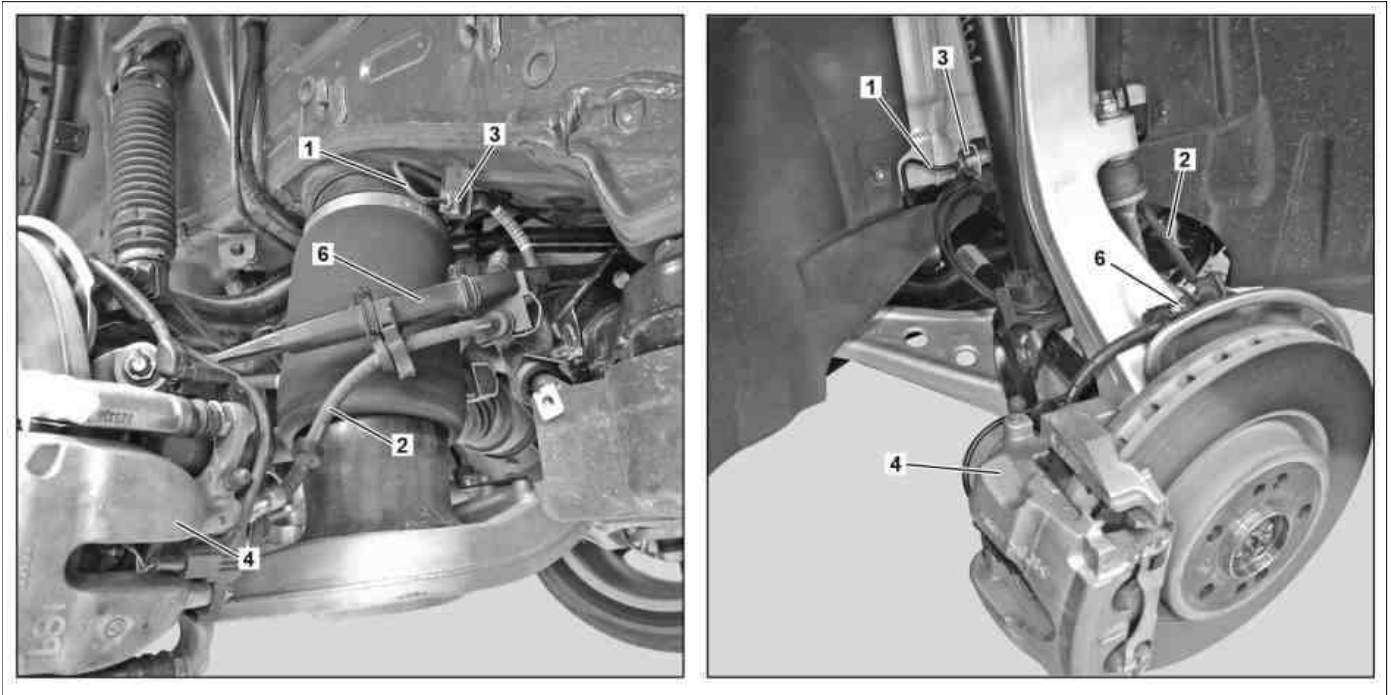

P42.10-2887-09

**Shown on model 166**

- 1 Brake line
- 2 Brake hose
- 3 Bracket

- 4 Brake caliper
- 6 Bracket

Warning	<b>Risk of injury.</b> Skin or eye injuries may result when handling hot or glowing objects.	Wear protective gloves, protective clothing and safety glasses, if necessary.	AS00.00-Z-0002-01A
Caution	<b>Risk of poisoning</b> from swallowing brake fluid. <b>Risk of injury</b> from skin and eye contact with brake fluid	Only pour brake fluid into suitable and appropriately marked containers. Wear protective clothing and eye protection when handling brake fluid.	AS42.50-Z-0001-01A
	Notes on installing brake hoses		AH42.10-P-9406-01A
	Notes on repairs to brake system		AH42.00-P-0003-01A
	Brake fluid notes		AH42.50-P-0001-01A
	<b>Remove/install</b>		
1 AP AP	Detach corresponding complete wheel	Model 164 Model 166 Model 292	AP40.10-P-4050Z AP40.10-P-4050EW AR40.10-P-1100GQC
	<b>Clean</b>		
2	Clean the area around the brake line (1) and brake hose (2) in the area of the separation points	Before opening the brake system, the area around the separating point must be cleaned thoroughly. Even the smallest dirt particles, introduced into the hydraulic components, can lead to malfunctions and a total failure of the brake system.	
3	Detach brake line (1) from brake hose (2)	<b>Installation:</b> Do not twist bracket (3). Brake line to brake hose Box wrench bit In model 166 the brake caliper (4) on the rear axle may not be drained. ↓ Otherwise it must be replaced.	*BA42.10-P-1002-04J *000589750300
4	Seal exposed connections	Seal connections immediately. Otherwise, escaping brake fluid may damage adjacent components.	

		Record plug	*129589009100
5	Detach brake hose (2) from bracket (6)	Model 166, 292	
6	Unscrew brake hose (2) from brake caliper (4)	Brake hose to brake caliper Box wrench	*BA42.10-P-1001-04J *000589760300
7	Seal exposed connections	Seal connections immediately. Otherwise, escaping brake fluid may damage adjacent components. Record plug	*129589009100
8	Detach brake hose (2) from bracket (5)	Model 164 on front axle. Pliers	*164589013700
9	Detach brake hose (2) from bracket (6)	Model 164	
10	Use water to rinse off any escaped brake fluid		
11	Install in the reverse order		
	<b>Bleed brake system</b>		
12	Bleed brake system	Model 164 Model 166, 292	AR42.10-P-0010GZ AR42.10-P-0010CW
	<b>Check</b>		
13	Check brake system for leaks		AR42.10-P-0100-01GZ
14	Carry out brake test on the test stand		AP42.00-P-4290BA

Brake lines, brake hoses

Number	Designation		Model 164.1/8	Model 166
BA42.10-P-1001-04J	Brake hose to brake caliper	Nm	22	24

Brake lines, brake hoses

Number	Designation		Model 292
BA42.10-P-1001-04J	Brake hose to brake caliper	Nm	24

Brake lines, brake hoses

Number	Designation		Model 164.1/8	Model 166
BA42.10-P-1002-04J	Brake line to brake hose	Nm	15	14

Brake lines, brake hoses

Number	Designation		Model 292
BA42.10-P-1002-04J	Brake line to brake hose	Nm	14

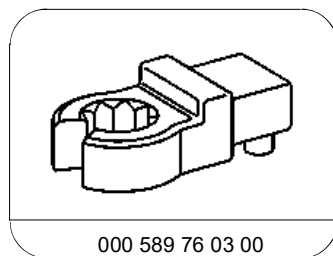

Box wrench

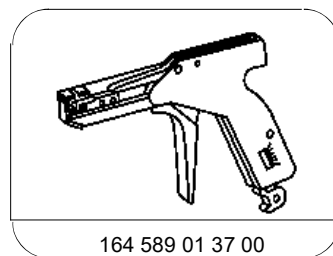

Pliers

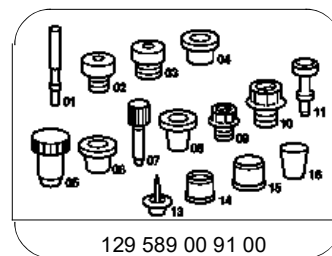

Record plug

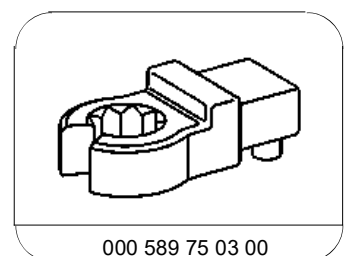

Box wrench bit