

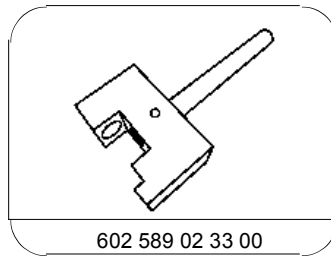

602 589 00 98 00

Case



602 589 02 33 00

Chain separating tool

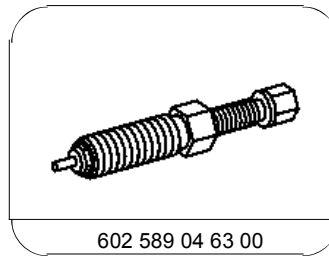

602 589 04 63 00

Pressure screw

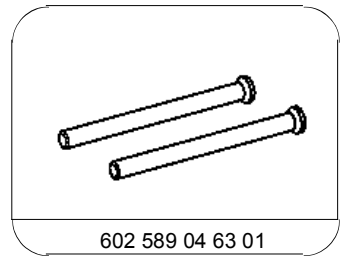

602 589 04 63 01

Pressure screw

- 1 Insert pressure pin (1) into pressure screw (2) and tighten union nuts (3) .
- 2 Screw pressure screw (2) into guide sleeve (4).
 The pressure pin (1) must not jut into the beveled incoming area of the guide sleeve (4).
- 3 Screw guide sleeve (4) into chain separating tool (5) .

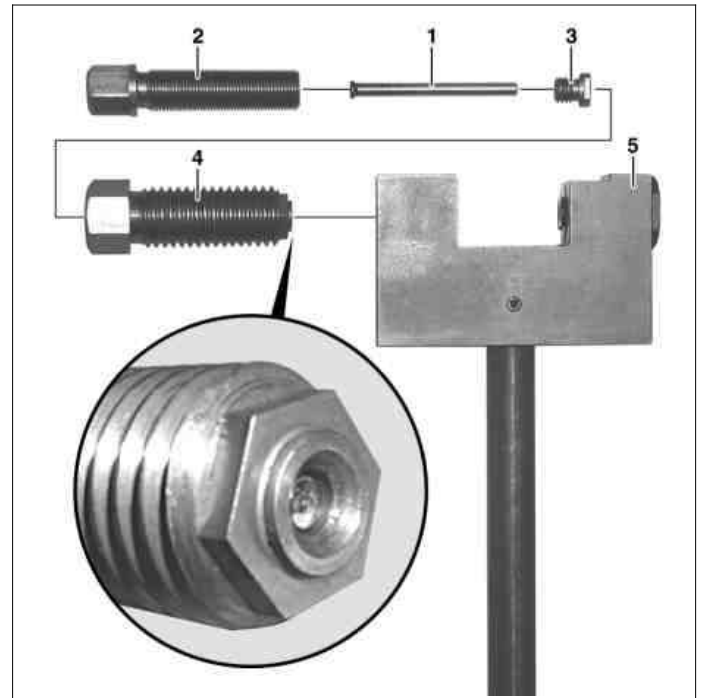

P05.10-2152-12

- 4 Cover timing case recess and cylinder head with shop towel.
- Parts, which have fallen into the timing case recess or cylinder head must be removed in order to prevent damage to the engine.

- 5 Fit chain separating tool (5) onto timing chain .
- 6 Screw guide sleeve (4) into chain separating tool (5) until the openings of the guide sleeve (4) and the guide (5a) enclose the timing chain bolts (6a).
- 7 Screw the pressure pin (2) into the guide sleeve (4) and press out the timing chain bolts (6a).

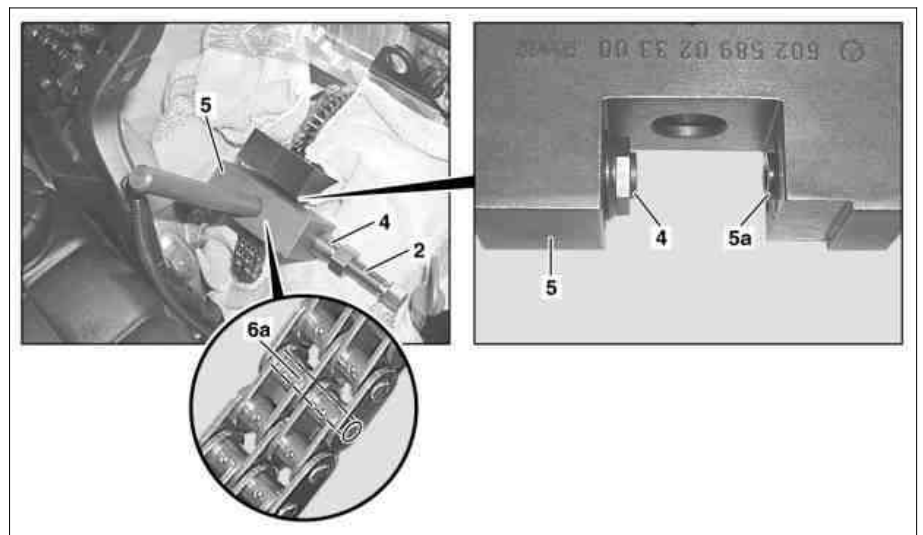

P05.10-2162-05

- 8 Remove timing chain bolts (6a) from the guide (5a).
- 9 Unscrew pressure pin (2) from the guide sleeve (4) and remove the chain separating tool (5).

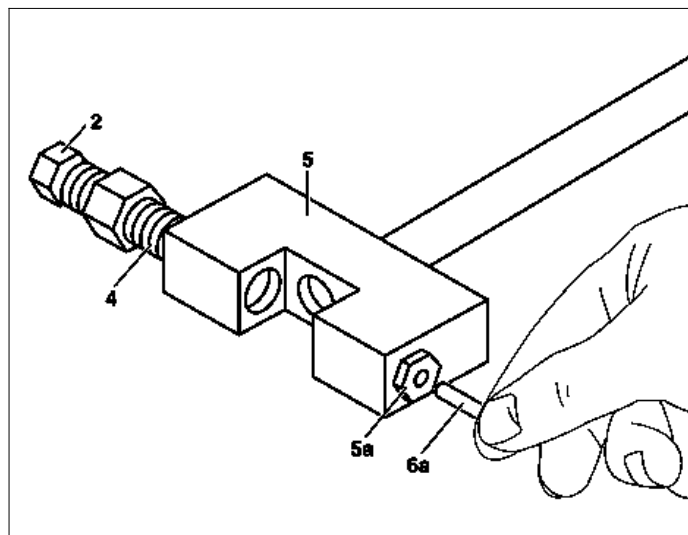

P05.10-2163-11