

Shown on vehicle with electrically adjustable steering column, code 441

- 1 Driver airbag unit
- 2 Steering wheel
- 3 Clock spring contact
- 4 Steering angle sensor
- 5 Combination switch
- 6 Steering column adjustment switch
- 7 Bolts
- 8 DIRECT SELECT selector lever
- 9 CC [TPM] switch

N80 Steering column module

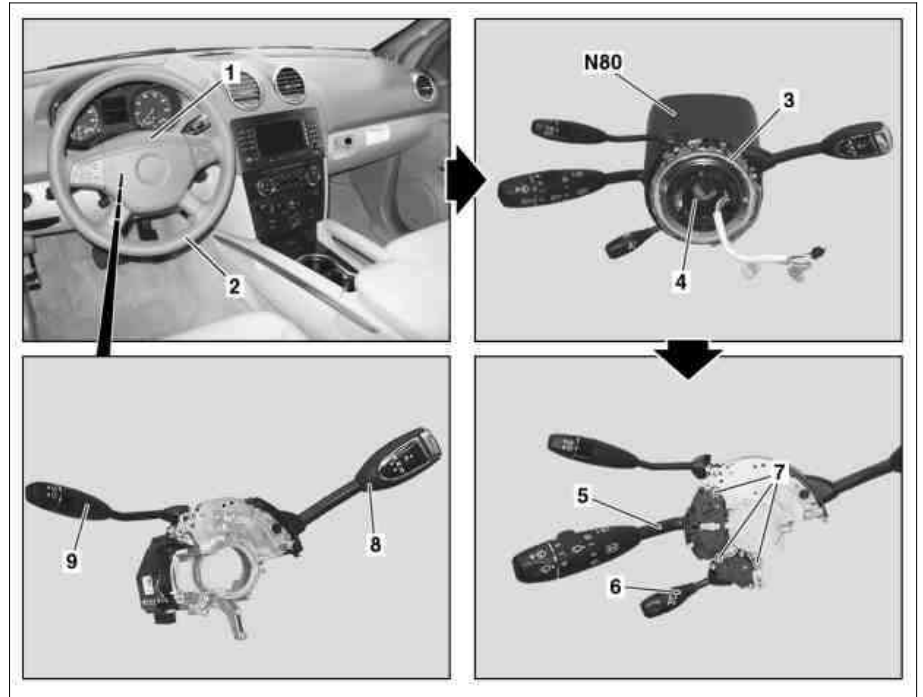

P27.60-2652-06

Modification notes

4.8.06	Disconnect ground line discontinued		
--------	-------------------------------------	--	--

	Remove/install		
Danger!	Risk of injury caused by performing testing or repair work on airbag or emergency tensioning retractor units.	Store airbag units with deployment side facing up; do not expose to temperatures greater than 100 °C. When working on these units, disconnect the power supply.	AS91.00-Z-0001-01A
1	Remove driver airbag unit (1)		AR91.60-P-0660GZ
2	Remove steering wheel (2)		AR46.10-P-0100GZ
3	Removing jacket tube module (N80)		AR54.25-P-2802GZ
4	Remove clock spring contact (3)		AR46.10-P-0200GZ
5	Remove steering angle sensor (4)		AR46.10-P-0300GZ
6	Remove bolts (7)	The number of bolts (7) is dependent on the equipment.	
7	Detach steering column adjustment switch (6)	Only on vehicles with electrically adjustable steering column, code 441. Do not damage electrical connector.	
8	Remove combination switch (5).	Do not damage electrical connector.	
9	Install in the reverse order	DIRECT SELECT selector lever (8) and cruise control pushbutton switch (9) form a unit which cannot be disassembled.	
10	Perform basic programming		AR00.19-P-0200GZ
11	Carry out function check		