

Model 164, 166, 292
except code 846 (Running boards)

Shown on model 164.1

- 1 Expansion clips
- 2 Front end cap
- 3 longitudinal member panel
- 4 Basic carrier
- 5 Notch
- 6 Basic carrier
- 7 Nuts
- 8 Expansion clip
- 9 Rear end cap
- 10 Nuts

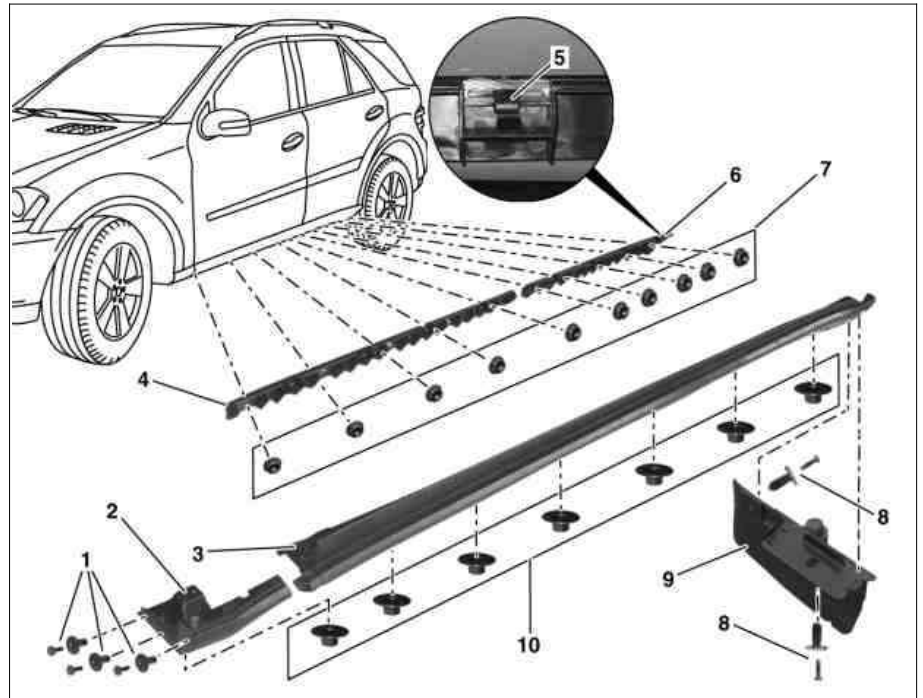

P88.80-2106-06

Shown on model 292

- 3 longitudinal member panel
- 12 Bolts

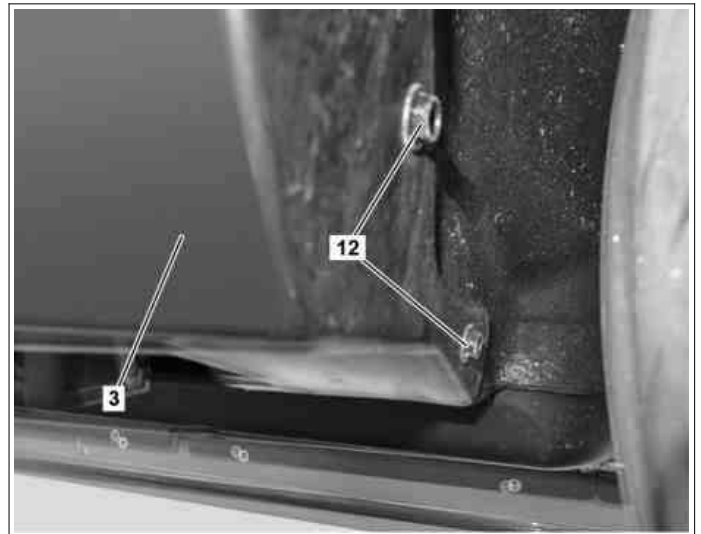

P88.80-2259-11

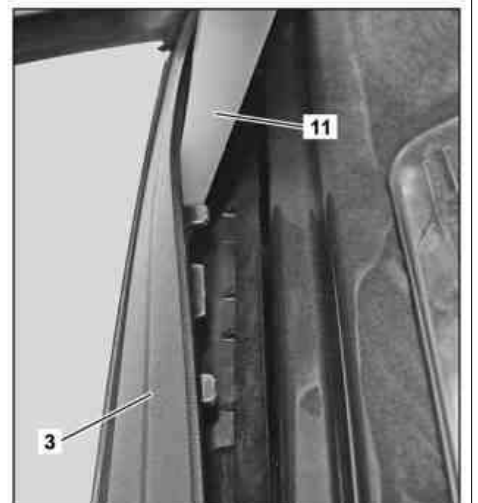

Shown on model 166.8

3 longitudinal member panel

11 Long wedge

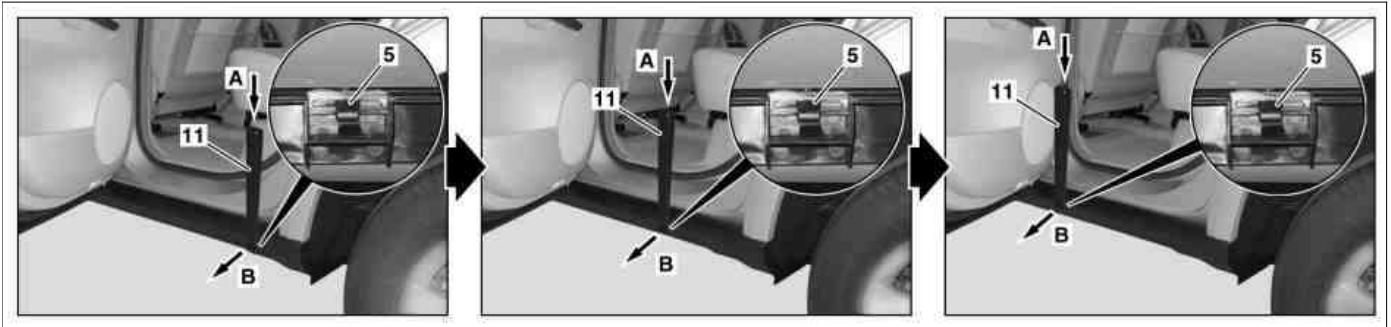

P88.80-2107-07

Shown on model 164.1

5 Notch

11 Long wedge

☒	Remove		
1.1	Unclip expansion clips (1, 8)	Model 164, 166 except code 846 (Running boards) ☑ Clip remover	*452589016300
1.2	Unclip expansion clips (1)	Model 292 except code 846 (Running boards) ☑ Clip remover	*452589016300
2	Remove screws (12)	Model 292 except code 846 (Running boards)	
3	Loosen nuts (10)		
4	Open front door and rear door		
5	Remove front end cap (2) and rear end cap (9)	Model 164.1 except code 846 (Running boards)	
6	Mask front lower corner (arrow) on front and rear door	Model 166, 292 except code 846 (Running boards) ⚠ Mask front lower corner (arrow) o front and rear door with felt strips. Otherwise damage will occur. Felt strip	*BR00.45-Z-1150-02A
7	Position long wedge between longitudinal member and longitudinal member paneling (3) and press in catches (5) one after the other using long wedge (arrow A)	⚠ Do not press notches (5) to far in with assembly wedge. Otherwise they can break off. ℹ Model 166.8, 292 except code 846 (Running boards) Start at front. ℹ Model 164, 166.0 except code 846 (Running boards) Start at rear. ☑ Long wedge	*115589035900
8	Disengage longitudinal member paneling (3) (arrow B) and remove		
9	Unscrew nuts (7) and remove basic carriers (4, 6)	If necessary. ℹ Model 166, 292 except code 846 (Running boards) Basic carrier (4, 6) is designed as one part.	
☒	Install		
10	Install basic carriers (4, 6) and tighten nuts (7)	ℹ Model 166, 292 except code 846 (Running boards) Basic carrier (4, 6) is designed as one part.	

11	Press longitudinal member panel (3) to basic carrier (4, 6) until notches (5) arrest perceptibly		
12	Remove front end cap (2) and rear end cap (9)	Model 164.1 except code 846 (Running boards)	
13.1	Clip in expansion clips (1, 8)	Model 164, 166 except code 846 (Running boards) i Replace damaged expansion clip (1, 8).	
13.2	Clip in expansion clips (1)	Model 292 except code 846 (Running boards) i Replace damaged expansion clips (1).	
14	Tighten bolts (12)	Model 292 except code 846 (Running boards)	
15	Tighten nuts (10)		
16	Remove felt strips on front lower corner (arrow) on front and rear door and close doors	Model 166, 292 except code 846 (Running boards)	

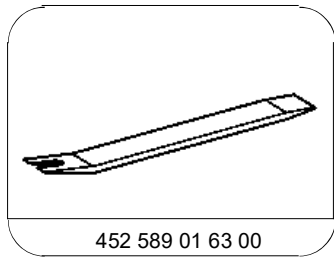

Clip remover

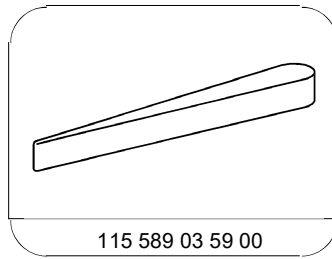

Long wedge

Repair materials

Number	Designation	Order number
BR00.45-Z-1150-02A	Felt strip	A 000 983 89 10