

Model 164

Nm Trailer coupling mechanism

Number	Designation		Model 164.1/8 ORIS trailer hitch (standard)	Model 164.1/8 WESTFALIA trailer hitch (accessories)
BA31.11-P-1001-01G	Screw/bolt, reinforcement arm to vehicle floor	Nm	66	55

Nm Trailer coupling mechanism

Number	Designation		Model 164.1/8 ORIS trailer hitch (standard)	Model 164.1/8 WESTFALIA trailer hitch (accessories)
BA31.11-P-1002-01G	Bolt/nut, trailer hitch/reinforcement plate to rear center section	Nm	66	55

Nm Trailer coupling mechanism

Number	Designation		Model 164.1/8 ORIS trailer hitch (standard)	Model 164.1/8 WESTFALIA trailer hitch (accessories)
BA31.11-P-1004-01G	Screw/bolt, trailer hitch to reinforcement arm	Nm	120	95

Shown on trailer hitch except CODE (494) USA version

- 1 Cross member
- 2 Longitudinal member reinforcement, left
- 3 Longitudinal member reinforcement, right
- 5 Bolts
- 13 Bolts
- 15 Nuts

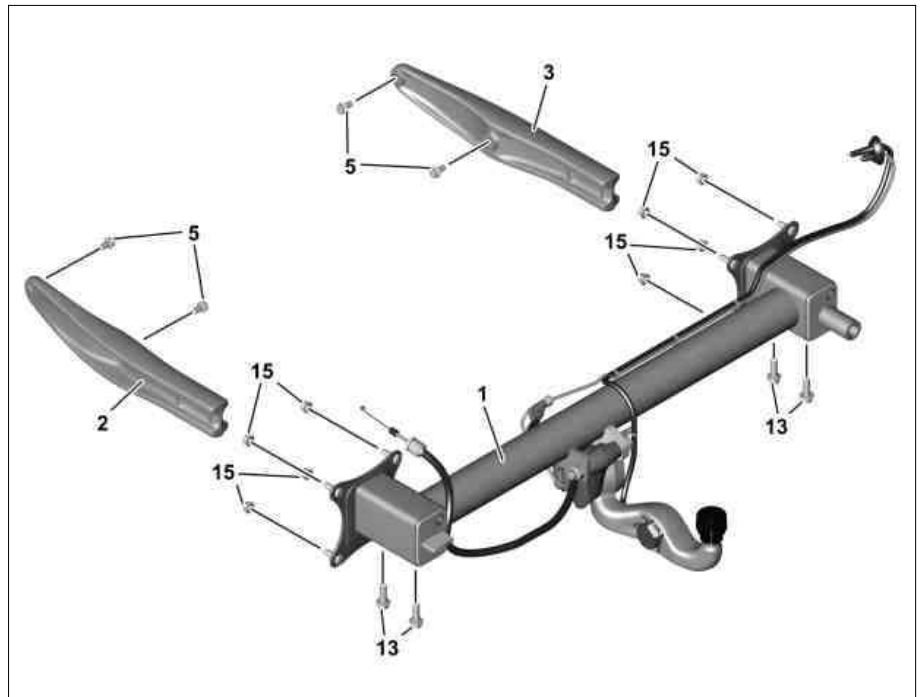

P31.11-2418-06

i The following work procedure is described for MODEL 164.1 with CODE (494) USA version.

- 1 Insert right longitudinal member reinforcement (3) into right longitudinal frame member.
- 2 Insert left longitudinal member reinforcement (2) into left longitudinal frame member.



P31.11-2419-04

- 3 Screw on bolts (5) of right longitudinal member reinforcement (3) finger-tight.

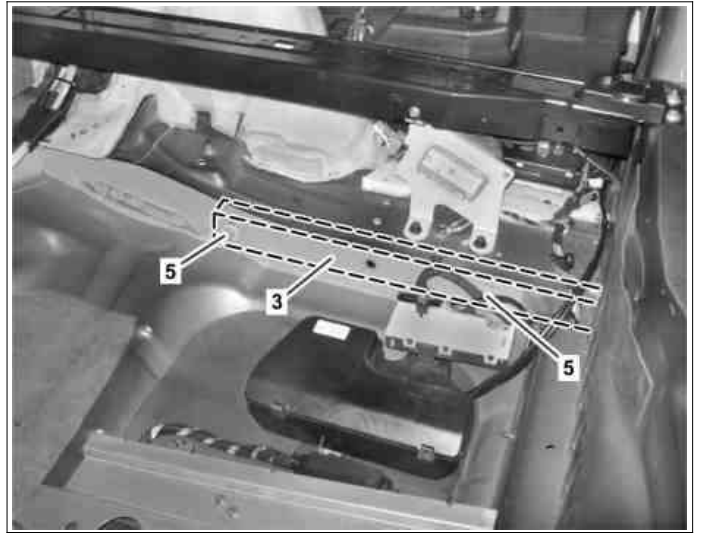

P31.11-2420-11

- 4 Screw on bolts (5) of left longitudinal member reinforcement (2) finger-tight.

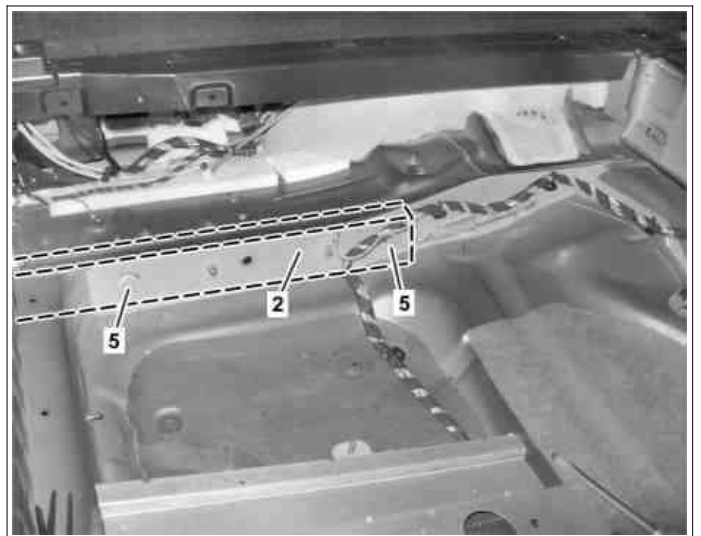

P31.11-2421-11

- 5 Mount cross member of trailer hitch (1) on left longitudinal member reinforcement and right longitudinal member reinforcement and screw on bolts (13) finger-tight.

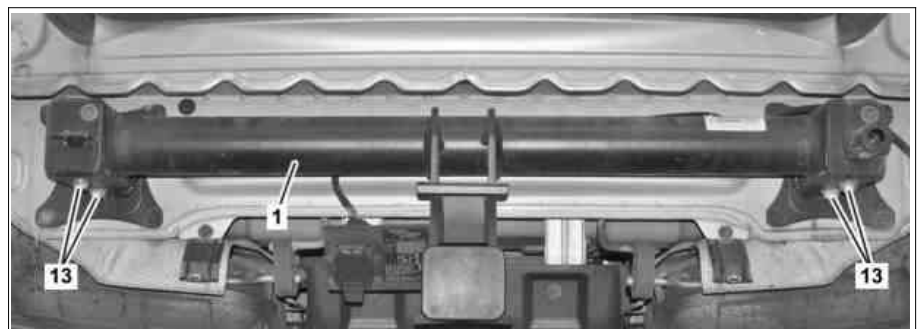

P31.11-2422-04

6 Screw on nuts (15) of crossmember (1) on left and right finger-tight.

7 Align trailer hitch.

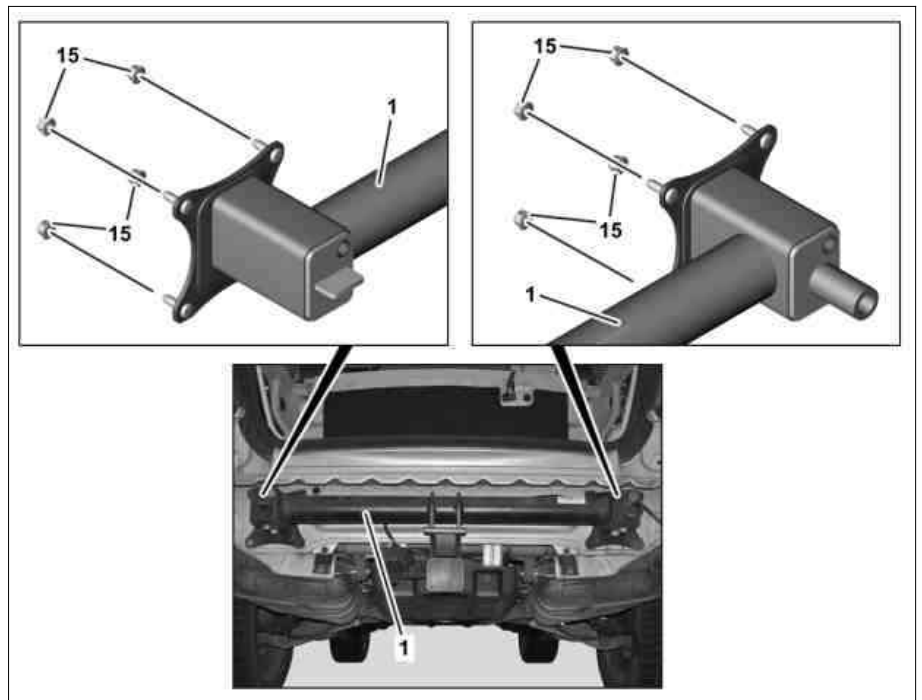

P31.11-2423-06

i It is essential to observe the following tightening sequence.

8 Tighten nuts (15) of crossmember (1) on left and right to $\boxed{\text{Nm}}$ specified torque.

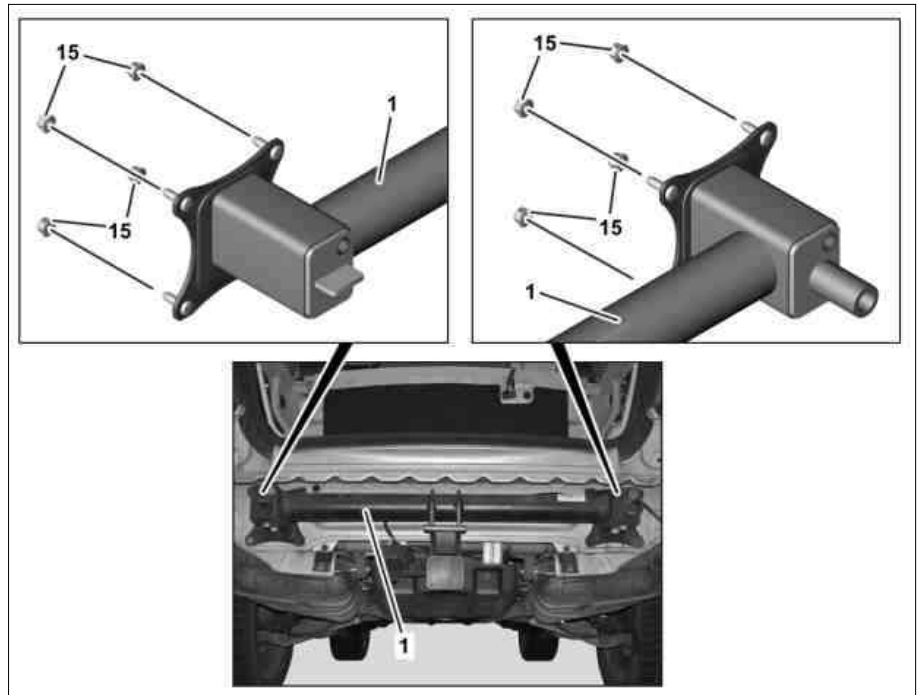

P31.11-2423-06

9 Tighten bolts (5) of right longitudinal member reinforcement (3) to $\boxed{\text{Nm}}$ specified torque.

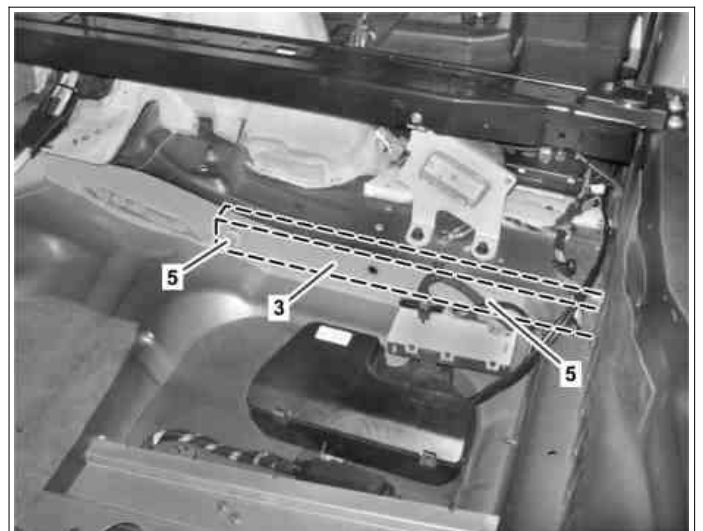

- 10 Tighten bolts (5) of left longitudinal member reinforcement (2) to \square Nm specified torque.

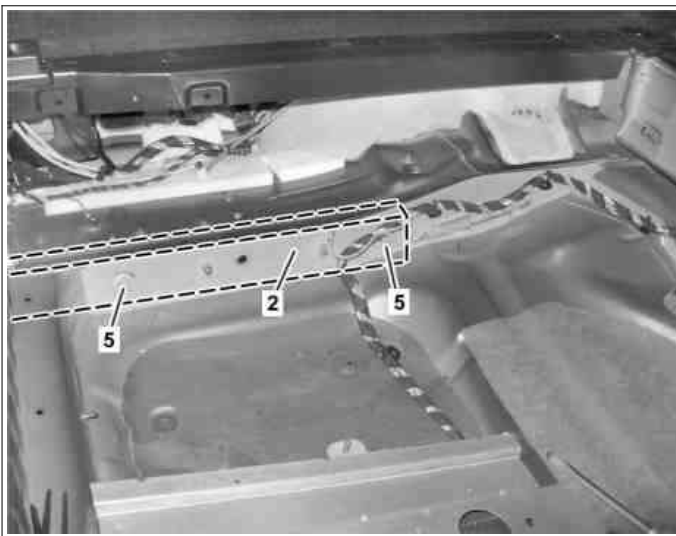

P31.11-2421-11

- 11 Tighten bolts (13) on right and left to \square Nm specified torque.

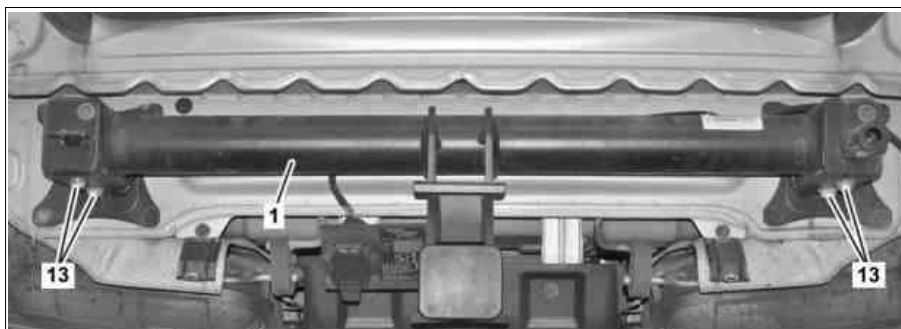

P31.11-2422-04