

Engine 157, 278 in model 166

Engine 157, 278 in model 292

**Shown on engine 157**

- 3 Left engine air intake duct
- 4 Engine charge air duct upstream of ATL
- 5 Engine charge air duct downstream of ATL
- 7 Thermostat housing
- 20 Screw plug

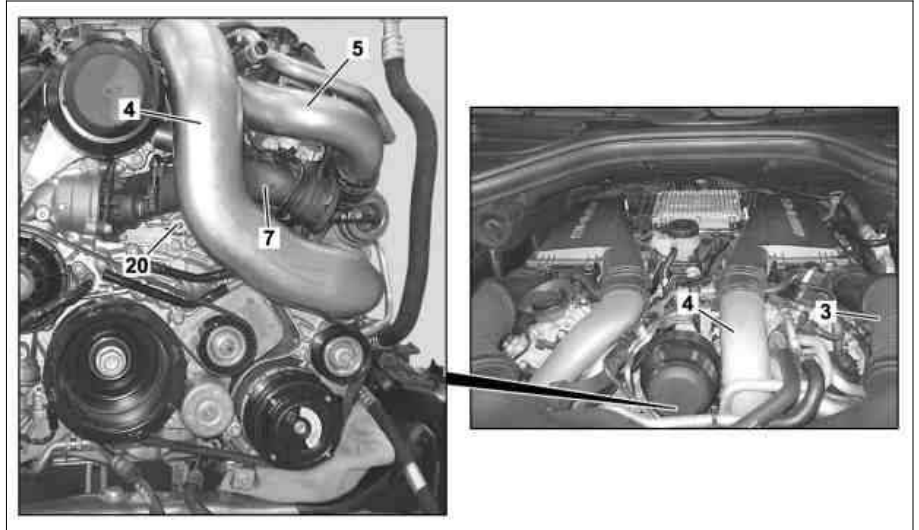

P18.20-2114-05

**Shown on engine 157**

- 9 Bracket
- 10 Coolant lines
- 11 Retaining clips
- 12 Guide pulley
- 18 Oil filter housing
- 20 Screw plug
- 21 bis 27 Screw/bolts

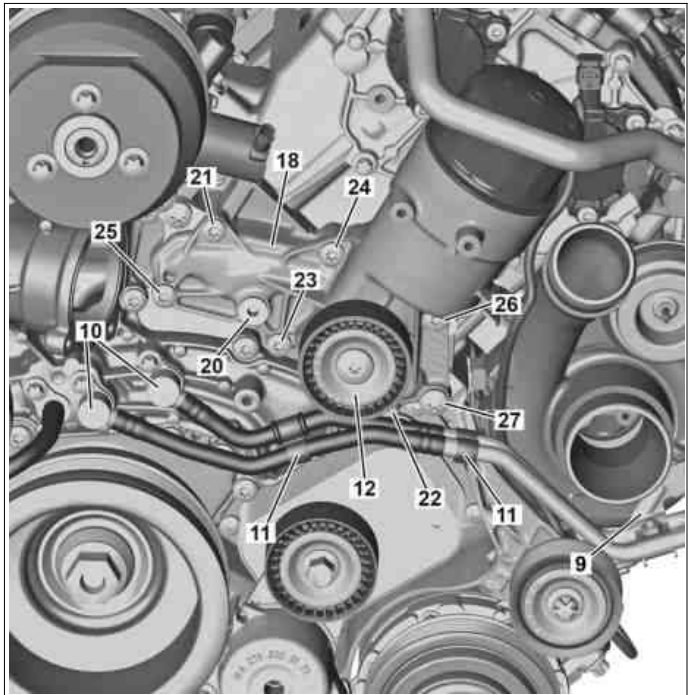

P18.20-2115-12

- 28 Screw/bolt





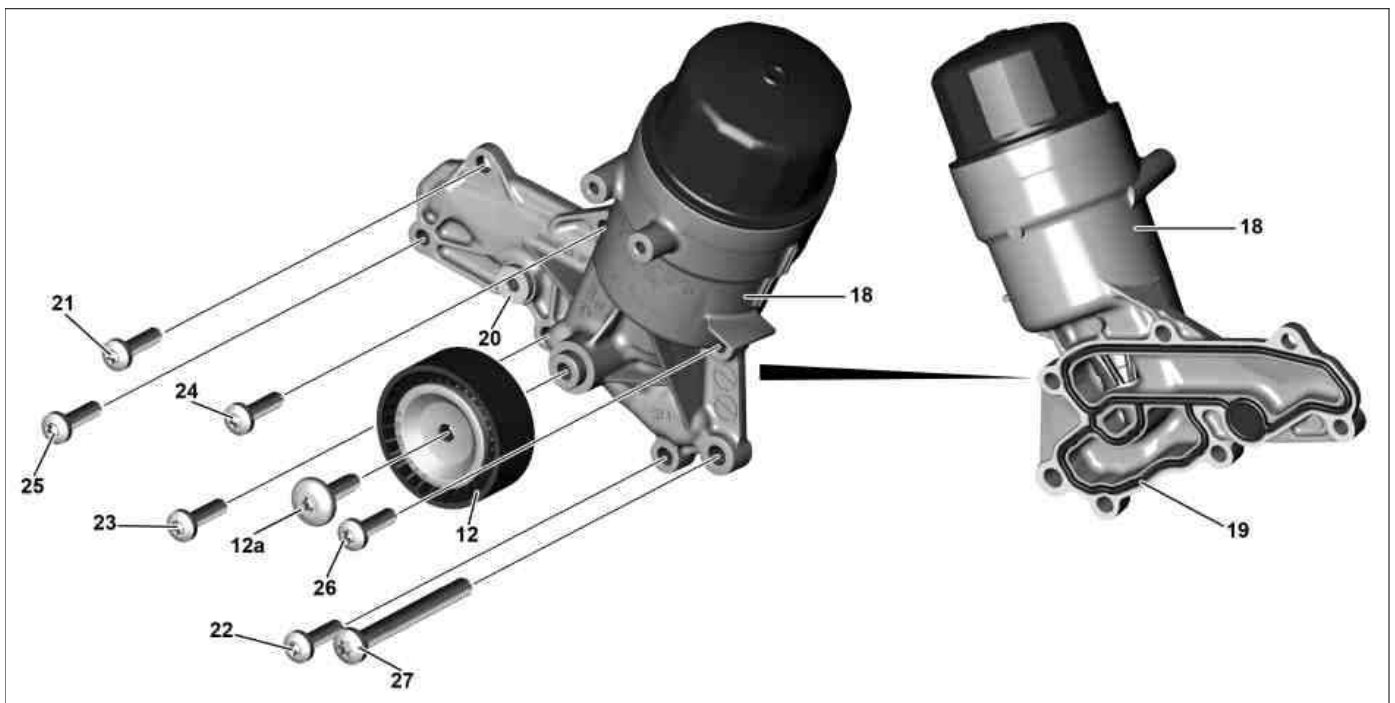



P18.20-2112-01

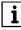

P18.20-2103-09

12	Guide pulley	18	Oil filter housing	20	Screw plug
12a	Screw/bolt	19	Seal	21 bis 27	Screw/bolts

 	Remove/install		
1	Remove central engine cover (1)		
2	Remove left engine air intake duct (3) upstream of the left air filter housing		
3	Detach oil lines for oil cooling from the oil filter housing (18) and timing case cover and set aside	Engine 157 in model 166, 292	
		 Seal openings with  stop plugs.	
		 Record plug	<a href="#">*129589009100</a>
4	Remove left-hand air filter housing		
5	Remove engine charge air duct upstream of ATL (4), engine charge air duct downstream of ATL (5)		<a href="#">AR09.41-P-8620MLJ</a>
6	Drain coolant at radiator		<a href="#">AR20.00-P-1142GQ</a>
	Notes on coolant		<a href="#">AH20.00-N-2080-01A</a>
7	Remove poly-V belt		<a href="#">AR13.22-P-1202MLJ</a>
8	Remove thermostat housing (7)		<a href="#">AR20.10-P-2460MLJ</a>
9	Detach feed line and return flow coolant line bracket from oil filter housing (18)		<a href="#">AR20.20-P-7440MLJ</a>
10	Detach bracket for coolant line from water pump housing		<a href="#">AR20.20-P-7440MLJ</a>
11	Release bracket (9) for the feed line and return flow coolant lines (10) on ATL and remove coolant lines (10) from bracket (9)		<a href="#">AR20.20-P-7440MLJ</a>
12	Remove retaining clamps (11) from coolant lines (10)		
13	Detach guide pulley (12) for poly-V belt from oil filter housing (18); to do this remove screw/bolt (12a)		<a href="#">AR13.20-P-0016MLJ</a>
		 <b>Installation:</b> Check guide pulley (12) for damage and replace if necessary.	
14	Detach ATL coolant lines (10) from coolant pump		<a href="#">AR20.20-P-7440MLJ</a>
15	Loosen screw/bolt (28) on coolant line bracket		
16	Remove screw/bolts (21 to 27) for the oil filter housing (18) and oil filter housing (18) from the timing case cover	Bolt plan for oil filter housing	<a href="#">AR18.20-P-3471-01MMB</a>

		<p> <b>Installation:</b> Always observe tightening sequence for oil filter housing (18). Damage can occur on oil filter housing (18) and timing case cover otherwise.</p> <p> <b>Installation:</b> Replace seal (19) for the oil filter housing (18).</p> <p> Engine 157 in model 166, 292Screw plug to oil filter housing</p> <p> Engine 157 in model 166, 292Bolt, oil filter housing to timing case cover</p> <p> Engine 278 in model 166, 292Screw plug to oil filter housing</p> <p> Engine 278 in model 166, 292Bolt, oil filter housing to timing case cover</p>	<p>*BA18.20-P-1002-01Z</p> <p>*BA18.20-P-1003-01Z</p> <p>*BA18.20-P-1005-01Y</p> <p>*BA18.20-P-1006-01Y</p>
17	Install in the reverse order		
	<b>Check</b>		
18	Check engine oil level using oil dipstick approx. 5 min after switching off engine when it has reached operating temperature; correct if necessary	<p>Engine 157 in model 166, 292</p> <p>Engine 278 in model 166, 292</p> <p></p> <p>Vehicle must be horizontal and standing on its wheels. Measurement errors can occur otherwise.</p>	<p>AP18.00-P-0101EWG</p> <p>AP18.00-P-0101EL</p>
19	<p><b>Risk of accident</b> from vehicle starting off by itself when engine running. <b>Risk of injury</b> (bruises and burns) resulting from working on the engine while it is being started or when it is running.</p> <p>Carry out an engine test run, checking the engine for proper operation and leaktightness</p>	<p>Secure vehicle to prevent it from starting off by itself. Wear closed and snug-fitting work clothes. Do not touch hot or rotating parts.</p>	<p>AS00.00-Z-0005-01A</p>

Oil filter

Number	Designation			Engine 157
BA18.20-P-1002-01Z	Screw plug to oil filter housing	M12	Nm	20

Oil filter

Number	Designation			Engine 157	
BA18.20-P-1003-01Z	Bolt, oil filter housing to timing case cover	M7	Stage 1	Nm	5
			Stage 2	Nm	14
		M8	Stage 1	Nm	5
			Stage 2	Nm	20

Oil filter

Number	Designation			Engine 278
BA18.20-P-1005-01Y	Screw plug to oil filter housing	M12	Nm	20

Oil filter

Number	Designation			Engine 278	
BA18.20-P-1006-01Y	Bolt, oil filter housing to timing case cover	M7	Stage 1	Nm	5
			Stage 2	Nm	14
		M8	Stage 1	Nm	5
			Stage 2	Nm	20

