

## MODEL 220

- 1 Front cover
- 2 Tabs
- 3 Knee protection
- 4 Bolts
- 5 Hook
- 6 Heater housing

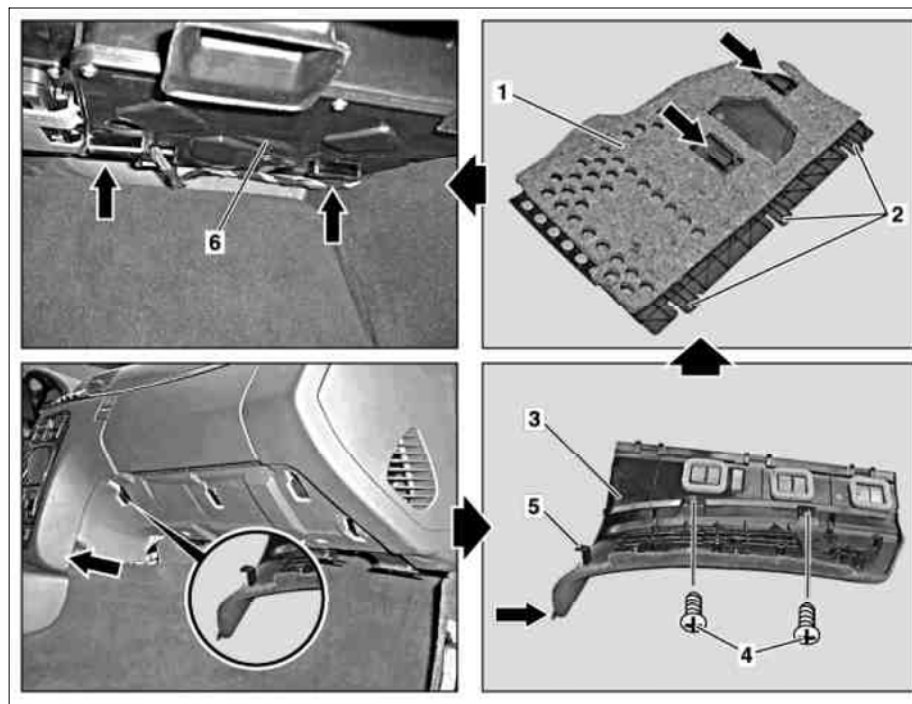

P68.10-2002-06

☒ ☒	Remove/install		
1	Remove cover (1) with catch lugs (2) out of knee protection (3) toward front and rear from both retaining brackets (arrows) on heater housing (6)	<b>i</b> <b>Installation:</b> Install both front catch lugs (arrows) for cover (1) into retaining bracket (arrows) on heater housing (6).	
2	Unclip footwell illuminations from knee protection (3) and disconnect connector.		
3	Unscrew screws (4)		
4	Remove knee protection (3) with hooks (5), (4 each) downward out of instrument panel and simultaneously from center console.	<b>i</b> <b>Installation:</b> Ensure that side guide lugs (arrow) of knee protection (3) are correctly installed in area of center console (arrow).	
5	Install in reverse sequence.		