

MODEL 220

- 1 Bowden cable
 - 2 Locking bar
 - 5 CL cable
 - 6 Door lock
 - 9 Window lift guide rail
 - 10 Bolt
 - 11 Bolt
- Arrow blind rivet

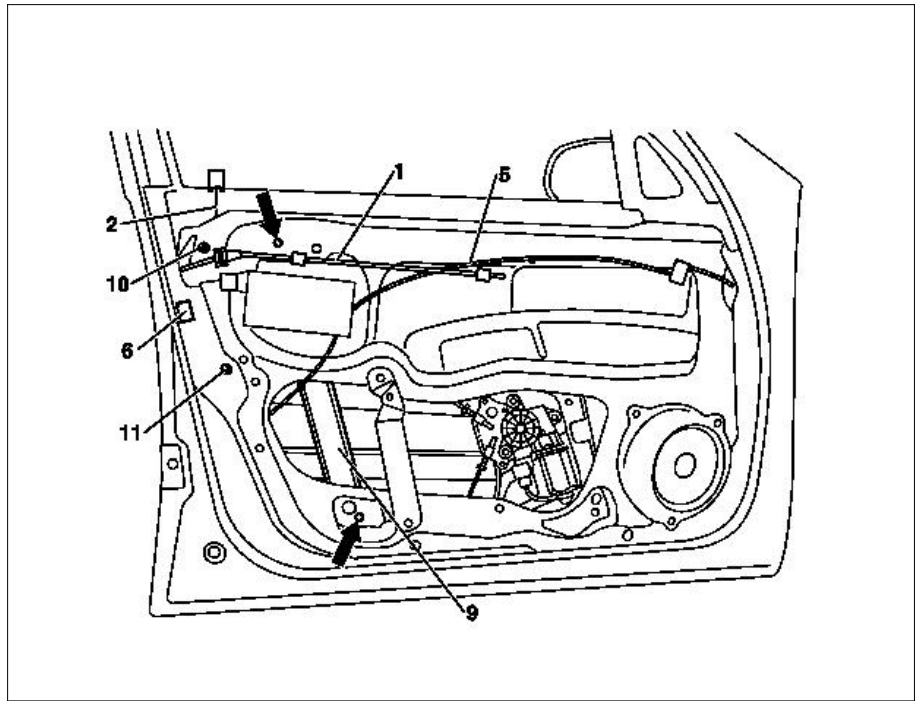

P72.10-2007-06

- 1 Bowden cable
- 2 Locking bar
- 3 Unlocking bar
- 4 Fuse
- 6 Door lock
- 8 Bracket
- 11 Screws

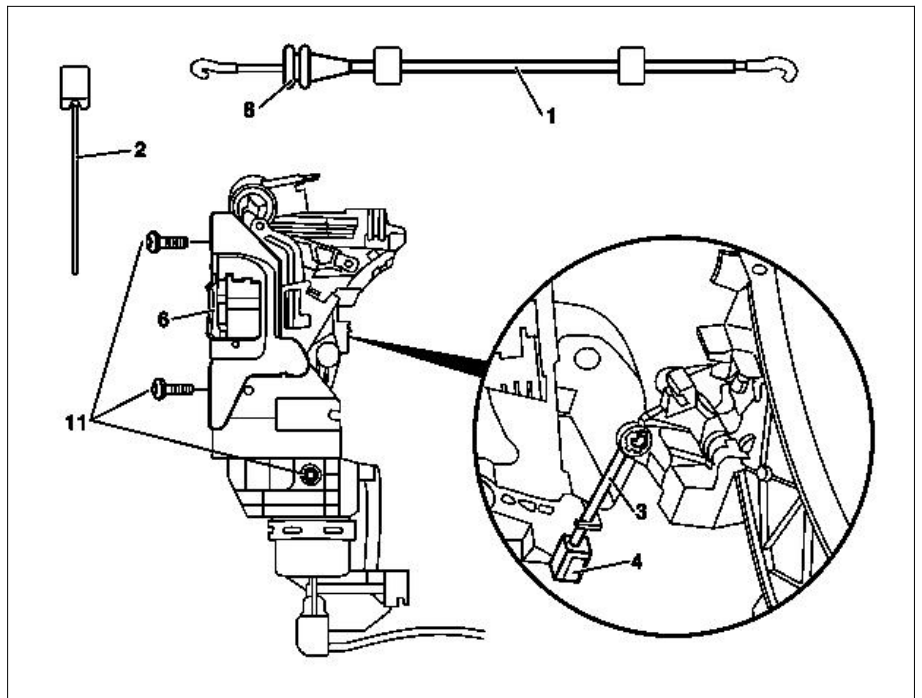

P72.10-2006-06

☒	Removing		
1	Remove door liner on front door		AR72.10-P-1000M
2	Remove crank operated window on front door		AR72.10-P-1900M
3	Unhook Bowden cable (1) for inside door opener onto door lock (6) and remove	ⓘ Unclip holder (8) on lock	
4	Open retainer (4) for unlocking bar (3)		
5	Press IRCL line (5) off door lock IRCL element		
6	Drill out blind rivets (arrows)	ⓘ Use 4.8 mm dia. drill for drilling out, taking care not to damage the inner door panel. Drive out remains of rivets with suitable drift. Remove remains of rivets and swarf from door, danger of rusting	

7	Unhook window lift guide rail (9) from inner door panel and push to one side		
8	Unscrew lock fixing screws (11)		
9	Unscrew lock cover screw (10)	i Lock cover is permanently attached to the door lock and cannot be removed separately	
10	Remove door lock (6) via access cover		
🔧	Installing		
11	Insert door lock (6) via access cover		
12	Screw in lock fixing screws (11)		*BA72.10-P-1008-01E
13	Screw in and tighten screw (10) for lock cover		
14	Hook window lift guide rail (9) onto inner door panel with the two mounting hooks		
15	Rivet window lift guide rail (9) flush with inner door panel with 4.8 mm blind rivets (arrows)		
16	Connect central locking line (5) to central locking element on door lock		
17	Close retainer (4) for unlocking bar (3)	i With retainer (4) open, push unlocking bar upwards until resistance can be felt. Then close retainer again	
18	Hang Bowden cable (1) onto door lock (6)	! Clip holder (8) to door lock	
19	Install crank window		AR72.10-P-1900M
20	Adjust crank window on front door		AR72.10-P-1950M
21	Check clearance and correct if necessary		*BE72.10-P-1001-01C
22	Carry out operational check		
23	Fix sound deadener to inner door panel		
24	Install door liner on front door		AR72.10-P-1000M

Nm Front door

Number	Designation	Model 220
BA72.10-P-1008-01E	Screw on door lock	Nm 10

Front door test values

Number	Designation	Model 220
BE72.10-P-1001-01C	Clearance	mm 2 (±1)

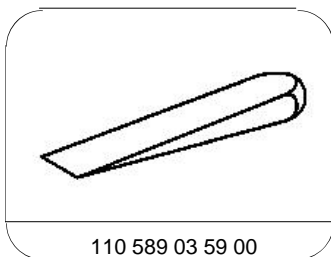

Assembly wedge