

MODEL 124, 129, 140, 164, 168, 170, 202, 203, 208, 209, 210, 211, 215, 220, 230, 240

MODEL 414

Left illustration

1 to 5 Tightening sequence

Right figure

Arrows Interchange wheel-and-tire assemblies (vehicles without mixed tires)



P40.10-3632-01

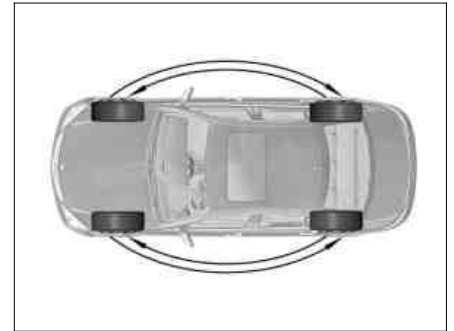

P40.10-4916-01

Modification notes

23.3.11	Information on bolted wheel connection added	Step 5	
---------	--	--------	--

<b>Removing</b>			
<b>Danger!</b>	<b>Risk of death</b> caused by vehicle slipping or toppling off of the lifting platform.	Align vehicle between columns of vehicle lift and position four support plates at vehicle lift support points specified by vehicle manufacturer.	AS00.00-Z-0010-01A
1	Hoist vehicle with lifting platform until wheels are free	Model 164 Model 203, 209 Model 211	AR00.60-P-1000GZ AR00.60-P-1000P AR00.60-P-1000T
2	Pull off wheel covers	Vehicles with wheel covers	
3	Unscrew wheel bolts and remove wheel-and-tire assemblies	Model 164, 240: Remove wheel-and-tire assemblies with wheel lift Wheel lift/wheel lift truck <a href="#">gotis://F_40.1_06.0</a> 	*199589010900
<b>BT</b>	Wheel bolts modified	Model 210	BT40.10-P-0001-01A
<b>Check</b>			
4	Check tires for damage and condition, measure tread depth and note down measurements on maintenance sheet Information on tires / rims		AP40.10-P-4051Z  AH40.10-P-9411-01A
5	Clean and check wheel bolt connection components, then protect against corrosion	Before mounting a wheel-and-tire assembly <b>all</b> the operation steps listed in the linked description must be conducted carefully. Otherwise the wheel-and-tire assembly may work its way loose from the vehicle and cause damage to people, property or the environment! Cleaner from package Long-life grease	AP40.10-P-4050-01A  *BR00.45-Z-1028-04A *BR00.45-Z-1001-06A
<b>Install</b>			
6	Change round wheel-and-tire assemblies on front and rear axles	If necessary, and only on vehicles without mixed tires. Maintain running direction of wheel-and-tire assemblies. Otherwise handling characteristics and handling comfort may be impaired and tire wear increased.	
7	Mount wheel-and-tire assembly and tighten wheel bolts	Model 164, 240: Mount wheel-and-tire assemblies with wheel lift Observe the tightening sequence (1 to 5) and tightening torque. Except model 164 and model 210 with code (979) Special protection version Model 210 with code (979) Special protection version Model 164 Model 210	*BA40.10-P-1001-01A *BA40.10-P-1001-01B *BA40.10-P-1001-01J BT40.10-P-0001-01A
<b>BT</b>	Wheel bolts modified		

8	Lower vehicle		
9	Correct tire pressure for all wheel-and-tire assemblies	<p><b>i</b> In the event of tire pressure loss, determine cause and replace valve, tire or rim.</p> <p><b>!</b> On vehicles with tire pressure monitor: Install only valve protection caps made of plastic in order to avoid corrosion.</p> <p>Tire inflation devices - mobile - with / without reservoir</p> <p><a href="#">gotis://F_40.1_09.2</a></p>	
10	Fit wheel covers	Vehicles with wheel covers	
11	Activate the tire pressure monitoring system	<p>On vehicles with tire pressure monitor, wherever possible:</p> <p>Only for wheel-and-tire assembly change, tire replacement or a change in tire pressure: ↓</p> <p>Perform adjustments to the control system</p> <p>Model 164</p> <p>Model 211</p> <p>Model 215, 220</p> <p>Model 230</p> <p>Model 240</p> <p>Model 210.074 / 274</p>	<p>AR54.30-P-1000-02GZA</p> <p>AR54.30-P-1000-02RAT</p> <p><b>AR54.30-P-1000-02RAM</b></p> <p>AR54.30-P-1000-02RAR</p> <p>AR54.30-P-1000-02RAH</p> <p>GF40.15-P-0001-02A</p>
		Tire pressure monitor (RDK) activation	

**Nm** Wheels

Number	Designation	Model 210 with code 979
BA40.10-P-1001-01B	Wheel bolt	Version "A" Nm 150
		Version "B" Nm 110
		Version "C" Nm 110
		See picture BT40.10-P-0001-01A

**Nm** Wheels

Number	Designation	Model 124, 129, 168, 170, 171, 202, 208, model 210 without code 979	Model 140	Model 203
BA40.10-P-1001-01A	Wheel bolt Nm	110	150	110

**Nm** Wheels

Number	Designation	Model 209 without code P98	Model 209 with code P98	Model 211	Model 215
BA40.10-P-1001-01A	Wheel bolt Nm	110	130	130	150

**Nm** Wheels

Number	Designation		Model 220	Model 230	Model 240	Model 414
BA40.10-P-1001-01A	Wheel bolt	Nm	150	130	150	130

**Nm** Wheels

Number	Designation		Model 164
BA40.10-P-1001-01J	Wheel bolt	Nm	150

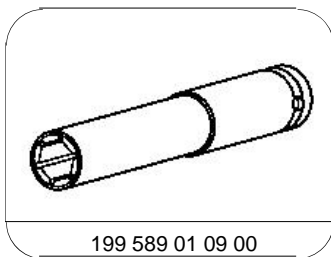

199 589 01 09 00

Socket wrench

**Repair materials**

Number	Designation	Order number
BR00.45-Z-1028-04A	Cleaner from package	Adolf Würth GmbH & Co. KG Reinhold-Würth-Str. 12-17 74653 Künzelsau-Gaisbach Germany Tel. +49 7940 15-0 Fax +49 7940 15-1000 www.wuerth.de
BR00.45-Z-1001-06A	Long-life grease	A 000 989 63 51 11