

MODEL 215.373 /374 /375 /376 /378 /379, 220.026 /028 /063 /065 /067 /070 /073 /074 /075 /083 /084 /087 /128 /165 /167 /170 /173 /174 /175 /179 /183 /184 /187 /875 /878

except CODE (282) Ski bag (through-loading feature)

except CODE (308) Cooling compartment in center rear backrest

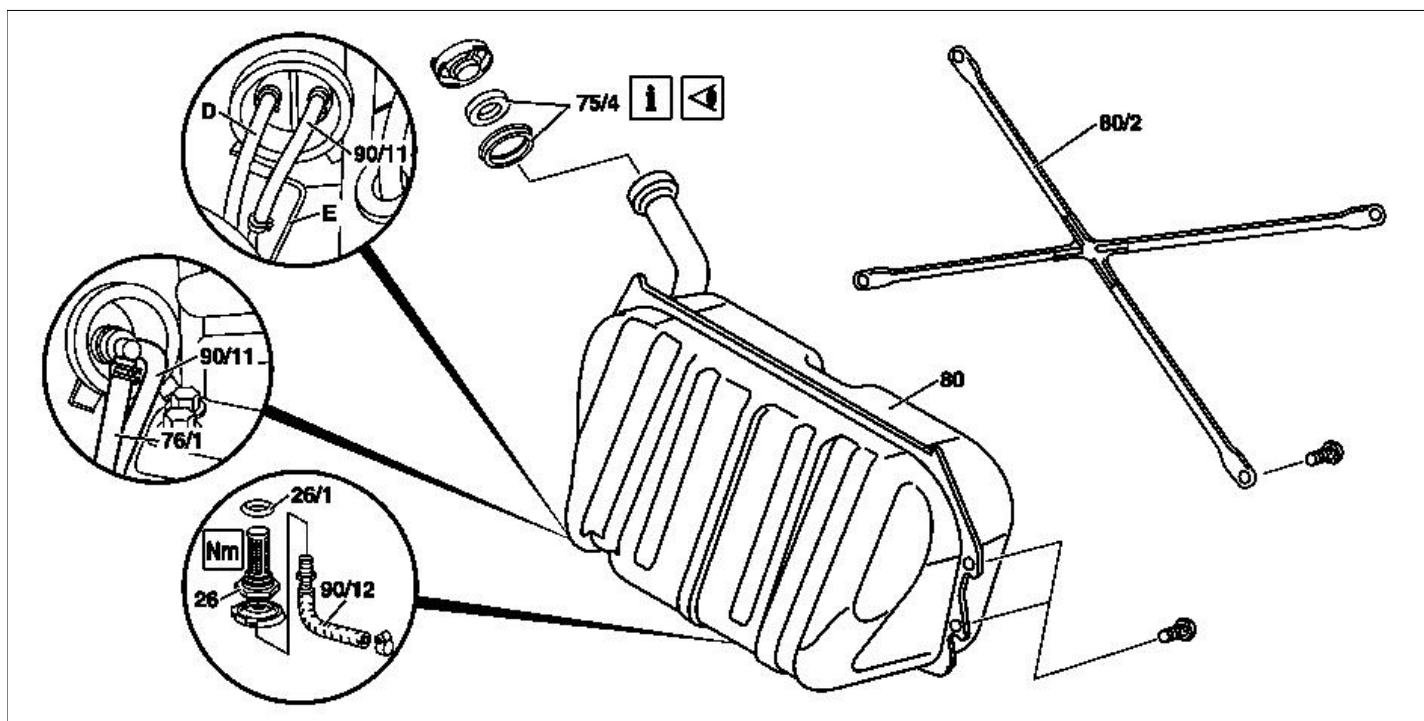

P47.10-2042-09

Shown on fuel tank model 220

26 Fuel strainer

26/1 O-ring

75/4 Cup seals

76/1 Vent line (diesel engine)

80 Fuel tank

80/2 Struts securing fuel tank

90/11 Fuel return hose

90/12 Fuel hose on the suction side with Connection fitting

D Fuel tank - activated charcoal canister line (gasoline engine)

E Fuel filter - fuel tank degassing line (gasoline engine)

Modification notes

4.3.03	Raise vehicle - added	Step 4	
--------	-----------------------	--------	--

	Remove/install		
⚠ Danger!	Risk of explosion caused by fuel igniting, risk of poisoning caused by inhaling and swallowing fuel and risk of injury to eyes and skin caused by contact with fuel	No fire, sparks, open flames or smoking. Only pour fuels into suitable and appropriately marked containers. Wear protective clothing when handling fuel.	AS47.00-Z-0001-01A
1	Drain fuel tank (80)	Pay attention to fuel quantity.	AR47.10-P-4001B *BF47.10-P-1001-01A
2	Remove trim panel in trunk	Model 215.3, 220.0/ 1 Model 220.8	AR68.30-P-4600M AR68.30-P-4600MP
3	Detach mounting struts (80/2) of fuel tank (80)		
⚠ Danger!	Risk of death caused by vehicle slipping or toppling off the lifting platform.	Align vehicle between columns of lifting platform and position four support plates at the lifting platform support points specified by vehicle manufacturer.	AS00.00-Z-0010-01A
4	Raise vehicle		
5.1	Detach fuel hose on the suction side with connection fitting (90/12), fuel return hose (90/11), and fuel tank - activated charcoal canister line (gasoline engine)	Vehicles with gasoline engine. Do not damage fuel filter - fuel tank degassing line (gasoline engine) (E). Collect remaining fuel, seal connections.	

5.2	Detach fuel hose on the suction side connection fitting (90/12), fuel return hose (90/11) and vent line (76/1)	<p>i Vehicles with diesel engine.</p> <p>i Collect remaining fuel, seal connections.</p> <p> Box wrench bit</p> <p>Nm</p>	<p>*000589710300</p> <p>*BA47.10-P-1001-01E</p>
6	Take out fuel tank (80)	i Inspect whether cup seals (75/4) can be re-used.	
7	Check sound deadening mat for damage		
8	Remove fuel strainer (26)	<p>i Clean and check for re-usability.</p> <p>i The splash bowl in the fuel tank is secured against turning with 2 pins. It is attached together with the fuel strainer (26).</p> <p>Nm</p>	*BA47.10-P-1002-01E
9	Replace O-ring (26/1)	i Installation: Oil to facilitate installation.	
10	Install in the reverse order		
11.1	Dispose of fuel tank Disposing fuel tanks	When replacing fuel tank.	OS47.10-P-0001-01A

Nm Fuel tank

Number	Designation		Model	Model
			215	220
BA47.10-P-1001-01E	Fuel strainer in fuel tank	Nm	40	40
BA47.10-P-1002-01E	Fuel hose with connection fitting on fuel strainer	Nm	30	30

Fuel tank

Number	Designation		Model	Model	
			215 without code 282a or code 308	220 without code 282a or code 308	
BF47.10-P-1001-01A	Fuel tank capacity	Total filling capacity	Liters	88	88
		Reserve capacity	Liters	11	11

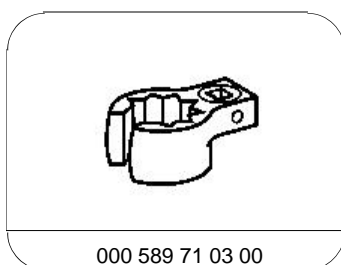

000 589 71 03 00

Box wrench bit