

MODEL 220.074 /174

- 3 Center console
- 5 Cover
- 9 Front stowage compartment floor
- 8 Selector lever cover
- 10 Front stowage compartment lid

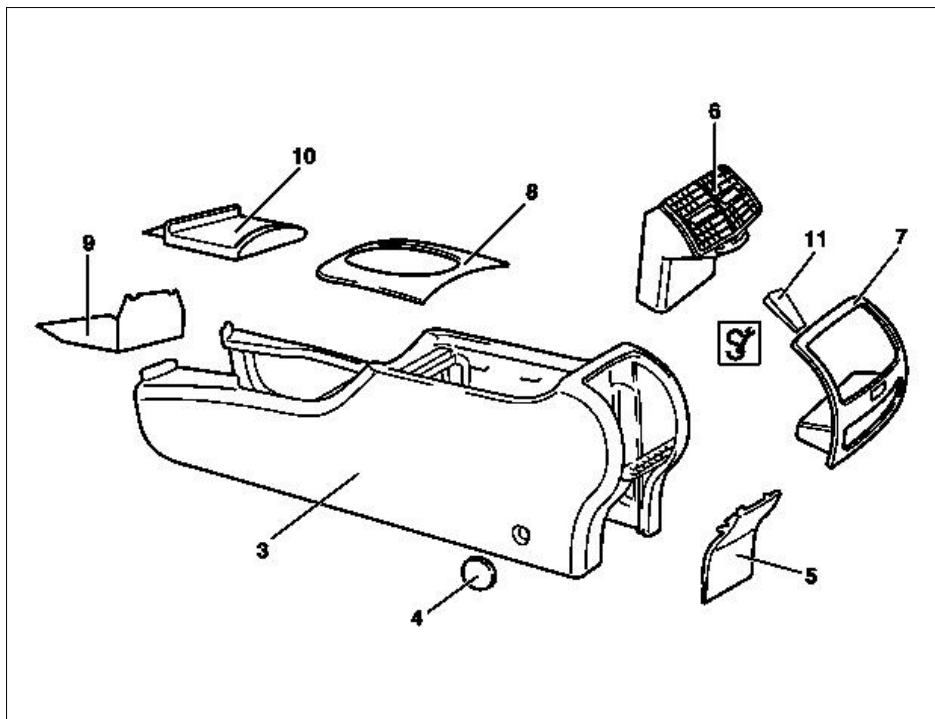

P68.20-2003-06

- 1 Bolts
- 2 Bolts (lateral)
- 3 Center console

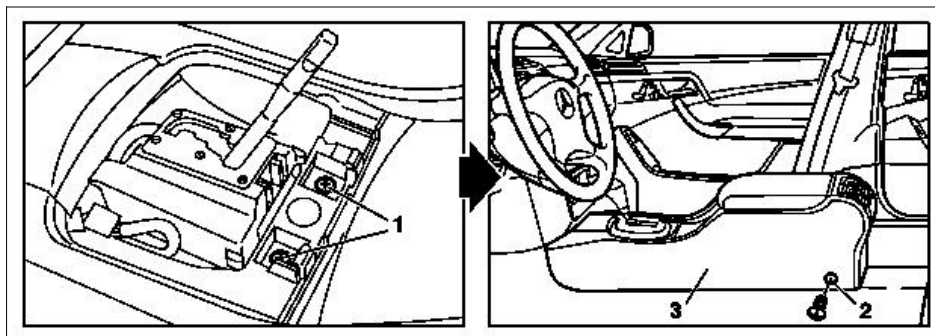

P68.20-2007-04

☒ ☒	Remove/install		
1	Remove selector lever cover (8)	i Position selector lever in position "D"	AR68.20-P-2310M
2	Connect quiescent current retention device		AR54.10-P-1030-07I AS54.10-Z-0001-01A
3	<p>⚠ Danger!</p> <p>Risk of explosion caused by escaping oxyhydrogen gas. Risk of injury caused by caustic burns to eyes, skin and mucous membranes from battery electrolyte (contains diluted sulfuric acid) or metal spatter due to short circuit. Risk of burn injuries caused by short circuit. Risk of poisoning caused by swallowing battery electrolyte (contains diluted sulfuric acid) or absorption of lead over the skin or orifices</p> <p>Disconnect ground cable of battery</p>	<p>No fire, sparks, open flames or smoking. Wear acid-resistant gloves and clothing and safety glasses with side guards. Do not place any conductive objects on the battery and avoid any short circuit from battery positive to ground. Only fill liquid battery electrolyte (diluted sulfuric acid) into suitable and appropriately marked containers.</p> <p>i Turn key in electronic ignition switch EIS into position "0". Key cannot be withdrawn.</p> <p>i Vehicle fitted with code (889) Keyless-Go: Switch off engine, remove Keyless Go cards from the vehicle and keep outside the range of the transmitter.</p> <p>i Ensure that ground cable will not come into renewed contact with the battery terminal as you are working.</p>	AR54.10-P-0003I

④	Notes on battery	i Installation: Read out fault memory after connecting, adjust time display on combination instrument, code radio, normalize power window and activate steering angle sensor. Vehicles with stationary heater: adjust time display on stationary heater.	AH54.10-P-0001-01A
4	Open stowage compartment lid (10) in front of selector lever, unclip floor (9) and take out		
5	Unscrew screws (1)		
6	Unscrew screw (2)	i Move driver and front passenger seat to foremost position.	
7	Unclip and remove top cover (5)		
8	Disconnect connector of rear compartment nozzle adjustment illumination		
9	Disconnect connector of stowage compartment illumination		
10.1	Disconnect connector of telephone system	i Only with code 316 MB telephone, D-network (D2B) in armrest. i Only with code 317 Portable CTEL telephone, D-network (D2B) in armrest.	
11	Disconnect TV connector in rear		
12	Lift rear center console (3) and guide out of instrument panel	i Keep lid (10) closed.	
13	Install in the reverse order		
14	Render electrical system operational	i Perform basic programming (normalize windows and sliding roof, etc.).	AR00.19-P-0200M
15	Carry out function test		