

MODEL 215.373 /374 /375 /376 /378 /379, 220.025 /026 /028 /063 /065 /067 /070 /073 /074 /075 /083 /084 /087 /125 /126 /128 /165 /167 /170 /173 /174 /175 /176 /178 /179 /183 /184 /187

Shown on model 220 with Airmatic

5 Thrust arm  
5g Thrust arm cover

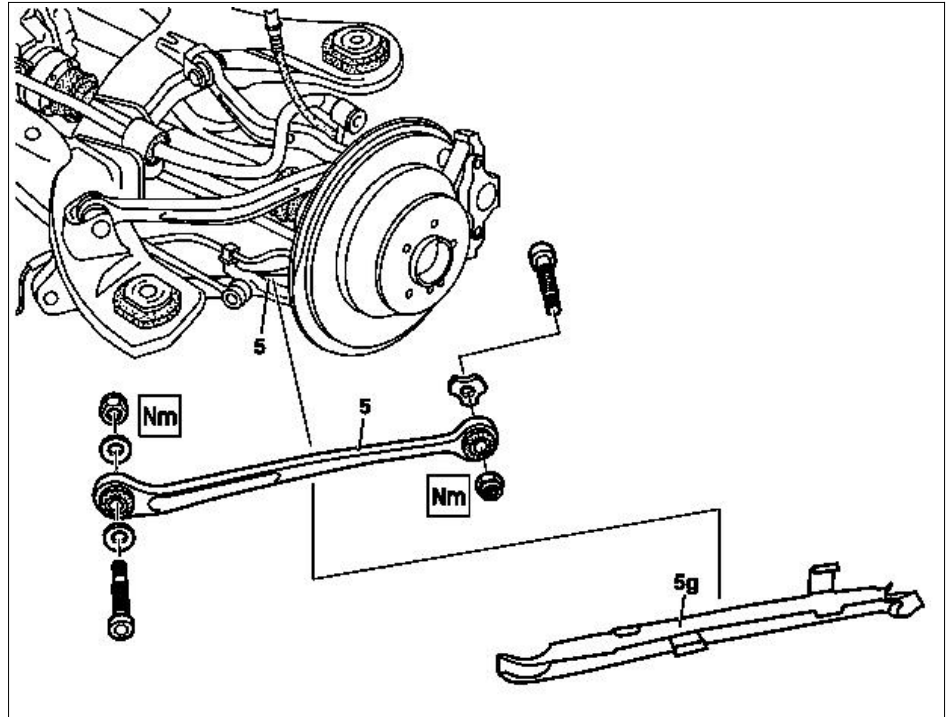

P35.20-2005-06

#### Modification notes

15.3.06	Bolt, thrust arm to wheel carrier	Model 215.374/376	*BA35.20-P-1004-05A
---------	-----------------------------------	-------------------	---------------------

	Remove/install		
<b>Danger!</b>	<b>Risk of death</b> caused by vehicle slipping or toppling off of the lifting platform.	Align vehicle between the columns of the lifting platform and position the four support plates at the lifting platform support points specified by the vehicle manufacturer.	AS00.00-Z-0010-01A
	While working on the rear axle care must be taken to ensure that the surface of all aluminum components do not get any scratches, cracks and notches. Otherwise the service life of the parts will be affected		
	Notes on self-locking nuts and bolts	All models	AH00.00-N-0001-01A
1	Raise vehicle		
2	Unclip thrust arm cover (5g).		
3	Detach thrust arm (5) from wheel carrier and rear axle carrier	<p> <b>Installation:</b> When tightening the camber strut the vehicle must be relieved of load and on its wheels. Otherwise the rubber mounts are constantly under preload and are damaged as a result.</p> <p> Self-locking nut, thrust arm to rear axle carrier</p> <p> Model 215 except 215.376 /379, 220 except 220.074 /174 /176 /179: ↓</p> <p> Self-locking nut, thrust arm to wheel carrier.</p> <p> Screwdriver bit</p> <p> Model 215.376 /379, 220.074 /174 /176 /179: ↓</p> <p> Bolt, thrust arm to wheel carrier</p>	<p>*BA35.20-P-1001-05A</p> <p>*BA35.20-P-1003-05A</p> <p>*119589001000</p> <p>*BA35.20-P-1004-05A</p>
4	Install in the reverse order		

**Nm Torque strut**

Number	Designation			Model 215.373/ 375/378	Model 215.374/ 376	Model 215.379
BA35.20-P-1001-05A	Self-locking nut, torque strut to rear axle carrier	Stage 1	Nm	70	120	120
		Stage 2	∠°	-	-	-
BA35.20-P-1003-05A	Self-locking nut, thrust arm to wheel carrier	Stage 1	Nm	45	-	-
		Stage 2	∠°	45	-	-
BA35.20-P-1004-05A	Bolt, thrust arm to wheel carrier	Stage 1	Nm	-	90	180
		Stage 2	∠°	-	60	-

**Nm Torque strut**

Number	Designation			Model 220.025/026/ 028/063/065/ 067/070/073/ 075/083/084/ 087/125/126/ 128/163/165/ 167/170/173/ 175/178/183/ 184/187	Model 220.074/174/ 176	Model 220.179
BA35.20-P-1001-05A	Self-locking nut, torque strut to rear axle carrier	Stage 1	Nm	70	120	120
		Stage 2	∠°	-	-	-
BA35.20-P-1003-05A	Self-locking nut, thrust arm to wheel carrier	Stage 1	Nm	45	-	-
		Stage 2	∠°	45	-	-
BA35.20-P-1004-05A	Bolt, thrust arm to wheel carrier	Stage 1	Nm	-	90	180
		Stage 2	∠°	-	45	-

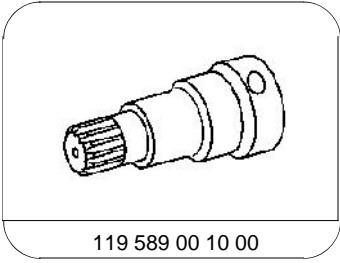

119 589 00 10 00

Screwdriver bit