

Document number : pe80.20-p-2051-97sab
Document title : Electrical function schematic for trunk lid remote closing (HDFS)

Code :	Designation :	Position :
1	Vehicle speed, signal	
1	Vehicle speed, signal	
10	Trunk lid position sensor, status	
11	Trunk lid GL [ZV] motor, request	
12	Trunk lid GL [ZV] motor, actuation	
13	Trunk lid GL [ZV] motor, status	
13	Trunk lid GL [ZV] motor, status	
14	Front central operating unit, status	
15	COMMAND display, actuation	
16	COMMAND controller unit, status	
16	COMMAND controller unit, status	
2	Trunk lid control button, status	
3	Trunk lid open/close switch, status	
3	Trunk lid open/close switch, status	
4	Trunk lid external operation switch, status	
4	Trunk lid external operation switch, status	
5	Transmitter key, request	
5	Transmitter key, request	
5	Transmitter key, request	
6	Access authorization code, signal	
6	Access authorization code, signal	
6	Access authorization code, signal	
7	Trunk lid emergency release switch, status	
7	Trunk lid emergency release switch, status	
8	TLC hydraulic pump, request	
9	TLC hydraulic pump, actuation	
A1	Instrument cluster	
A2/12	Rear window antenna amplifier module	
A40/3	COMMAND control unit	
A40/8	COMMAND display	
A40/9	Front central operating unit	
A8/1	Transmitter key	
A8/1	Transmitter key	
A8/1	Transmitter key	
B24/16	Trunk lid position sensor	
CAN A	Telematics CAN	
CAN B	Interior CAN	
CAN B	Interior CAN	
CAN B	Interior CAN	
CAN B	Interior CAN	
CAN B	Interior CAN	

Document number : pe80.20-p-2051-97sab
Document title : Electrical function schematic for trunk lid remote closing (HDFS)

Code :	Designation :	Position :
CAN B	Interior CAN	
CAN F	Central CAN	
CAN F	Central CAN	
Code 494	USA version	
LIN B1	Front door LIN	
M14/7	Trunk lid CL [ZV] motor	
M51	TLC [HDS] hydraulic pump	
M10/2	Rear SAM control unit with fuse and relay module	
M121	TLC [HDS] control unit	
M69/1	Left front door control unit	
N73	EIS [EZS] control unit	
N93	Central gateway control unit	
S20/1s6	Trunk lid open/close switch	
S62/26	TLC [HDS] button	
S88/10	Trunk lid emergency release switch	
S88/8	Trunk lid external operation switch	
U52	Valid for Japan	
U52	Valid for Japan	
U54	Valid for all except Japan	
U54	Valid for all except Japan	

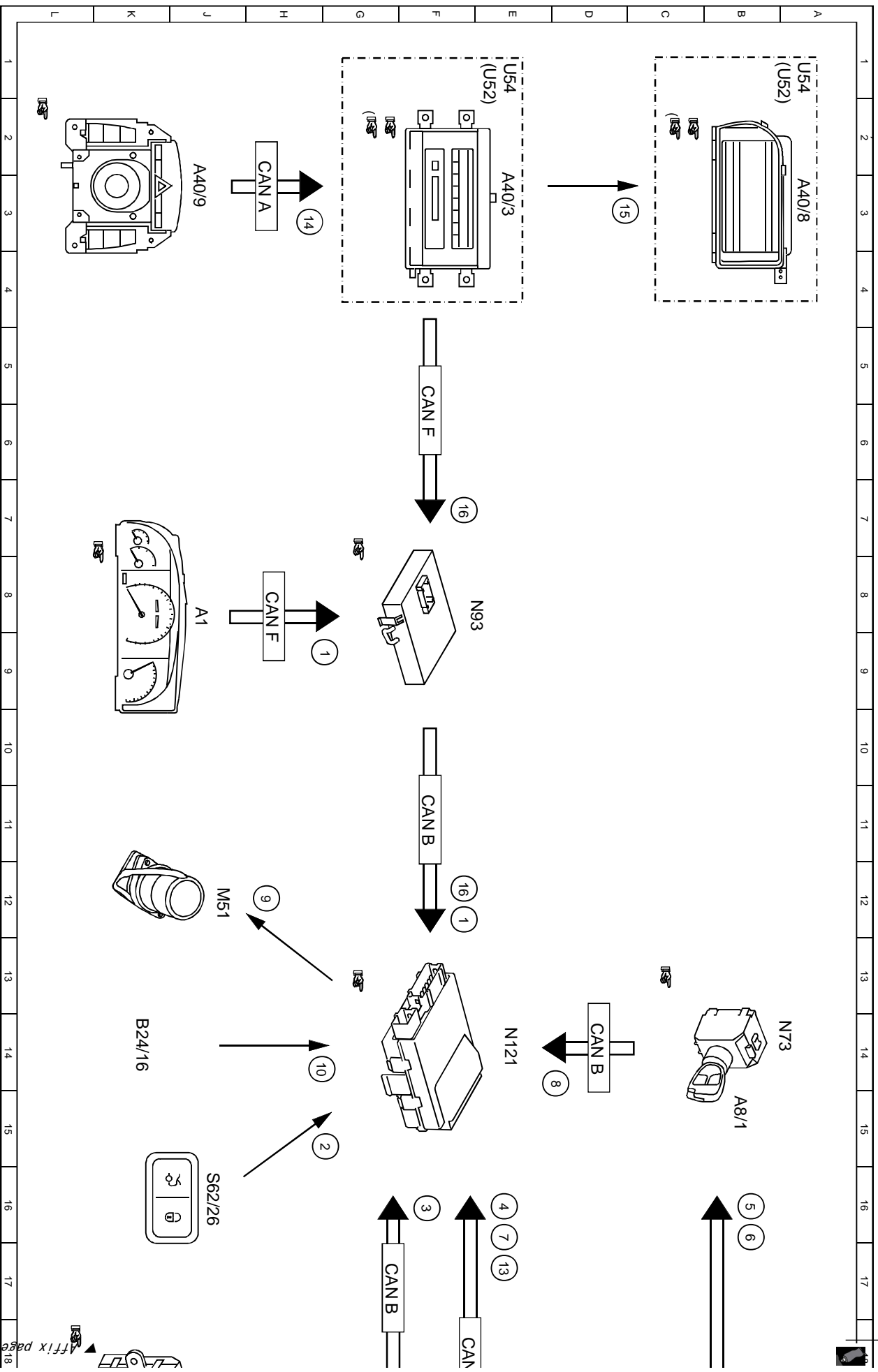

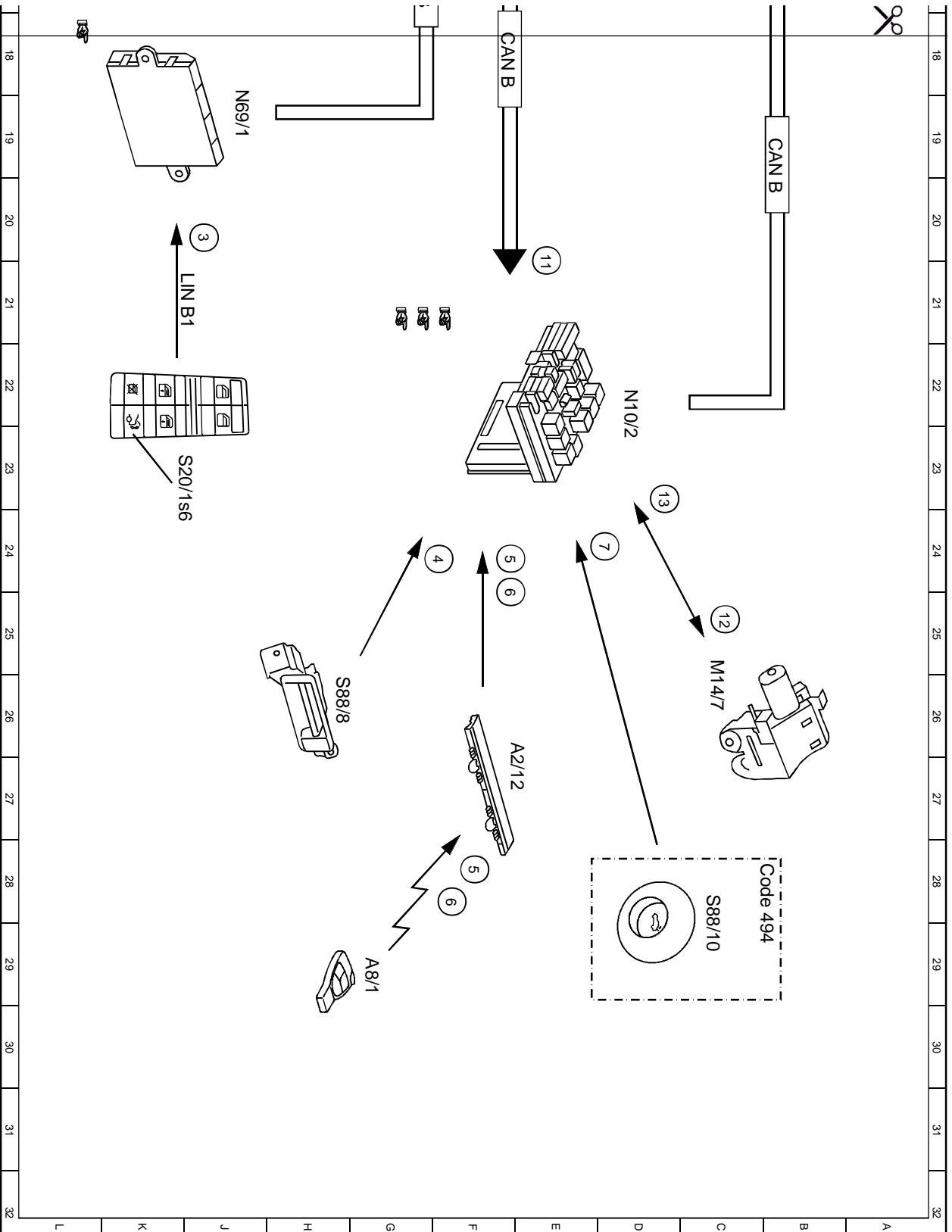

This document was created with Win2PDF available at <http://www.win2pdf.com>.
The unregistered version of Win2PDF is for evaluation or non-commercial use only.
This page will not be added after purchasing Win2PDF.