

Model 117, 156, 176, 205, 213, 222, 242, 246, 253

Shown on model 246

- 1 Grab handle
- 2 Covers
- 3 Clips

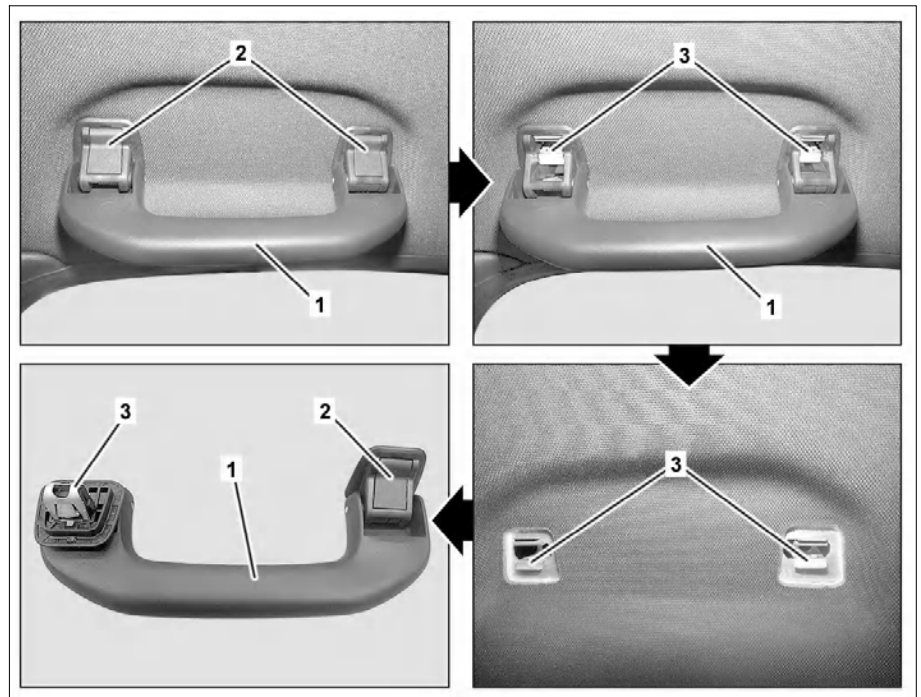

P68.30-3598-06

	Remove		
1	Remove covers (2)		
2	Press clips (3) together and remove grab handle (1)		
3	Disconnect electrical connector from rear illumination on rear grab handle (1)	Model 156 with code 413 (Automatic panoramic sliding sunroof) Model 205, 253 with code 876 (Interior Light package) Model 213, 222	
4	Remove clips (3) from body		
	Install		
5	Clip clips (3) and covers (2) into grab handle (1)		
6	Connect electrical connector to rear illumination on rear grab handle (1)	Model 156 with code 413 (Automatic panoramic sliding sunroof) Model 205, 253 with code 876 (Interior Light package) Model 213, 222	
7	Clip grab handle (1) into roof		
	Check		
8	Check grab handle on roof		AR68.30-P-4330-01NKB