

Document number : pe80.20-p-2051-97sab

Document title : Electrical function schematic for trunk lid remote closing (HDFS)

Code: **Designation:** **Position:**

1	Vehicle speed, signal	
1	Vehicle speed, signal	
10	Trunk lid position sensor, status	
11	Trunk lid CL [ZV] motor, request	
12	Trunk lid CL [ZV] motor, actuation	
13	Trunk lid CL [ZV] motor, status	
13	Trunk lid CL [ZV] motor, status	
14	Front central operating unit, status	
15	COMAND display, actuation	
16	COMAND controller unit, status	
16	COMAND controller unit, status	
2	Trunk lid control button, status	
3	Trunk lid open/close switch, status	
3	Trunk lid open/close switch, status	
4	Trunk lid external operation switch, status	
4	Trunk lid external operation switch, status	
5	Transmitter key, request	
5	Transmitter key, request	
5	Transmitter key, request	
6	Access authorization code, signal	
6	Access authorization code, signal	
6	Access authorization code, signal	
7	Trunk lid emergency release switch, status	
7	Trunk lid emergency release switch, status	
8	TLC hydraulic pump, request	
9	TLC hydraulic pump, actuation	
A1	Instrument cluster	
A2/12	Rear window antenna amplifier module	
A40/3	COMAND control unit	
A40/8	COMAND display	
A40/9	Front central operating unit	
A8/1	Transmitter key	
A8/1	Transmitter key	
B24/16	Trunk lid position sensor	
CAN A	Telematics CAN	
CAN B	Interior CAN	
CAN B	Interior CAN	
CAN B	Interior CAN	
CAN B	Interior CAN	

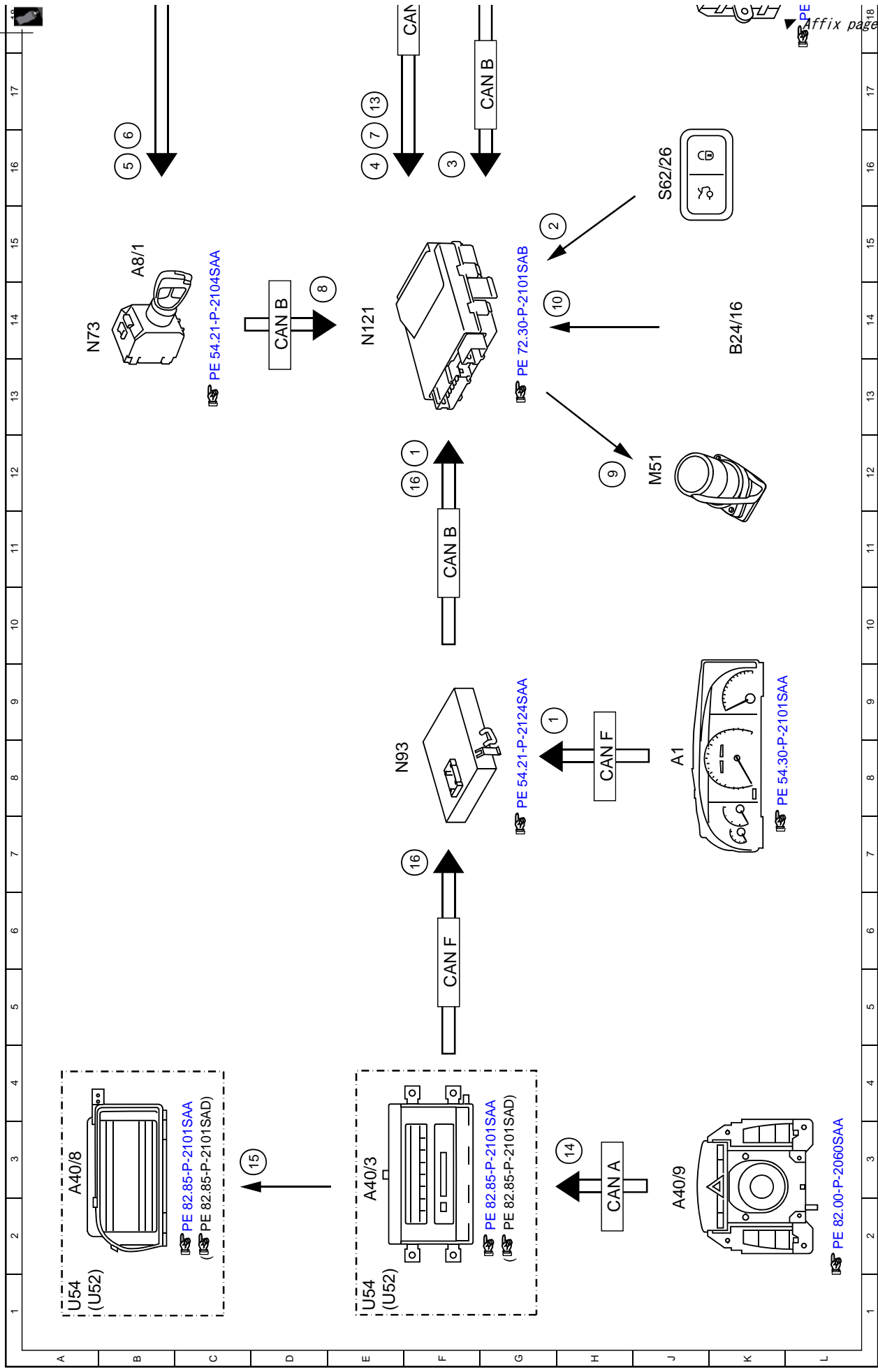

PE Affix page 2 here

