

- Parts list -

Mode	BM mode	BM overview	S 500 4MATIC / S 550 4MATIC USA / JAPAN
VIN/mod. des.	WDD2211861A171391	Catalog	63V
VIN	WDDNG86X58A171391	Group	86 WINDSHIELD WASHER,EMERGENCY EQUIPMT.
Sales designation		Sub-group	030 PANE WASHER,HEADLAMP WIPER/WASHER
Assortment class	PC		
Market			

Copyright 2019-03-03 Daimler AG

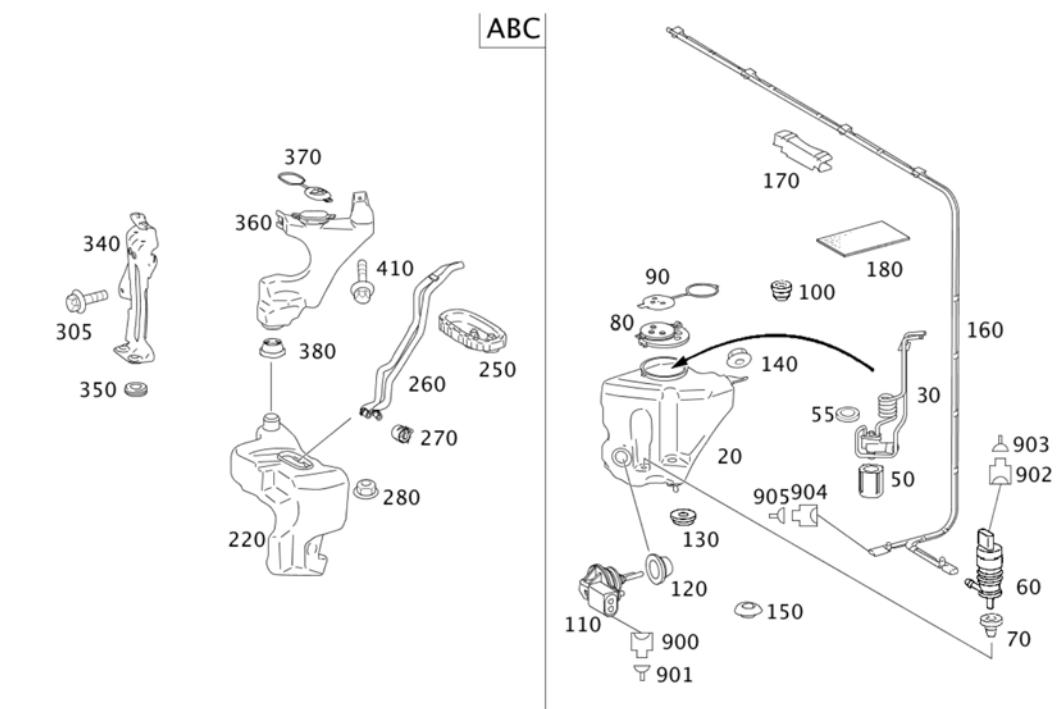









Image ID: drawing_B86030000231

Item	Part number	Designation/additional information	Qty
20	A 221 869 08 20	WASHER FLUID RESERVOIR PANE WASHER,HEADLAMP WIPER/WASHER Code: 600+-487;	1
30	A 221 830 07 61	HEAT EXCHANGER WASHER FLUID HEATER Code: 875;	1
50	A 211 007 00 99	* GROMMET ATTACHMENT FOR HEATER Code: 875+-Z07;	1
55	A 140 997 06 45	* SEALING RING WASHER FLUID HEATER; 7.5X2.0	1
55	A 013 997 40 45	* SEALING RING WASHER FLUID HEATER; 7.5X2.0	1
60	A 221 869 01 21	PUMP WINDSHIELD WASHER	1
70	A 123 997 36 81	GROMMET WASHER FLUID PUMP	1

Item	Part number	Designation/additional information	Qty
70	A 010 997 11 81	GROMMET HEADLAMP WIPER/WASHER PUMP  Code: 600;	1
80	A 221 869 02 08	COVER WATER RESERVOIR  Code: 875+-487;	1
90	A 221 869 00 72	CAP WATER RESERVOIR  Code: 875+-487;	1
100	A 010 997 13 81	GROMMET AT RESERVOIR, TOP  Code: 875+-487;	2
110	A 221 820 91 10	SWITCH WINDSHIELD WASHER WATER LEVEL	1
120	A 203 869 00 98	SEALING WATER LEVEL SWITCH AT CONTAINER	1
130	A 201 504 01 12	ELASTOMER MOLDED PART MOUNTING, TANK  Code: -487;	2
140	A 003 990 53 51	NUT MOUNTING, TANK; M6  Code: -487;	1
150	A 003 997 65 86	STOP PLUG SIDE MEMBER; 10 MM  Code: -487;	4
160	A 221 860 02 92	HOSE HEATED, WITH NOZZLES  Code: 875;	1
170	A 000 995 24 77	LINE BRACKET HOSE FASTENING	1
180	A 126 787 00 97	FELT STRIP HOSE FASTENING; 65X40X2MM	1
900	A 168 545 29 28	RECEPTACLE HOUSING WASHER FLUID LEVEL SWITCH S42; 2-PIN SLK2.8	1
901	A 009 545 81 26	CONTACT SOCKET WASHER FLUID LEVEL SWITCH S42; 0.75-1.0 MM2 SLK2.8	NB
902	A 016 545 46 26	RECEPTACLE HOUSING WASHER PUMP M5/1; 2-PIN MCP2.8	1
903	A 014 545 83 26	CONTACT SOCKET WASHER PUMP M5/1; 0.5-1.0 MM2 MCP2.8	NB
904	A 211 545 13 28	HOUSING WASHER NOZZLE HOSE HEATING R2/11; 2-PIN MLK1.2	1
905	A 000 982 30 26	CRIMP CONNECTOR CONTACT WASHER NOZZLE HOSE HEATING R2/11; 0.75-1.0 MM2 MLK1.2S	NB

Copyright 2019-03-03 Daimler AG