

MODEL 221.0 /1 except CODE (487) Active Body Control (ABC)

MODEL 216.3 except CODE (487) Active Body Control (ABC)
with 4MATIC

- 2 Lines
- 2a Brackets
- 10 Stabilizer bar
- 10a Rubber bushing
- 17 Spring control arm
- 21b Retaining clip
- 21e Bolts
- 23 Link rod
- 23c Nut
- 40 Suspension strut

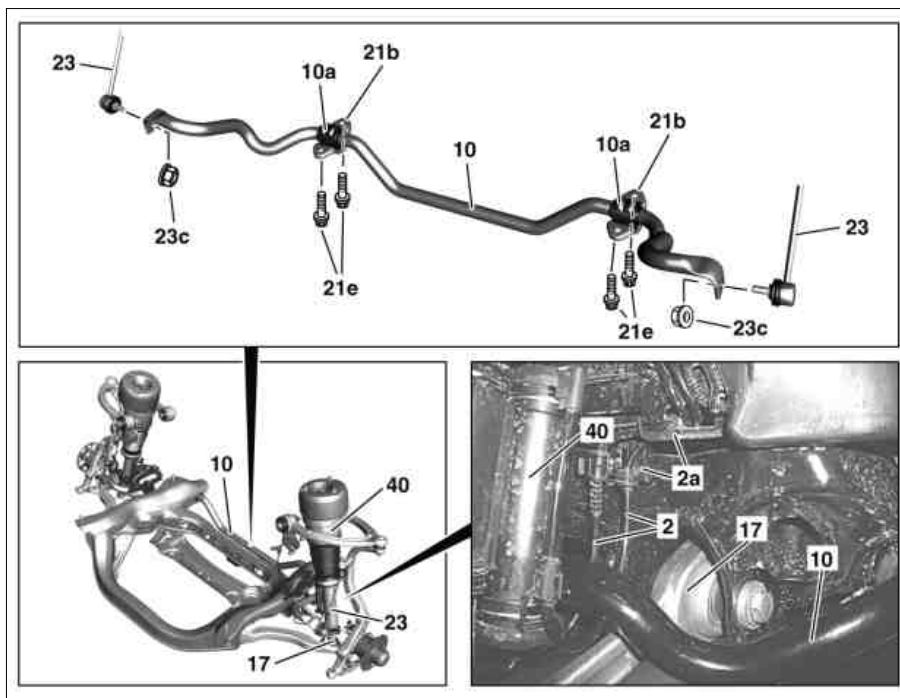

P32.20-2173-06

Modification notes

12.3.08	Value changed: Nut, link rod to stabilizer bar	*BA32.20-P-1001-02O
---------	--	-------------------------------------

	Remove/install		
	Notes on self-locking nuts and bolts		AH00.00-N-0001-01A
	When working on the front-end assembly, be careful not to scratch, mark or notch the surfaces of aluminum parts. Otherwise the service life of the parts will be affected		
	Notes on AIRmatic		AH32.22-P-1000-02SX
	Installation Only tighten nuts and bolts of chassis components when vehicle is in a ready-to-drive condition.		
1 AP	Remove front wheels Remove/install wheels		AP40.10-P-4050SX
2	Remove bottom engine compartment paneling	Vehicles with top protection, code Z07 Vehicles without top protection	AR61.20-P-1105SXS AR61.20-P-1105SX
3	Completely discharge all pressure in the front suspension struts (40) using STAR DIAGNOSIS		
4	Unscrew nuts (23c) of link rods (23) to stabilizer bar (10) and press link rods (23) out of stabilizer bar (10)	Check rubber boots of link rods (23) for signs of damage; fit new link rods (23) if necessary. 	*BA32.20-P-1001-02O
5	Remove bolts (21e) and remove retaining bracket (21b)		*BA32.20-P-1003-02O
6	Unclip lines (2) from brackets (2a)		
7	Detach left or right suspension strut (40) from spring control arm (17)	Vehicles with top protection, code Z07 Vehicles without 4-MATIC and without maximum protection Vehicles with 4-MATIC	AR32.25-P-1017SXS AR32.25-P-1017SX AR32.25-P-1017SYZ
8	Detach left or right spring control arm (17) from front axle carrier	Vehicles with top protection, code Z07	AR33.15-P-0170SXS
9	Remove stabilizer bar (10) toward rear	Check rubber mount (10a) of stabilizer bar (10) for damage and wear, replace stabilizer bar (10) if necessary.	

		i The rubber mounts (10a) are molded onto the stabilizer bar (10).	
10	Install in the reverse order		

Nm Front axle stabilizer bar

Number	Designation		Model 216	Model 221
BA32.20-P-1001-02O	Nut, link rod to stabilizer bar	Nm	90	90
BA32.20-P-1003-02O	Bolt, torsion bar to front axle carrier	Nm	50	50