

P46.10-2711-09

- | | | | | | |
|----|-------------------|-----|---------------|-------|-------------------------------|
| 1 | Steering coupling | 7 | Jacket tube | 36s | Screw |
| 4 | Air ducting | 12 | Screw | M20/1 | Steering column in/out motor |
| 4s | Screw | 35 | Heat shield | M20/2 | Steering column up/down motor |
| 5 | Socket | 35s | Bolts | | |
| | | 36 | Locking plate | | |

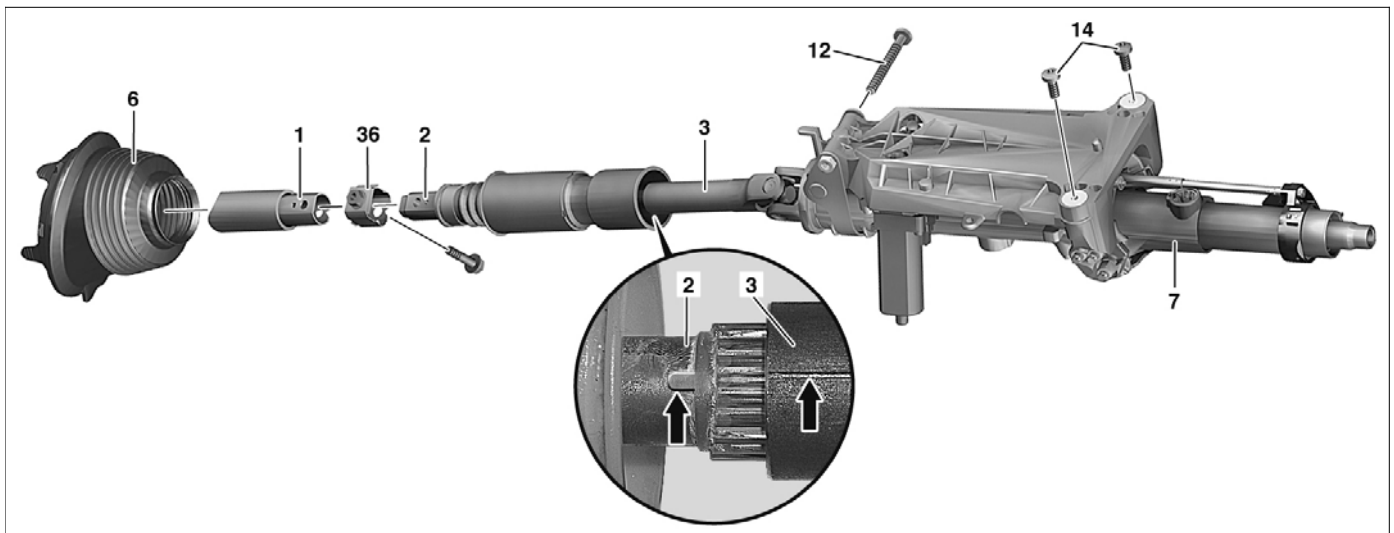

P46.10-2710-08

- | | | | | | |
|---|----------------------|----|-------------|----|---------------|
| 1 | Steering coupling | 6 | Rubber boot | 14 | Bolts |
| 2 | Lower steering shaft | 7 | Jacket tube | 36 | Locking plate |
| 3 | Upper steering shaft | 12 | Screw | | |

Modification notes

13.5.09	Changed connector assignment on steering column adjustment motor	Model 221 up to chassis number 133758	BT46.10-P-0625-01SX
---------	--	---------------------------------------	---------------------

	Remove/install		
	Risk of death caused by vehicle slipping or toppling off of the lifting platform.	Align vehicle between columns of vehicle lift and position four support plates at vehicle lift support points specified by vehicle manufacturer.	AS00.00-Z-0010-01A
	Notes on self-locking nuts and bolts		AH00.00-N-0001-01A
1	Remove rear section of lower engine compartment paneling		

2	Remove bolts (35s) and remove heat shield (35).		
3	Remove bolt (36s) of steering coupling (1) on lower steering shaft (2)	Nm	*BA46.10-P-1001-01L
4	Pull lower steering shaft (2) upwards out of steering coupling (1)	<p>⚠ Do not use force (hammer blows, a lot of leverage) as the lower steering shaft (2) is sensitive to the effects of side force.</p> <p>i Installation: Rotate the rack-and-pinion steering into the center position.</p>	AR46.20-P-0600-01SX
5	Detach locking plate (36) from steering coupling (1)	i Installation: Replace locking plate (36) with self-locking nut.	
6	Remove steering wheel		AR46.10-P-0100SX
7	Remove steering column switch module		AR54.25-P-2800-01SX
8	Remove instrument cluster		AR54.30-P-6015SX
9	Remove left cover below dashboard		AR68.10-P-1500SX
10	Remove brake pedal cover		
11	Remove bolt (4s) and remove air ducting (4)		
12	Remove accelerator pedal		AR30.12-P-1321SX
13	Unclip bushing (5) of steering column switch module on steering column tube (7)		
14	<p> BT</p> <p>Detach electrical connectors to motors (M20/1, M20/2) Changed connector assignment on steering column adjustment motor</p>	<p>Model 221 up to chassis number 133758</p> <p>Only when replacing the steering column tube or steering column adjustment motor</p>	BT46.10-P-0625-01SX
15	Detach cable ties (4 each) from steering column tube (7)		
16	Remove screw (12)	Nm	*BA46.10-P-1001-03P
17	Remove bolt (14)	<p>i Installation: Tighten bolts (12, 14) finger-tight. The steering column tube (7) must remain movable. First tighten the upper screws (14) and then the lower screw (12).</p> <p>Nm</p>	*BA46.10-P-1002-03P
18	Detach lower steering shaft (2) from upper steering shaft (3)	i Installation: Run lower steering shaft (2) into upper steering shaft (3); in doing so the markings (see arrows in picture 2) must line up.	
19	Slide steering column tube (7) with upper steering shaft (3) downwards and remove through footwell	<p>⚠ The steering column tube (7) must not be removed at the motors (M20/1, M20/2), as otherwise these may be damaged.</p> <p>i Installation: Check rubber boot (6) is correctly seated in bulkhead.</p>	
20	Install in the reverse order		

Steering shaft

Number	Designation		Model 216	Model 221
BA46.10-P-1001-01L	Self-locking bolt, steering coupling to steering shaft	Nm	30	30

Jacket tube

Number	Designation		Model 216	Model 221
BA46.10-P-1001-03P	Lower bolt, jacket tube to cross member below instrument panel	Nm	20	20
BA46.10-P-1002-03P	Upper bolt, jacket tube to cross member below instrument panel	Nm	20	20