

Model 205, 213, 217, 222, 238, 253

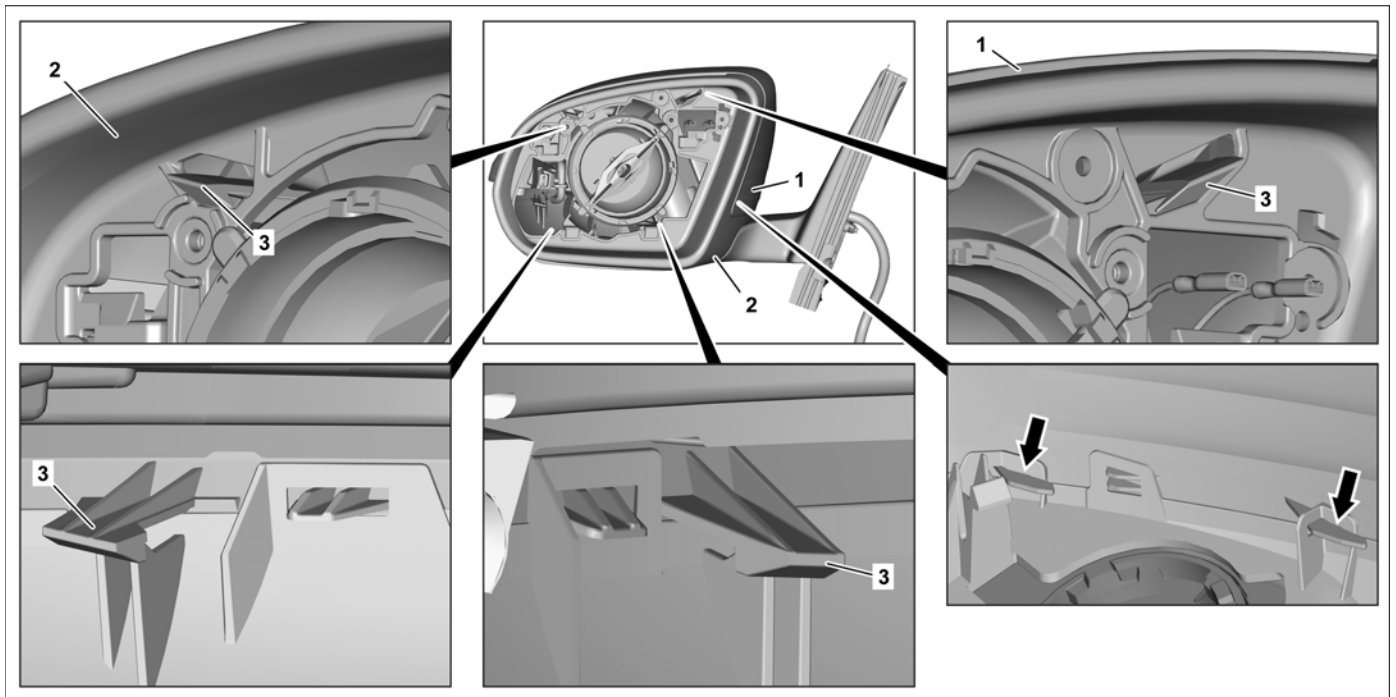

P88.70-2689-09

Shown on left outside mirror, model 222

- 1 Outside mirror trim
- 2 Outside mirror housing
- 3 Catch hook

Shown on left outside mirror, model 222

- 1 Outside mirror trim
- 2 Outside mirror housing

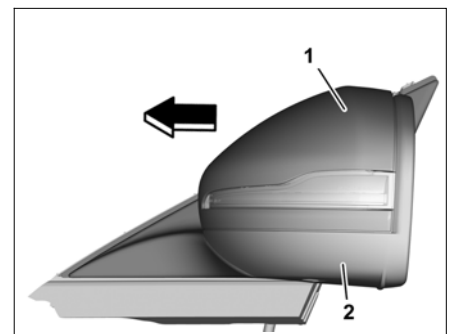

P88.70-2690-01

☒ ☒	Remove/install		
1	Remove mirror glass		AR88.70-P-9020LF
2	Release catch hooks (3) and remove outside mirror paneling (1) from outside mirror housing (2) toward front	<div style="border: 1px solid black; padding: 2px; display: inline-block;"> i Installation: Move guides (arrows) on outside mirror paneling (1) at inside into outside mirror housing (2). </div>	
3	Install in the reverse order		