

Model 222
except code Z07 (Top protection)

Modification notes

10.9.15	Specifications on calibrating 360° camera revised.	Operation step 7	
10.9.15	"Check outside mirror for proper function" added.	Operation step 8	

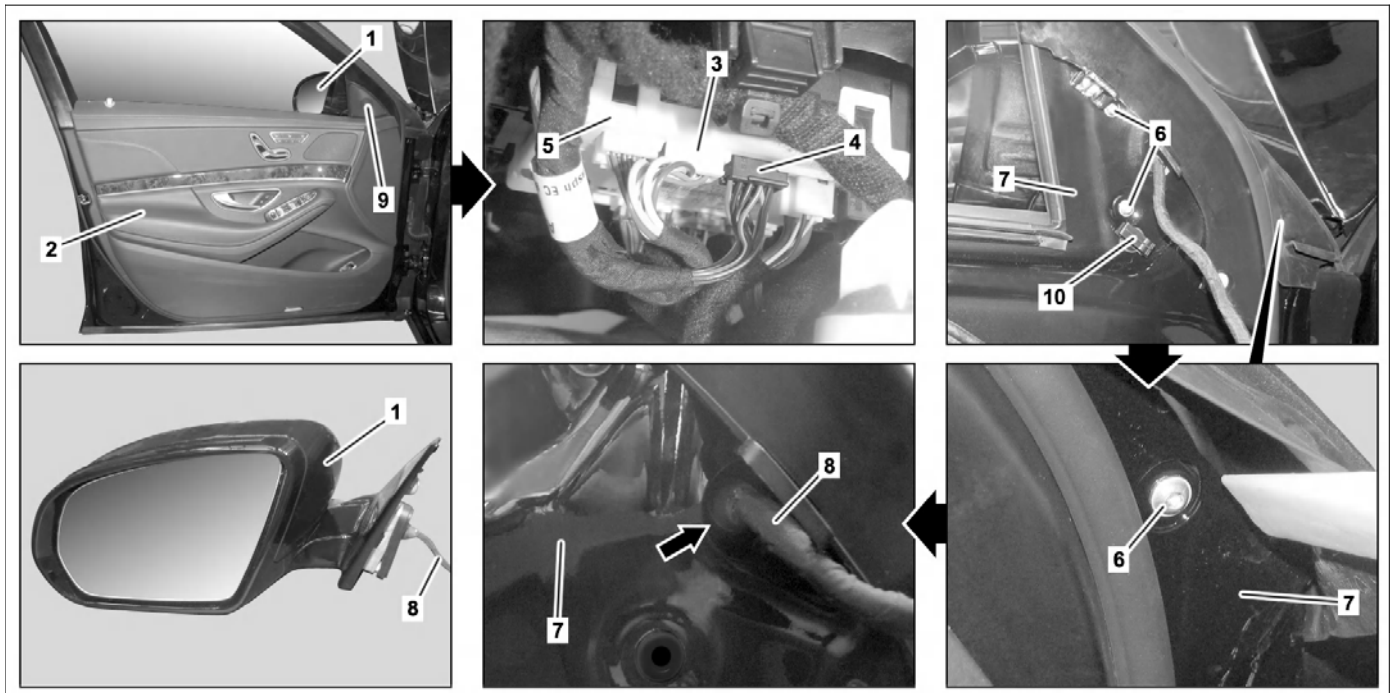

P88.70-2677-09

Shown on left side of vehicle

- | | | | | | |
|---|---------------------------|---|---------------------------|----|-----------------|
| 1 | Exterior rearview mirrors | 5 | Front door control unit | 9 | Mirror triangle |
| 2 | Door trim | 6 | Bolts | 10 | Bracket |
| 3 | Electrical connector | 7 | Front door | | |
| 4 | Electrical connector | 8 | Electrical wiring harness | | |

ⓘ	Information on preventing damage to electronic components due to electrostatic discharge		AH54.00-P-0001-01A
⊗ ⊗	Remove/install		
1	Remove mirror triangle (9) on left and right front door (7)	☑ Mounting wedge	*110589035900
2	Remove door trim (2) from front door (7)		AR72.10-P-1000LF
3	Disconnect electrical connectors (3, 4) from front door control unit (5)		
4	Unscrew bolts (6) and remove outside mirror (1) from front door (7)		
5	Unclip electrical wiring harness (8) from bracket (10) and guide through passage (arrow)		
6	Install in the reverse order		
7.1	Calibrate 360° camera on left or right outside mirror (1) with diagnostic system	Model 222 with code 501 (360° camera) except code Z07 (Top protection) If the left or right outside mirror (1) has been removed.	AD00.00-P-2000-04B
AD			

7.2	Calibrate all the cameras for the 360° camera system using the diagnostic system	Model 222 with code 501 (360° camera) except code Z07 (Top protection) If the left or right outside mirror (1) has been removed.	
AD			AD00.00-P-2000-04B
8	Check		
8	Check outside mirror (1) for proper function		

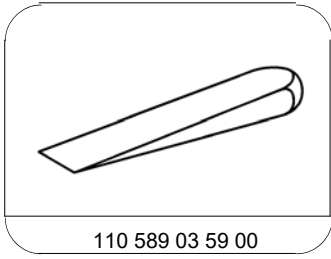

110 589 03 59 00

Mounting wedge