

Model 217 with engine 157, 176, 177, 276, 278, 279

Model 222 with engine 157, 176, 177, 256, 264, 276, 277, 278, 279

Modification notes

20.12.2018	Method description adapted	Operation step 1	
------------	----------------------------	------------------	--

Shown except CODE 494 (USA version)

- 1 Activated charcoal canister
- 2 Line
- 3 Hose
- 4 Retaining clips
- 5 Retaining lug

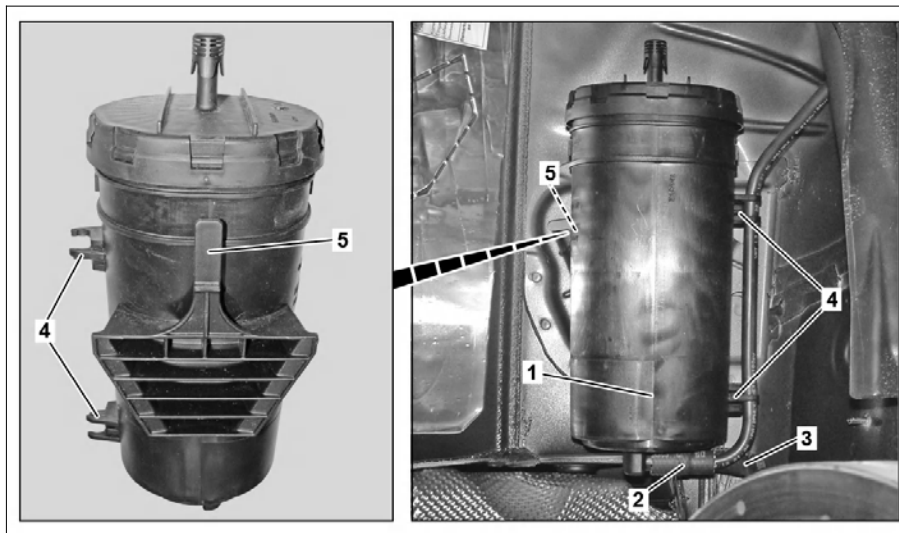

P47.30-2261-05

Shown on model 222 with engine 264

- 1 Activated charcoal canister
- 3 Hose
- 5 Retaining lug
- 6 Snap clamp
- 7 Plug-in connector
- 8 Electrical connector

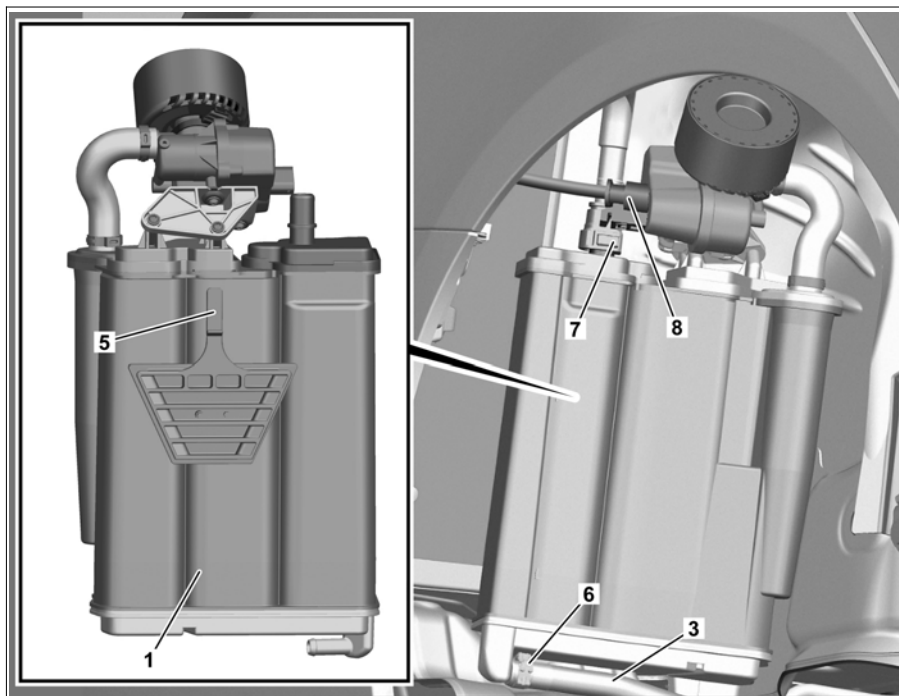

P47.30-A006-06

	Risk of explosion caused by fuel igniting, risk of poisoning caused by inhaling and swallowing fuel as well as risk of injury to eyes and skin caused by contact with fuel.	No fires, sparks, open flames or smoking. Pour fuels into suitable and appropriately marked containers only. Wear protective clothing when handling fuel.	AS47.00-Z-0001-01A
	Notes on avoiding damage through contamination and foreign objects		AH00.00-P-5000-01A
	Information on preventing damage to electronic components due to electrostatic discharge		AH54.00-P-0001-01A
	Remove/install		
1	Remove right rear wheel.		AR40.10-P-1102A

2	Remove fender liner in right rear fender.	Model 217 with engine 157, 176, 177, 276, 278, 279 Model 222 with engine 157, 176, 177, 256, 264, 276, 277, 278, 279	AR88.10-P-1400LC AR88.10-P-1400LF
3	Disconnect electrical connector (8).	Model 222 with engine 264	
4	Release click clamp (6).	Model 222 with engine 264 i Installation: Replace snap clamp (6). S Pliers for click clamps	*171589003700
5	Detach hose (3) from activated charcoal canister (1) and seal openings with suitable stop plugs.	S Record plug	*129589009100
6.1	Unclip line (2) from retaining clips (4), detach from activated charcoal canister (1), and seal openings with suitable stop plugs.	Model 217 with engine 157, 176, 177, 276, 278, 279 Model 222 with engine 157, 176, 177, 276, 277, 278, 279 Model 222 with engine 256 except code 494 (US version) S Record plug	*129589009100
6.2	Disconnect electrical connector for leak tightness diagnostic device, detach vent line from activated charcoal canister (1), and seal openings with suitable stop plugs.	Model 222 with engine 176, 177, 256 with code 494 (US version) S Record plug	*129589009100
7	Release securing lug (5) and push activated charcoal canister (1) upwards.	i Installation: Ensure that activated charcoal canister (1) is seated correctly.	
8	Remove activated charcoal canister (1) in downward direction.		
9	Install in the reverse order.		

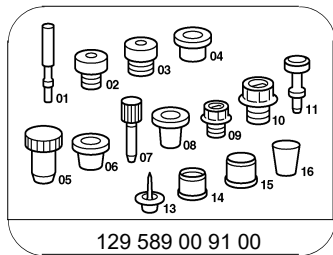

129 589 00 91 00

Record plug

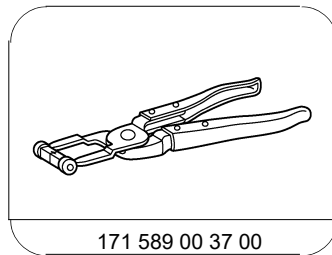

171 589 00 37 00

Pliers for click clamps