

MODEL 222.0/1/9

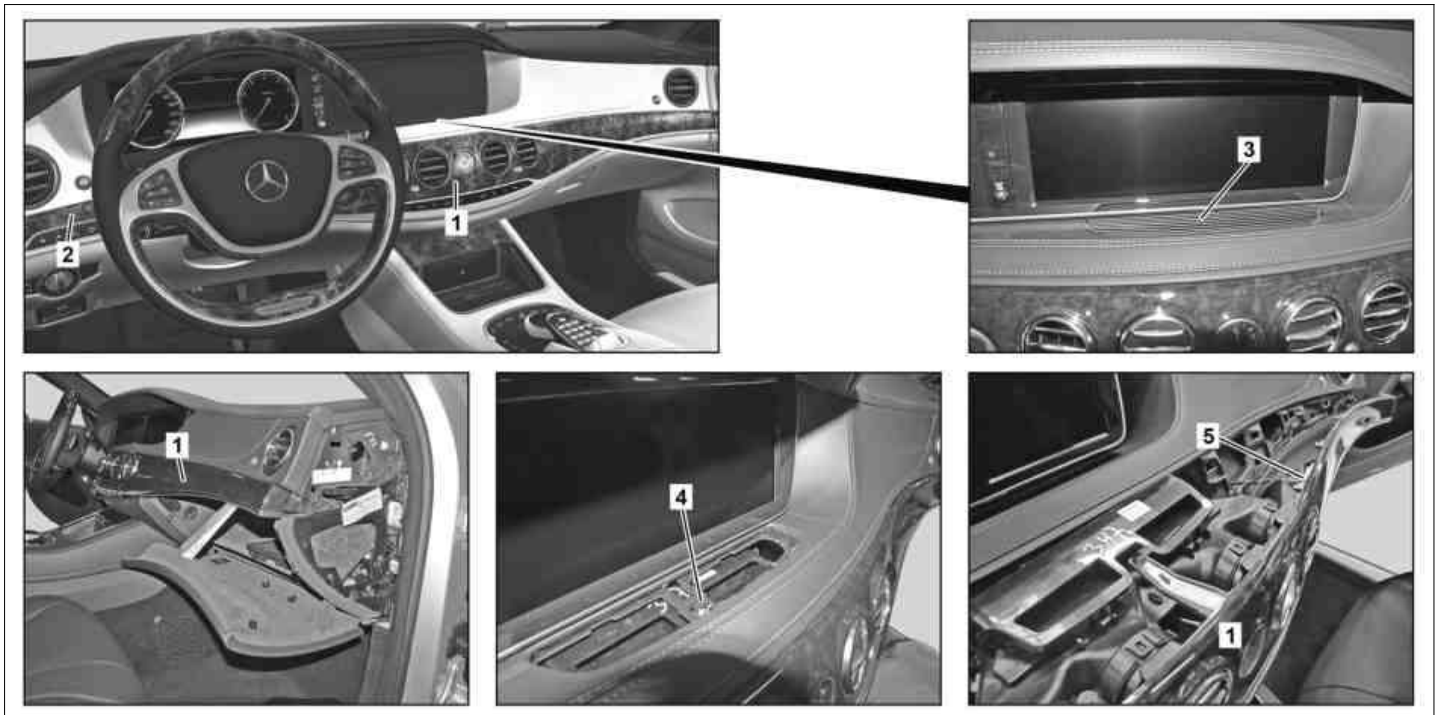

P68.10-4602-09

Instrument panel trim piece

- | | | | |
|---|-----------------------------|---|----------------------|
| 1 | Instrument panel trim piece | 4 | Catch hook |
| 2 | Driver side trim piece | 5 | Electrical connector |
| 3 | Cover grill | | |

Driver side trim piece

- | | |
|---|------------------------|
| 2 | Driver side trim piece |
| 6 | Electrical connector |

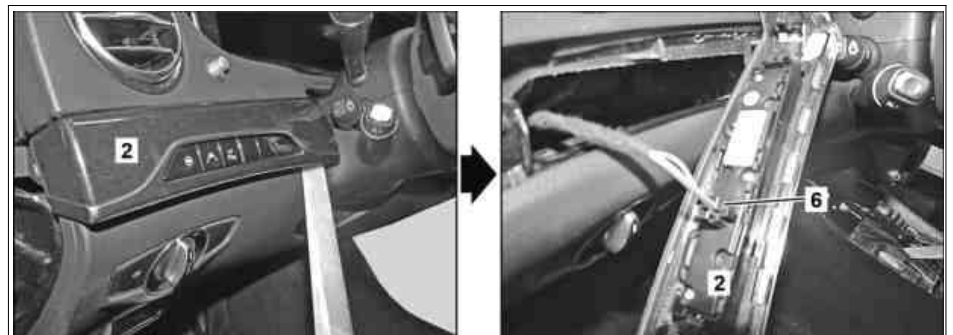

P68.10-4603-04

	Information on preventing damage to electronic components due to electrostatic discharge		AH54.00-P-0001-01A
	Remove/install		
1	Switch off ignition and remove transmitter key		
	Remove instrument panel trim piece (1)		
2	Open glove compartment and unclip side cover on instrument panel on passenger side	<input checked="" type="checkbox"/> Mounting wedge	*110589035900
3	Unclip cover grill (3) in front of central display	<input checked="" type="checkbox"/> Mounting wedge	*110589035900
4	Open stowage compartment and remove bolt head covers		

5	Unscrew bolts and lay stowage compartment down on center console with lines connected	⚠ Cover center console with a rag. To prevent damaging center console.	
6	Unclip instrument panel trim piece (1)	i Start unclipping in area of glove compartment. S Mounting wedge	*110589035900
7	Press catch hook (4) downward and remove instrument panel trim piece (1)	i The trim ring on the ignition lock loosens when removing the instrument panel trim piece (1).	
8	Disconnect electrical connector from front air conditioning system operating unit		
9	Disconnect electrical connector (5) and remove instrument panel trim piece (1)		
10	Transfer air conditioning operating unit, instrument panel optical fiber, center air vent potentiometer, center air vents and analog clock	When replacing instrument panel trim piece (1)	
	Remove driver side trim piece (2)		
11	Extend steering wheel		
12	Unclip driver side trim piece (2)	S Mounting wedge	*110589035900
13	Push driver side trim piece (2) toward outside	i The driver side trim piece (2) is hooked into the instrument panel (1).	
14	Disconnect electrical connector (6) and remove driver side trim piece(2)		
15	Transfer drive assistance system switch group	When replacing driver side trim piece (2)	
16	Install in the reverse order		

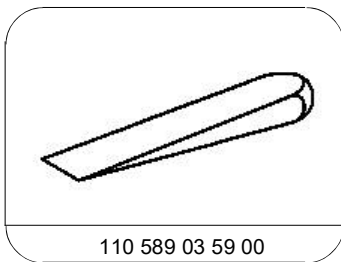

110 589 03 59 00

Mounting wedge