

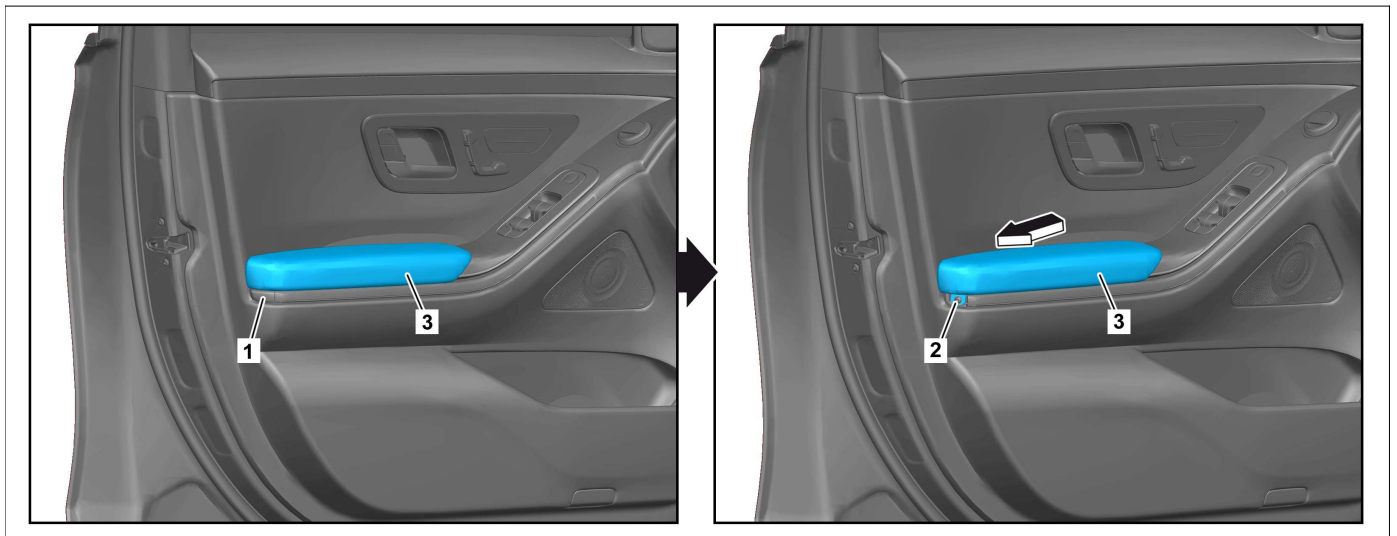

Model 223
 except code Z07 (B7 armoring on special protection version)



P72.10-A065-78

- 1 Trim strip
- 2 Screw

- 3 Armrest

 	Remove/install		
1	Unclip trim strip (1).	<input checked="" type="checkbox"/> Long wedge	*115589035900
2	Remove screw (2).		
3	Remove armrest (3) at an incline towards rear (arrow).		
4	Disconnect electrical connection.	Model 223 with code 906 (Front armrest heater) except code Z07 (B7 armoring on special protection version)	
5	Install in the reverse order.		

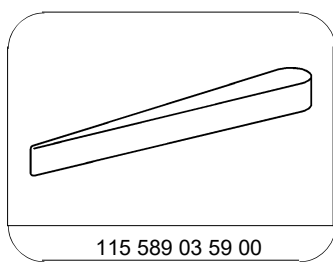

Long wedge