

- Picture -

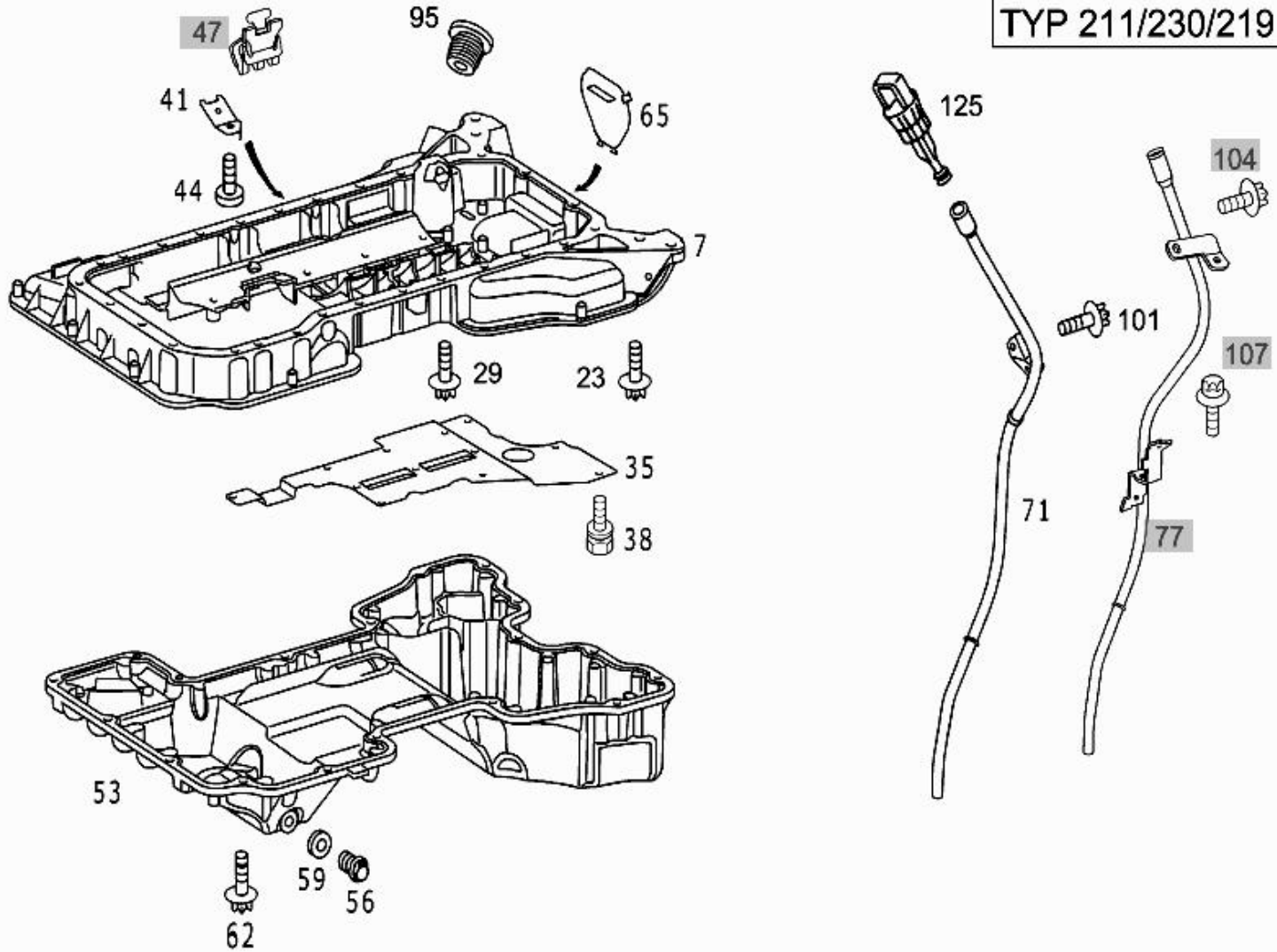

Mode	MD mode	Mod. des. overview	SL ROADSTER
FIN/MD	WDB 2304741F033520	Catalog	07F
VIN	WDBSK74FX3F033520	Major assembly:	M - Engine
Sales designation	SL 55 AMG	Major assembly MD	113992 60 005048
Assortment class	Car	Group	01 - ENGINE HOUSING
Market	North America	Subgroup	045 - OIL PAN
OIL LEVEL DISPLAY		Picture number	B01045000237.120118



- Parts list -

Mode	MD mode	Mod. des. overview	SL ROADSTER
FIN/MD	WDB 2304741F033520	Catalog	07F
VIN	WDBSK74FX3F033520	Major assembly:	M - Engine
Sales designation	SL 55 AMG	Major assembly MD	113992 60 005048
Assortment class	Car	Group	01 - ENGINE HOUSING
Market	North America	Subgroup	045 - OIL PAN

OIL LEVEL DISPLAY

Item no.	Part number	Designation/description	Quantity	Version
7	A 113 014 18 02	OIL PAN UPPER PART	001	
23	N 910143 008003	HEXALOBULAR BOLT OIL PAN TO CYLINDER CRANKCASE M8X30	002	
29	N 910143 006002	HEXALOBULAR BOLT OIL PAN TO CYLINDER CRANKCASE M 6X20	016	
29	N 910143 006006	HEXALOBULAR BOLT OIL PAN TO CYLINDER CRANKCASE M 6X40	004	
29	N 910143 006010	HEXALOBULAR BOLT OIL SUMP ON CRANKCASE COVER, REAR M 6X90	002	
29	N 910143 006002	HEXALOBULAR BOLT OIL PAN TO TIMING CASE M 6X20	004	
29	N 910143 006006	HEXALOBULAR BOLT OIL PAN TO TIMING CASE M 6X40	002	
----	N 910143 008003	HEXALOBULAR BOLT OIL PAN TO TIMING CASE M8X30  [403] NOT USED	002	
35	A 113 014 05 66	OIL BAFFLE	001	
38	N 304017 006016	HEXAGON HEAD BOLT OIL BAFELE TO OIL PAN	012	
41	A 113 131 00 41	BRACKET OIL PAN UPPER PART	001	
44	A 003 990 17 12	SCREW BRACKET TO OIL PAN	001	
53	A 113 010 10 28	OIL PAN LOWER PART	001	
56	A 000 990 53 17	. SCREW OIL DRAIN  [031] BOTH OIL DRAIN PLUGS MUST BE REPLACED AFTER AN OIL CHANGE	002	
59	N 007603 014106	. SEALING RING OIL DRAIN	002	
62	N 000000 001117	HEXALOBULAR BOLT LOWER PART OF OIL PAN TO UPPER PART	018	
65	A 112 014 01 33	COVER MOUNTING HOLE IN OIL PAN	001	
71	A 113 010 06 66	GUIDE TUBE	001	
95	A 112 018 00 80	GASKET GUIDE TUBE	001	
101	N 000000 001114	HEXALOBULAR BOLT OIL PIPE TO CYLINDER HEAD M 6X15	001	
125	A 646 010 00 35	COVER	001	