

AR68.30-P-7440R

Remove/install rear luggage box

29.6.01

MODEL 230.474 /475 /476 up to 14.1.04

Shown on vehicles with code (819) CD changer

- 1 Luggage box
- 2 Cover
- 3 Bolts
- 4 Guides
- 5 Pin
- 6 Wiring harness
- 7 Vacuum line

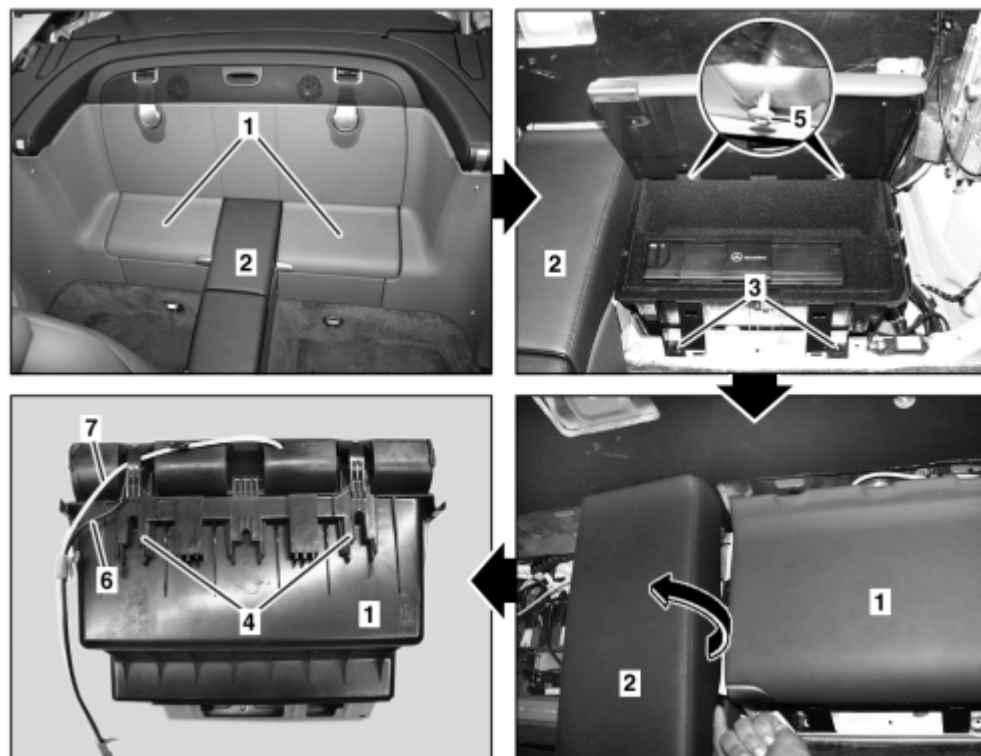

P68.30-2417-06

	Remove/Install		
1	Remove rear wall paneling		AR68.30-P-4750R
2	Unscrew screws (3) at luggage box (1)		
3	Raise side cover (2) slightly (arrow), remove luggage box (1) together with guides (4) out of bolts (5) upward and lay down to side with lines connected.	<p>i Do not damage cover (2) because it is still screwed in the front area.</p> <p>i Installation: Ensure that guides (4)</p>	

		are seated correctly above bolts (5).	
4	Separate connector from wiring harness (6)		
5	Cut off vacuum line (7) below luggage box (1)	i Installation: Connect separated vacuum line (7) with suitable vacuum hose	
6	Take out luggage box (1)	i On vehicles with code (819) CD changer, remove CD player with changer when replacing luggage box (1). See ↓	
		Remove/install CD player with changer	AR82.64-P-7507R
7.1	Remove luggage box cover (1) in rear	Only if necessary.	AR68.30-P-7440-01R
8	Install in the reverse order		