

Unlocking the trunk

If you are unable to unlock the trunk with the key, open the trunk with the mechanical key as follows:

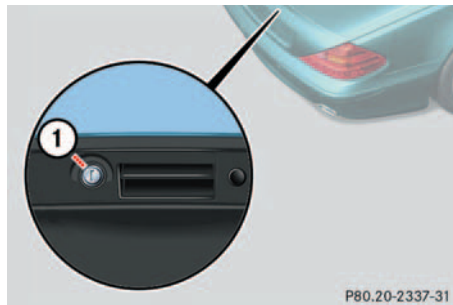

P80.20-2337-31

Trunk lid lock

1 Unlocking

- ▶ Insert the mechanical key into the trunk lid lock.
- ▶ Perform the following two steps simultaneously:
 - ▶ Turn the key counterclockwise to position **1**.
 - ▶ Pull the trunk lid handle and lift lid.

Unlocking interior storage compartments

Locking storage areas in the passenger compartment include:

- the glove box
- the storage space under the armrest
- the rear storage compartments

If these cannot be unlocked by means of the key, the KEYLESS-GO* card or the central locking button, use the mechanical key to open the glove box.



The storage space under the armrest and the rear storage compartments can only be unlocked using the mechanical key at the glove box lock.

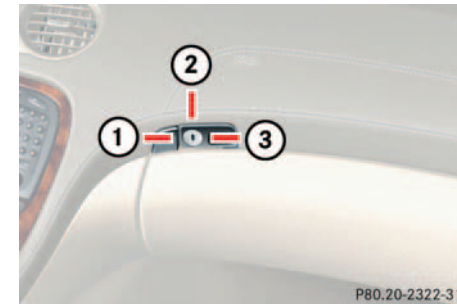

P80.20-2322-31

1 Separately unlock storage compartments

2 Centrally lock/unlock storage compartments

3 Separately lock storage compartments

- ▶ Slide mechanical key out of key housing (▷ page 290).
- ▶ Insert the mechanical key into the glove box lock and turn it to position **2**. All storage compartments are now unlocked.