

MODEL 230.4

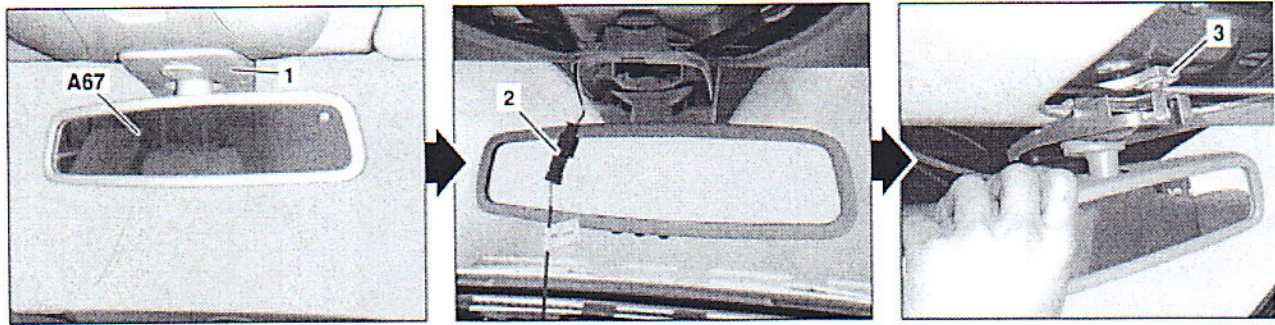

P68.40

1 Cover

2 Electrical connector (with code (386) Preinstallation for telephone "Handy", UPCI system or code (388) Telephone "Handy", UPCI system)

3 Retaining plate

A67 Inside rearview mirror unit

☒ ☒	Remove/install		
1	Remove overhead control panel control unit		AR82.20-P-10C
2	Unclip covering (1)		
3.1	Disconnect electrical connector (2)	On vehicles with code (386) Preinstallation for telephone "Handy", UPCI system or code (388) Telephone "Handy", UPCI system	
4	Take off cover (1)		
5	Pry off inside rearview mirror unit (A67) of retaining plate (3) with suitable prying tool.	i Insert prying tool between inside rearview mirror unit (A67) and retaining plate (3).	
6	Remove inside rearview mirror unit (A67)		
7	Install in the reverse order		





MODEL 230.4

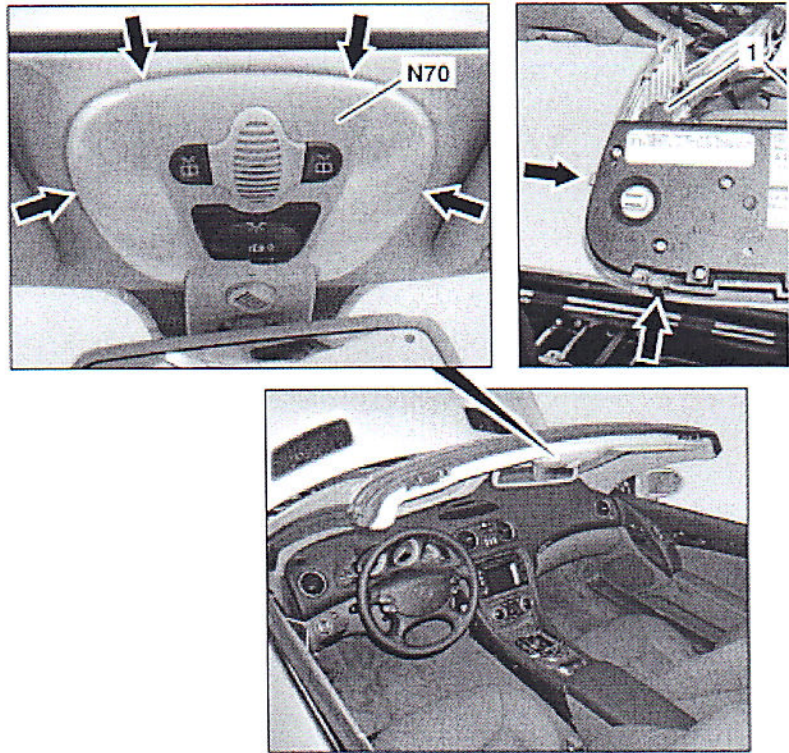

1 Electrical connectors

N70 Overhead control panel control unit



Modification notes

18.10.05	Disconnect ground line of battery replaced by switch off ignition	Step 2	
 	Remove/install		
1.1	Buffer basic data for overhead control panel control unit (N70) in STAR DIAGNOSIS	When replacing the overhead control panel control unit (N70).	
		 Installation: Transfer buffered basic data to the new overhead control panel control unit (N70).	
 AD	Connect STAR DIAGNOSIS and read out fault memory		AD00
		STAR DIAGNOSIS diagnosis system	WE5:
2	Switch off the ignition and remove the transmitter key from the EIS control unit	 On vehicles with code (889) Keyless Go, press the Keyless Go start/stop button repeatedly until the ignition is switched off. Remove the Keyless Go transmitter	

		card or transmitter key from the vehicle and store beyond the reach of the transmitter (min. 2 m).	
3	Unclip overhead control panel control unit (N70) at retaining clamps (arrows)	 Carefully unclip overhead control panel control unit (N70), otherwise this can damage the housing of the overhead control panel control unit (N70).	
			110.5
4	Separate electrical connectors (1)		
5	Remove the overhead control panel control unit (N70)		
6	Install in the reverse order		

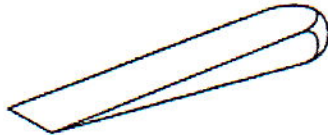

110 589 03 59 00

Mounting wedge

Workshop equipment/MB testers (see Workshop Equipment Manual)

WE58.40-Z-1013-06A	STAR DIAGNOSIS Compact diagnosis system for passenger cars, order number 6511 1.
--------------------	--