

- Picture -

Mode	MD mode	Mod. des. overview	SL ROADSTER
FIN/MD	WDB 2304751F013880	Catalog	65P
VIN	WDBSK75F83F013880	Major assembly:	
Sales designation	SL 500	Major assembly MD	
Assortment class	Car	Group	88 - ATTACHMENT PARTS
Market	North America	Subgroup	120 - ENGINE HOOD
Picture number	B88120000158.140707		

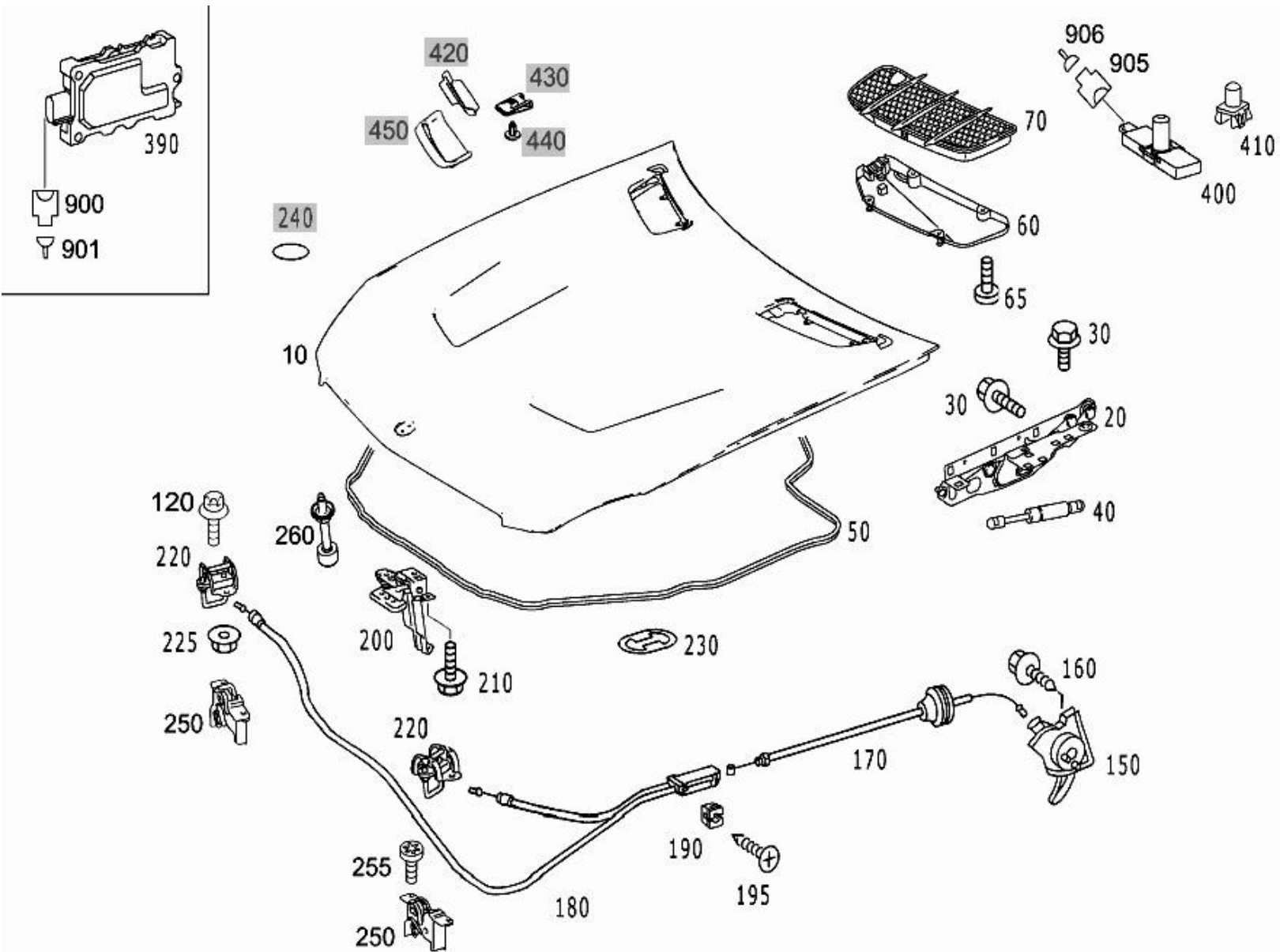

- Parts list -

Mode	MD mode	Mod. des. overview	SL ROADSTER
FIN/MD	WDB 2304751F013880	Catalog	65P
VIN	WDBSK75F83F013880	Major assembly:	
Sales designation	SL 500	Major assembly MD	
Assortment class	Car	Group	88 - ATTACHMENT PARTS
Market	North America	Subgroup	120 - ENGINE HOOD

Item no.	Part number	Designation/description	Quantity	Version
10	A 230 880 00 57	ENGINE HOOD Replaced by: A 230 880 03 57 +001 A 230 682 05 26 <input type="checkbox"/> [002, 044] To Chassis: F 145965 To Date: 31/03/2008 ...	001	
10	A 230 880 03 57	ENGINE HOOD <input type="checkbox"/> [002, 045] To Chassis: F 145965 To Date: 31/03/2008 ...	001	
20	A 230 880 01 28	HINGE LEFT Code: -P99	001	
20	A 230 880 02 28	HINGE RIGHT Code: -P99	001	
30	A 011 990 32 01	BOLT HINGE TO BODY M6X14 Code: -P99	008	
30	A 011 990 32 01	BOLT HINGE TO ENGINE HOOD M6X14 Code: -P99	006	
40	A 230 880 00 29	SPRING HINGE TO ENGINE HOOD <input type="checkbox"/> [002] To Chassis: F 145965 To Date: 31/03/2008 Excep...	002	
50	A 230 889 00 98	SEAL ENGINE HOOD Code: -P99	001	
60	A 230 830 01 52	COVER LEFT	001	L
60	A 230 830 01 21	CONNECTOR RIGHT	001	L
65	A 001 984 65 29	. HEX. ROUND SCREWS TO CONNECTING PIECE 5X20	008	
70	A 230 830 11 18	VENTILATION SCREEN LEFT <input type="checkbox"/> [002] To Chassis: F 145965 To Date: 31/03/2008 Excep...	001	
70	A 230 830 12 18	VENTILATION SCREEN RIGHT <input type="checkbox"/> [002] To Chassis: F 145965 To Date: 31/03/2008 Excep...	001	
120	N 000000 003765	HEXALOBULAR BOLT CATCH TO ENGINE HOOD M6X20 Code: -P99	004	
150	A 230 880 01 20	HANDLE	001	L
160	N 000000 001478	HEXALOBULAR BOLT HOOD RELEASE LEVER TO A-PILLAR M6X25	001	
170	A 230 880 01 59	ENGINE HOOD RELEASE CABLE REAR	001	
180	A 230 880 00 59	ENGINE HOOD RELEASE CABLE FRONT Code: -P99	001	
190	A 001 994 76 45	FUSE MOUNTING, BRACKET HOOD RELEASE CABLE COUPLING DEVICE Code: -P99	001	
195	N 000000 004497	SCREW MOUNTING, BRACKET HOOD RELEASE CABLE COUPLING DEVICE 3X10	001	

200	A 230 880 01 64	SAFETY HOOK Code: -P99 ☐ [047] To Chassis: F 138199 To Date: 30/06/2007 Excep...	001
210	N 000000 003765	HEXALOBULAR BOLT SAFETY HOOK TO ENGINE HOOD M6X20 Code: -P99	002
210	N 000000 003765	HEXALOBULAR BOLT CATCH TO ENGINE HOOD M6X20 Code: -P99	004
220	A 230 880 01 60	ENGINE HOOD CATCH AT ENGINE HOOD Code: -P99	002
225	A 000 984 42 21	BLIND CLINCH NUT CATCH TO ENGINE HOOD	004
230	A 220 889 10 95	INTERMEDIATE LAYER HOOD BUFFER CHAFE PROTECTION Code: -P99	002
250	A 230 880 00 60	ENGINE HOOD CATCH LOWER PART Code: -P99	002
255	N 910143 006001	HEXALOBULAR BOLT TO HOOD LOCK M6X16 Code: -P99 ☐ [048] To Chassis: F 144547 To Date: 28/02/2008	004
260	A 000 998 06 44	BUFFER WITH STUD BOLT AT ENGINE HOOD FRONT LEFT AND RIGHT Code: -P99	002
390	A 211 830 04 72	GASEOUS POLLUTANT SENSOR AIR-QUALITY SENSOR IN COVER ENGINE HOOD	001
400	A 211 870 13 10	SENSOR SUNLIGHT SENSOR IN COVER ENGINE HOOD LEFT	001
410	A 211 831 02 44	COVER GRILLE IN ENGINE HOOD RIGHT	001
900	A 220 540 06 81	PIN BUSHING HOUSING POLLUTANT SENSOR 3-PIN MQS;B31	001
901	A 000 540 23 05	ELECTRICAL CABLE POLLUTANT SENSOR 0.5 MM2 MQS;B31 ☐ [016, 043] To Chassis: F 122820 To Date: 30/03/2006 ...	001
905	A 210 540 21 81	CLUTCH SUN SENSOR 3-PIN MQS;B32	001
906	A 000 540 23 05	ELECTRICAL CABLE SUN SENSOR 0.5 MM2 MQS;B32 ☐ [016, 043] To Chassis: F 122820 To Date: 30/03/2006 ...	001