

MODEL 230.4 except CODE (P99) "AMG Black Series" special model

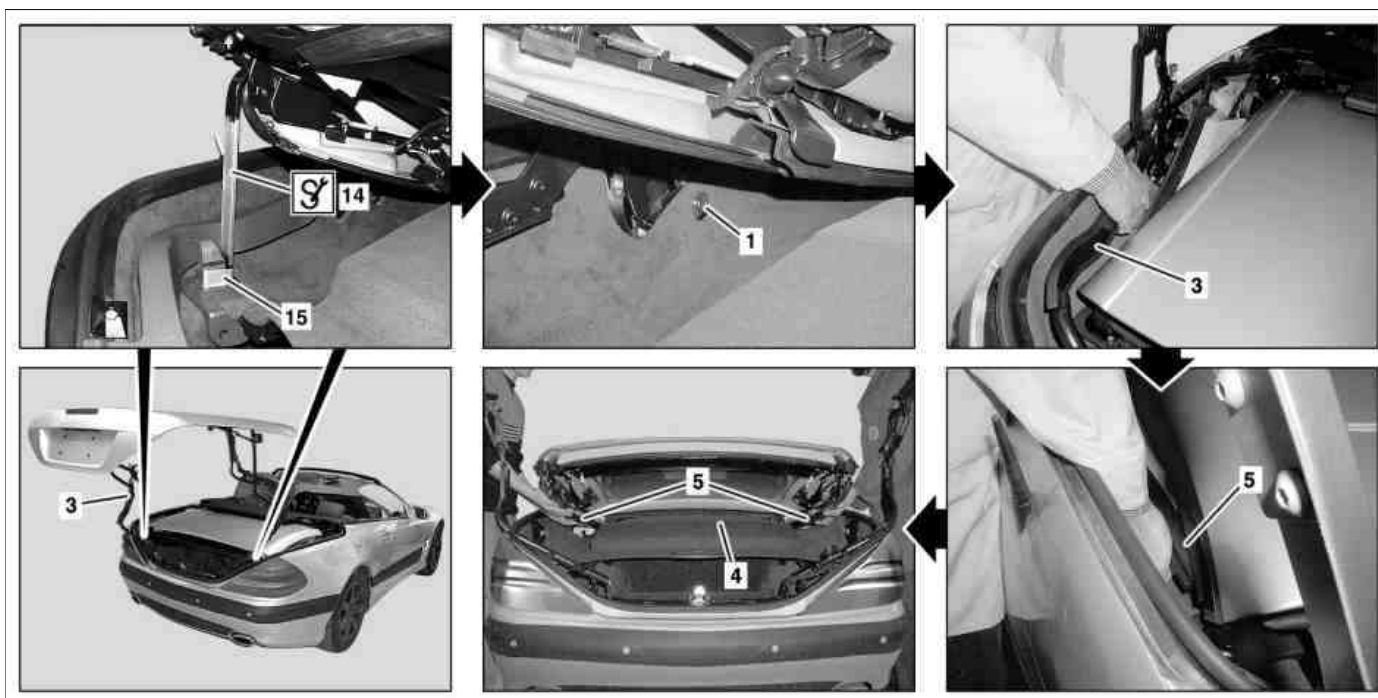

P77.30-2133-09

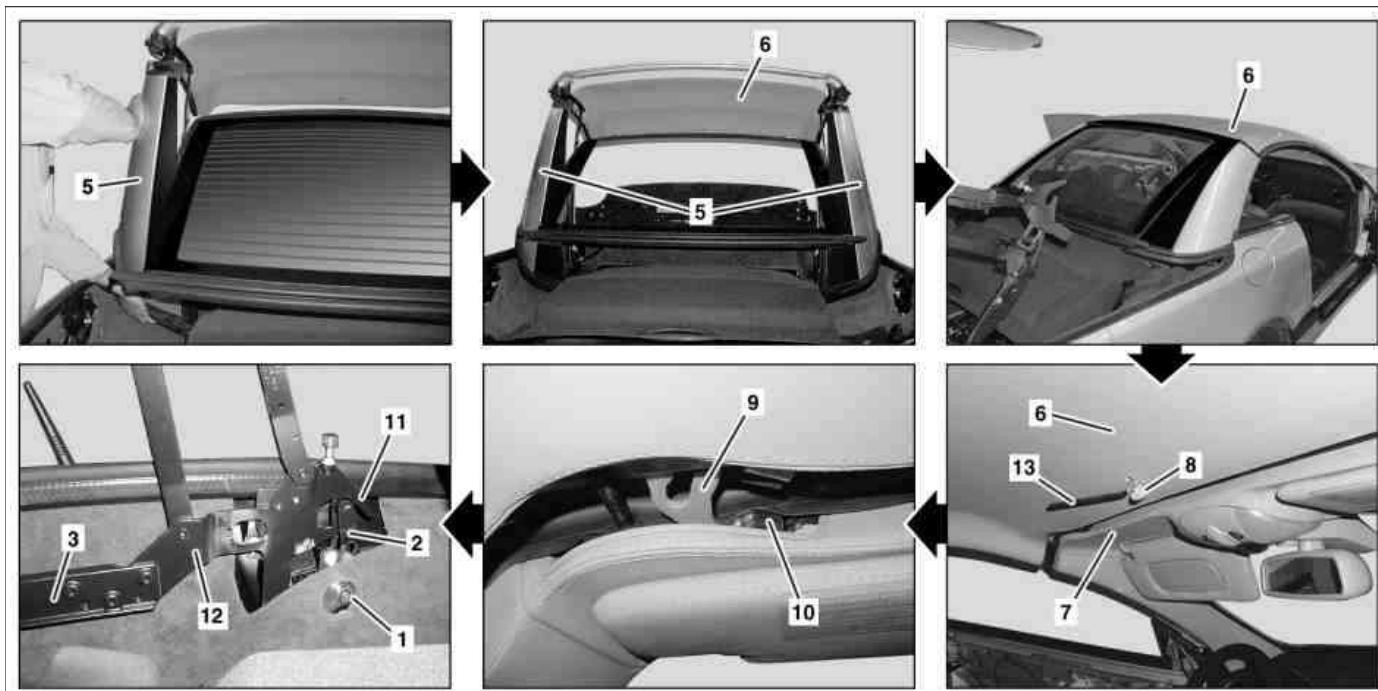

- 1 Screw
- 3 Tubular frame
- 4 Luggage compartment division
- 5 C-pillars
- 14 Support
- 15 Adhesive tape



P77.30-2134-09

- 1 Screw
- 2 Tubular frame lock
- 3 Tubular frame
- 5 C-pillars
- 6 Vario roof front section
- 7 Crossmember above windshield
- 8 Cover
- 9 Lock hook
- 10 Lock mount
- 11 Lock hook
- 12 Hinge bracket
- 13 Hexagon socket wrench

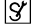
⚠ Danger!	<p>Risk of injury caused by moving parts that can pinch, crush or, in extreme cases, even sever extremities</p>	<p>No parts of the body or limbs should be within the operating range of the mechanism when moving components.</p>	<p>AS00.00-Z-0009-01A</p>
1	<p>Switch on ignition and completely lay down roll bar with roll bar switch.</p>	<p>i If the roll bar cannot be put down, lower mechanically. Refer to: ↓ Lower and raise roll bar mechanically</p>	<p>AR91.50-P-8400R</p>

2	Switch off the ignition and remove the transmitter key from the EIS [EZS] control unit	i On vehicles with code (889) Keyless-Go, press KEYLESS-GO start/stop button repeatedly until ignition is switched off. Remove the Keyless Go chipcard or transmitter key from vehicle and store beyond reach of the transmitter (at least 2 m).	
3	Open trunk lid		
4	Put down Vario roof and move to load assist position and secure with supports (14)	i Aid of helper required. Secure supports (14) with adhesive tape (15). 	*230589066300
5	Unclip covers above bolts (1) from side trunk paneling with suitable screwdriver		
6	Remove bolts (1) on left and right tubular frame lock (2) up to stop.	i This releases tubular frame locks (2).	
7	Put up tubular frame (3) toward rear together with trunk lid	! Ensure that motion is uniform to prevent damaging tubular frame (3). i Aid of helper required. The trunk lid must be guided by two persons when opening the tubular frame (3). The trunk partition (4) must be closed.	
8	Open driver and front passenger doors		
9	Fold Vario roof toward front until the C-pillars (5) are positioned at approx. 90° position	! Ensure that the rear window does not collide with the rear shelf to prevent damaging the Vario roof mechanism. i Aid of helper required. It is necessary for both persons to pull upward and press both C-pillars toward front simultaneously until resistance is felt (5).	
10	Unclip cover (8) from headliner and completely open front catch by turning clockwise with Allen wrench (13)	i Hold Vario roof in the 90° position with the aid of a helper.	
11	Fold Vario roof toward front and install lock hook (9) in left and right lock mount (10).	! Ensure that the rear window does not collide with the rear shelf to prevent damaging the Vario roof mechanism. i Aid of helper required. It is necessary for both persons to pull upward and press both C-pillars toward front simultaneously until resistance is felt (5).	
12	Lock front catch	i For this purpose, turn lock bolt counterclockwise (13) with Allen wrench. The front lock should lock audibly.	
13	Clip cover (8) into roof paneling		
14	Remove both supports (14)		*230589066300
15	Fold up trunk lid and lock in trunk lid lock		
16	 Fold in side flaps with STAR DIAGNOSIS Connect STAR DIAGNOSIS and read out fault memory	i If the side flaps cannot be actuated, fold in with aid of emergency operation. Refer to: ↓ Perform emergency operation of side flaps	AD00.00-P-2000-04A AR77.30-P-6369R
17	Press tubular frame (3) toward front and move lock hooks (11) on hinge lever (12) in left and right tubular frame lock (2) into arresting position.	i Evenly push tubular frame (3) at both struts forwards.	
18	Turn bolts (1) on left and right tubular frame lock (2) until the tubular frame locks (2) are locked.		
19	Clip screw covers (1) into the side luggage compartment lining		
20	Close trunk lid		

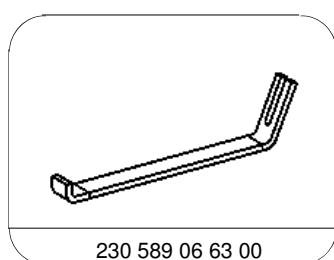

Support