

MODEL 230.4

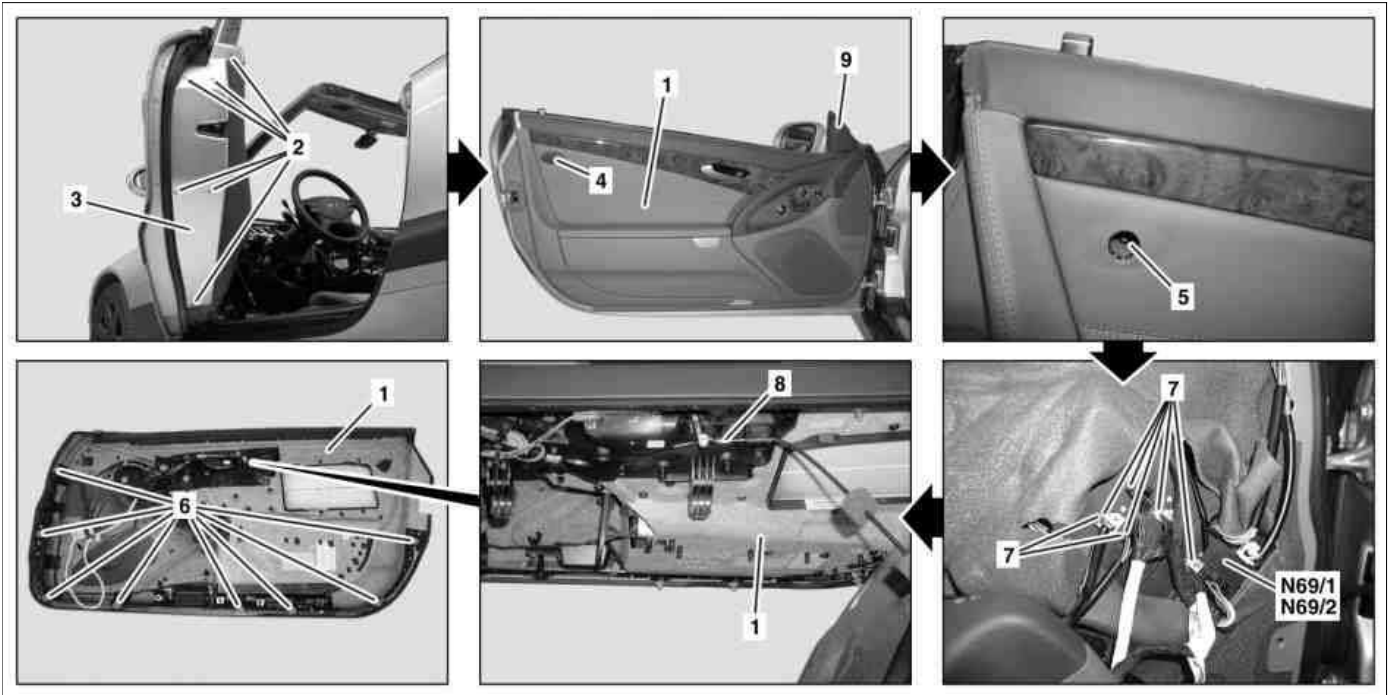

P72.10-2904-09

Shown on model 230.4 without code (P99) Special model "AMG Black Series"

- 1 Door lining
- 2 Bolts
- 3 Door lock cover

- 4 Door lining cover (not with code (P99) Special model "AMG Black Series" without code (494) USA version)
- 5 Bolt (not with code (P99) Special model "AMG Black Series" without code (494) USA version)

- 6 Mounting clips
- 7 Electrical connectors
- 8 Bowden cable
- 9 Mirror triangle cover
- N69/1 Door control module left
- N69/2 Door control module right

☒ ☒	Remove/install		
	Risk of fire and explosion caused by machining/treating magnesium components	Keep away from ignition sources and open flames.	AS60.00-Z-0006-01R
⚠	Information on machining/treating magnesium components		AH60.00-P-0023-01R
1	Switch off the ignition and remove the transmitter key from the EIS control unit	<p>i On vehicles with code (889) Keyless-Go, press KEYLESS-GO start/stop button repeatedly until ignition is switched off. Remove the Keyless Go chip card or transmitter key from the vehicle and store beyond the reach of the transmitter (at least 2 m).</p>	
2	Unclip mirror triangle cover (9) on left and right front door.	☒	*110589035900
3	Unscrew bolts (2) and remove door lock cover (3).		
4	Turn door lining cover (4) 90° and remove	On vehicles without code (P99) Special model "AMG Black Series"	
5	Unscrew bolt (5)	On vehicles without code (P99) Special model "AMG Black Series"	
6	Unclip door lining (1) from inner door panel with mounting wedge on mounting clips (6)	<p>⚠ Move mounting wedge directly to the respective mounting clips (6) and carefully press off door lining (1), otherwise retaining tabs of mounting clips (6) on door lining (1) can tear out.</p> <p>i Installation: Replace damaged mounting clips (6).</p>	*110589035900
7	Pull door lining (1) away in lower area of inner door panel and simultaneously lift out upward.	i Until electrical connectors (7) on left door control unit (N69/1) or right door control unit (N69/2) are accessible.	
8	Disconnect electrical connectors (7) from left door control unit (N69/1) or right door control unit (N69/2)		

9	Unhook Bowden cable (8) and remove door lining (1)	i Installation: Remove mounting clips (6) remaining on inner door panel and install at corresponding point of door lining (1).	
10	Install in the reverse order		

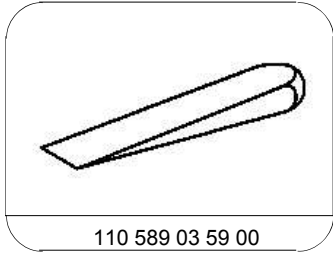

110 589 03 59 00

Mounting wedge