

MODEL 219

Shown on 4-piston fixed brake caliper

- 31a Fixed caliper
- 35 Bolts
- 51 Brake hose

- S10/1x1 Left front brake pad contact sensor connector
- S10/2x1 Right front brake pad contact sensor connector

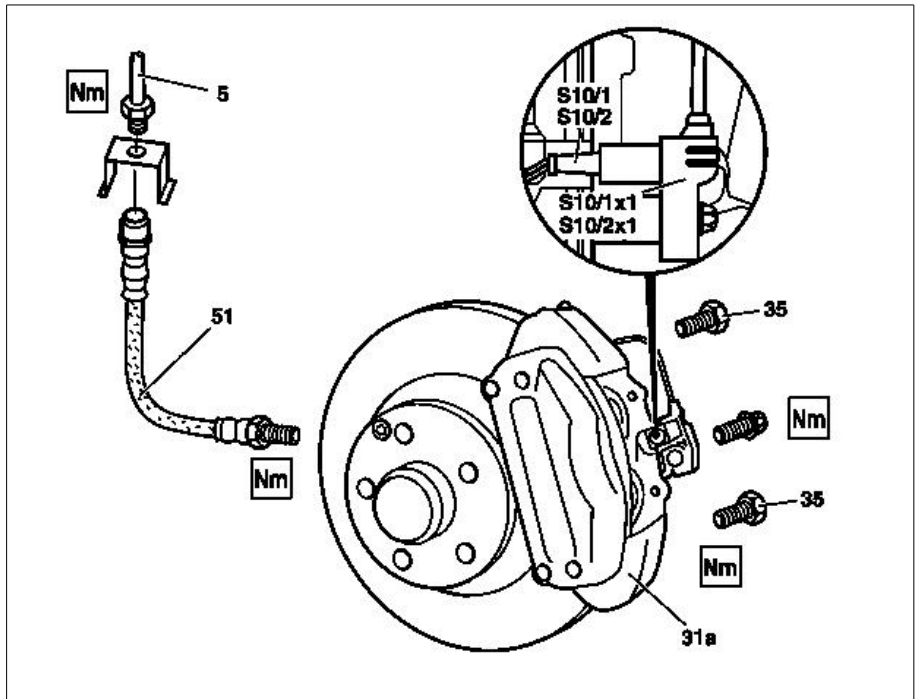

P42.10-2438-06

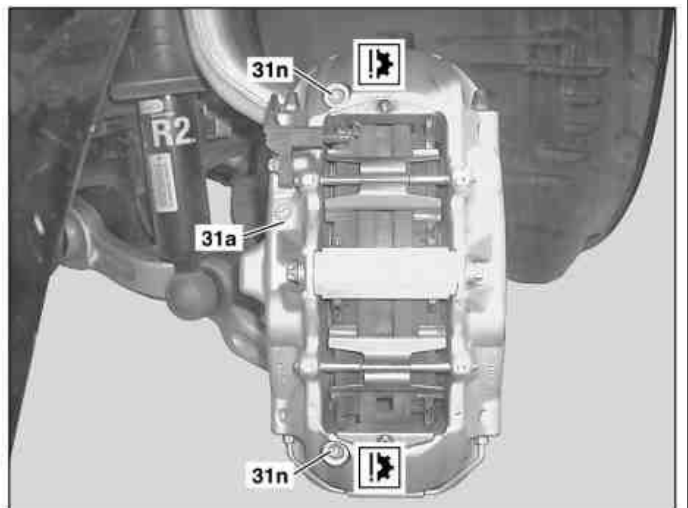
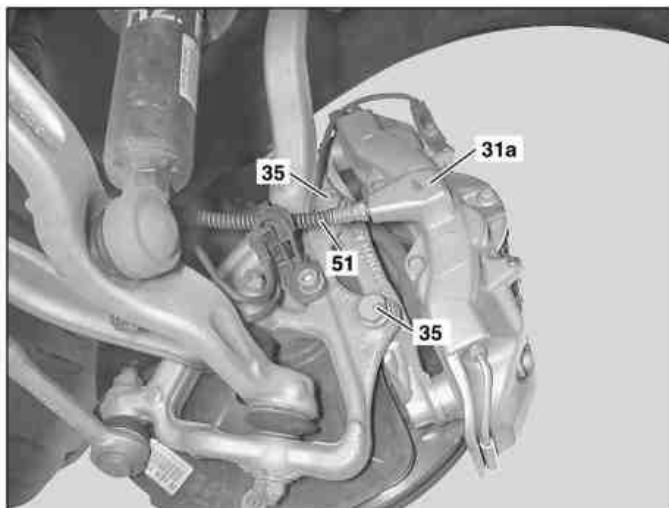

P42.10-2580-08

Shown on 8-piston fixed brake caliper

- 31a Brake caliper
- 31n Screw
- 35 Screw
- 51 Brake hose

ed	Remove/install		
a	Danger!	Risk of injury caused by body parts being jammed or crushed. Risk of injury to skin and eyes caused by brake fluid spraying out at high pressure when working on the SBC brake system	Deactivate SBC brake system using STAR DIAGNOSIS. AS42.46-Z-0001-01A
p		Notes on self-locking nuts and bolts	AH00.00-N-0001-01A
p		Notes on repairs to brake system	AH42.00-P-0003-01A
1		Deactivate SBC brake system using STAR DIAGNOSIS.	Vehicles with Sensotronic Brake Control (SBC) i The following steps should be run through in STAR DIAGNOSIS: Select menu item "SBC Sensotronic Brake Control"/"Deactivate 'SBC' system". Then process all the individual steps from top to bottom. STAR DIAGNOSIS diagnosis system

2	Remove wheel.		
e	Remove/install wheels, rotate if necessary		AP40.10-P-4050TX
3	Remove brake hose (51)		AR42.10-P-0013TX
4	Remove brake pads		AR42.10-P-1600TX
5	Detach brake pad contact sensor connector (S10/1x1, S10/2x1) from brake caliper (31a)	With 4-piston brake calipers n	*BA42.10-P-1003-10B
6	Remove bolts (35) and remove brake caliper (31a)	p Under no circumstances loosen the bolts (31n) on the 6 and 8-piston-brake calipers otherwise brake system malfunctions can occur n	*BA42.10-P-1001-10B
7	Install in the reverse order		
8.1	Bleed brake system with STAR DIAGNOSIS	Vehicles with Sensotronic Brake Control (SBC) i When performing the bleeding operation always observe the instructions in the document "Bleeding brake system using STAR DIAGNOSIS". i The following steps should be run through in STAR DIAGNOSIS: Select menu item "Initial startup after repair"/ "Exchanging brake calipers". Then process all the individual steps from top to bottom.	AR42.10-P-0012TX
8.2	Bleed brake system	Vehicles with Adaptive Brake (ABR)	AR42.10-P-0010T

n **Front axle brake caliper**

Number	Designation		Model 219.372/376/377	Model 219.322/354/356 / 357/375
BA42.10-P-1001-10B	Self-locking bolt, brake caliper to steering knuckle	Nm	180	115
BA42.10-P-1003-10B	Bolt, brake pad contact sensor to brake caliper	Nm	8	8