

AH01.30-P-1000-02MM	Notes on sealant path for front cover to cylinder head xxx		
---------------------	--	--	--

Engine 152.9, 157, 176, 177, 178, 276, 278

Shown on engine 157, 276, 278



P01.30-2548-11

Shown on engine 152.9



P01.30-2406-11

Shown on engine 176, 177, 178

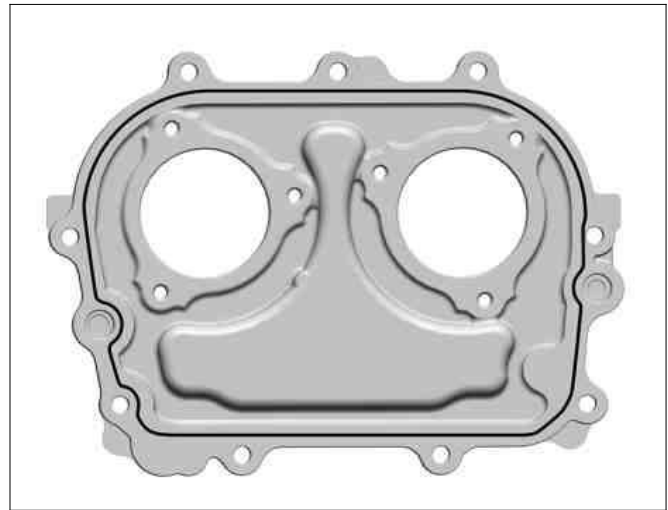

P01.30-2481-11

i Only apply sealant to specified area in the form of a bead with a height and width of 1.0 mm (± 0.3 mm). Process the sealant within a period of 10 minutes. Do not spread the sealant bead.

i The sealing surface must be cleaned. Use only the sealant listed in the repair products. Install front cover within a period of 10 minutes after applying the sealant.