

MODEL 212, 218

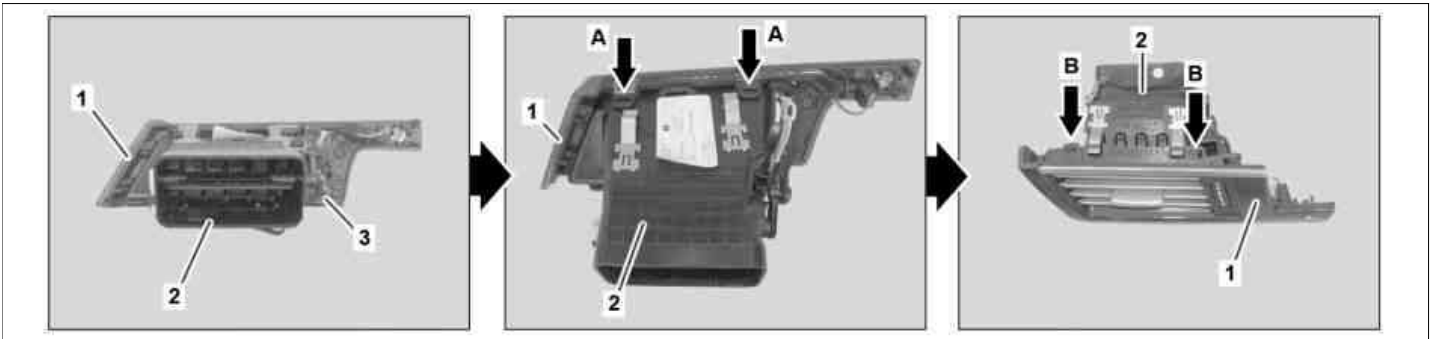

P83.10-2695-07

Shown on model 212 on side air vent (2) on driver side

1 Trim strip

2 Side air vent

3 Screw

☒ ☒	Remove/install		
1	Remove trim strip (1) on driver side	When removing side air vent (2) on driver side. Model 212 Model 218	AR68.10-P-1180EW AR68.10-P-1180EL
2	Remove trim strip (1) on passenger side	When removing side air vent (2) on passenger side. Model 212 Model 218	AR68.10-P-1180EW AR68.10-P-1180EL
3	Disconnect electrical connector at side air vent (2)	When removing side air vent (2) on passenger side.	
4	Unscrew bolt (3)	Model 212	
5	Unclip side air vent (2) (arrows A and B) and remove		
6	Install in the reverse order		