

- Parts list -

Vehicle	WDDHF7GB5FB156149 (D04)	Mercedes-AMG E 63 S 4MATIC Sedan
Color	799 - Diamond white - Metallic finish	Equipment 821 - Leather/nappa/semi-aniline - black/anthracite
FIN: WDD2120761B156149		Assortment class PC
Group	20 ENGINE COOLING	Sub-group 015 WATER PUMP

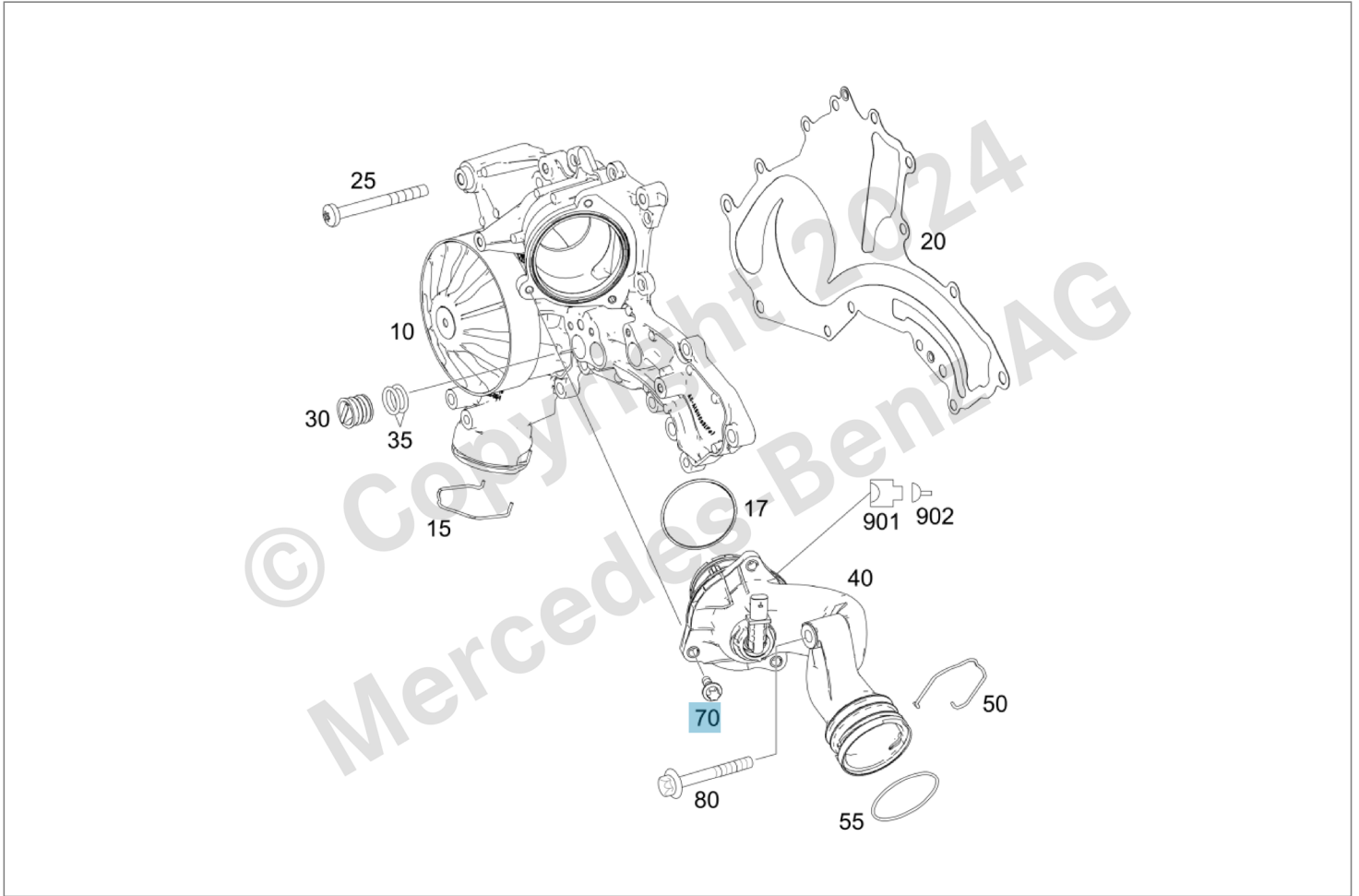









Image ID: drawing_PV000.001.654.036_version_002

Item	Part number	Designation/additional information	Qty
10	A 157 200 01 07 🏠 📦 ↺	COOLANT PUMP 📄 [697] PART IS ONLY OR ALSO SUPPLIED AS RECONDITIONED PART	1
15	A 000 993 12 02 🏠	* CATCH SPRING SCB36 46.4MM	1
17	A 278 201 02 80 🏠	* ELASTOMERIC MOLDED SEAL	1

Parts Information

Item	Part number	Designation/additional information	Qty
20	A 278 201 01 80 	METAL SEAL, SINGLE LAYER Water pump to timing case cover/cylinder crankcase Replaced by: A 278 201 03 80	1
20	A 278 201 03 80	METAL SEAL, SINGLE LAYER Water pump to timing case cover/cylinder crankcase Replaces: A 278 201 01 80	1
25	N 000000 001433	HEXALOBULAR BOLT Water pump to timing case cover/cylinder crankcase; M8X80	4
25	N 000000 006376	HEXALOBULAR BOLT Water pump to timing case cover; M7X25	11
30	A 278 201 01 03 	WATER PUMP COVER	2
35	A 023 997 44 45 	* O-RING 11.2X2	4
40	A 278 200 06 15  	COOLANT THERMO. W HOUSING	1
50	A 000 993 12 02 	* CATCH SPRING SCB36 46.4MM	1
55	A 022 997 64 45 	* O-RING	1
70	N 910143 006002	HEXALOBULAR BOLT Thermostat to coolant housing; M6X20	3
80	N 910143 006006	HEXALOBULAR BOLT Thermostat to oil filter; M6X40  [414] THE OLD PART MUST NO LONGER BE INSTALLED Replaced by: N 910143 006007	1
80	N 910143 006007	HEXALOBULAR BOLT Thermostat to oil filter; M6X45 Replaces: N 910143 006006	1
901	A 022 545 19 26	CLUTCH HOUSING Heating element R48/1; 2-PIN MLK1.2 Replaced by: A 029 545 10 26	1

Parts Information

Item	Part number	Designation/additional information	Qty
901	A 029 545 10 26	COUPLING HOUSING Heating element R48/1; 2-PIN MLK1.2 Replaces: A 022 545 19 26	1
902	A 000 982 30 26	CRIMP TML. SOCKET CONTACT 0.75-1.0 MM2 MLK1.2S	NB
902	A 003 982 73 26	CONTACT SOCKET 0.75-1.0 MM2 MLK1.2SM ELA	NB
902	A 003 982 70 26	CONTACT SOCKET 0.5 MM2 MLK 1,2SM	NB
902	A 001 545 50 80	SINGLE-WIRE SEAL Yellow; 0.22-1.0 MM2 MLK1.2	NB